

P.L. 94-171 COUNTY BLOCK MAP (CENSUS 2000)

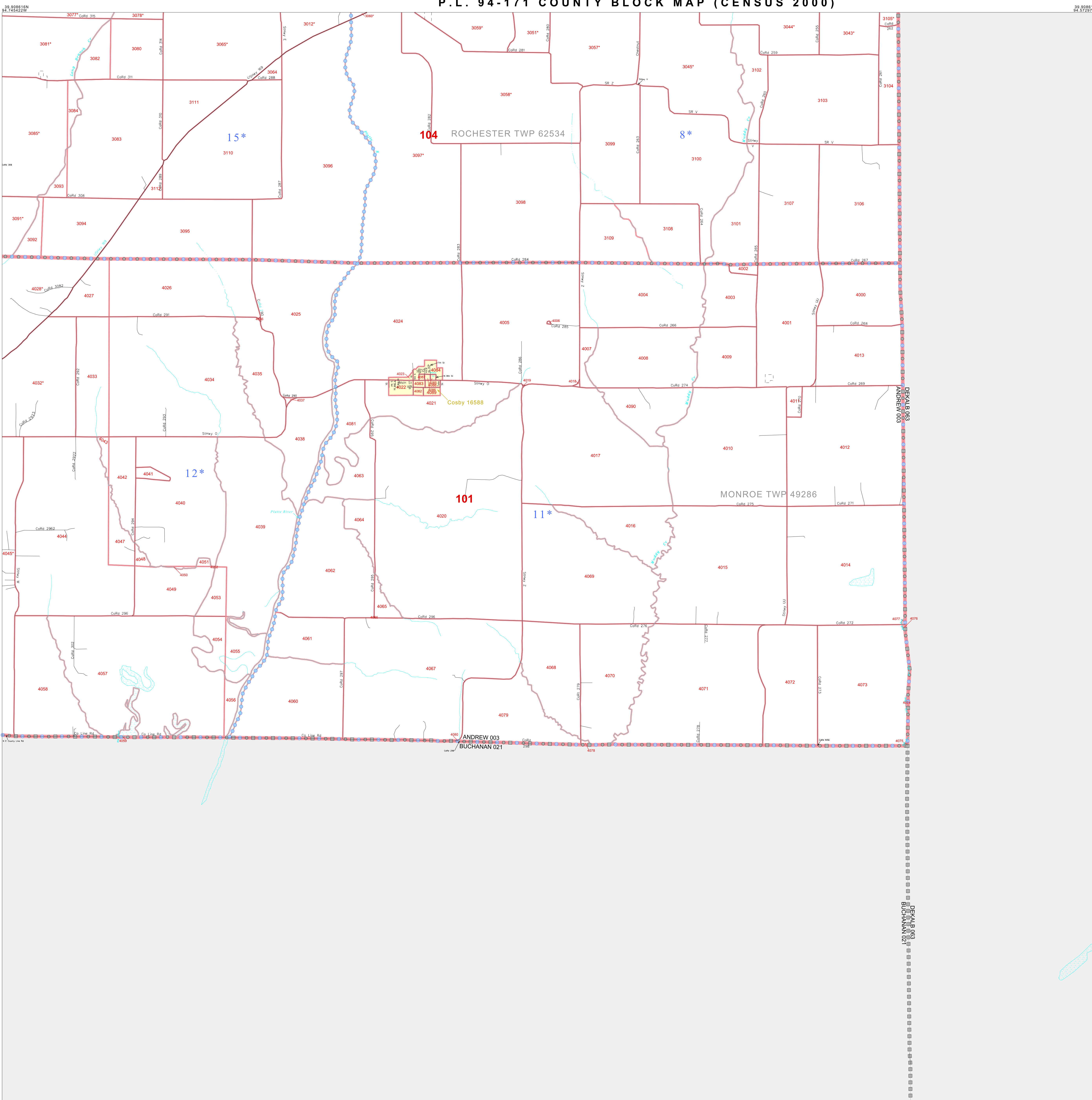

GEOGRAPHIC AREAS LEGEND

SYMBOL	NAME	STYLE
*****	INTERNATIONAL	
///////	STATE	
■■■■■	COUNTY	
■■■■■	MINOR CIVIL DIV.	
■■■■■	Incorporated Place ¹	
■■■■■	Census Designated Place ²	
.....	Corporate Offset Boundary	
.....	Voting District ³	
.....	Census Tract	
.....	BLOCK ³	

Military Inset Out Area

¹ A "*" following a place name indicates that the place is coterminous with a MCD. A "-" indicates that the place is also a false MCD. In both cases, the MCD name is shown only when it differs from the place name.
² A "*" following a VTD code indicates an actual voting district. Its absence indicates that the VTD is a pseudo voting district or no information is available as to its status.
³ A "*" following a block number indicates that the block number is repeated elsewhere in the block.

39 908616N 94 745422W 39 908616N 94 972971W

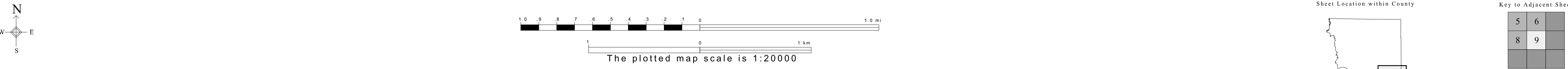

ST: Missouri (29)
COU: Andrew (003)
SHEET 9 OF 9 PARENT SHEETS

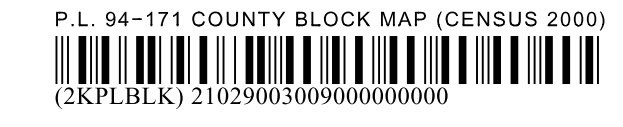

All legal boundaries and names are as of January 1, 2000. The boundaries shown on this map are for Census Bureau statistical data collection and tabulation purposes only; their depiction and designation for statistical purposes does not constitute a determination of jurisdictional authority or rights of ownership or entitlement. U.S. DEPARTMENT OF COMMERCE Economics and Statistics Administration U.S. Census Bureau