

P. L. 94-171 COUNTY BLOCK MAP (CENSUS 2000)

39 759265N
94 696389W

39 759265N
94 696389W

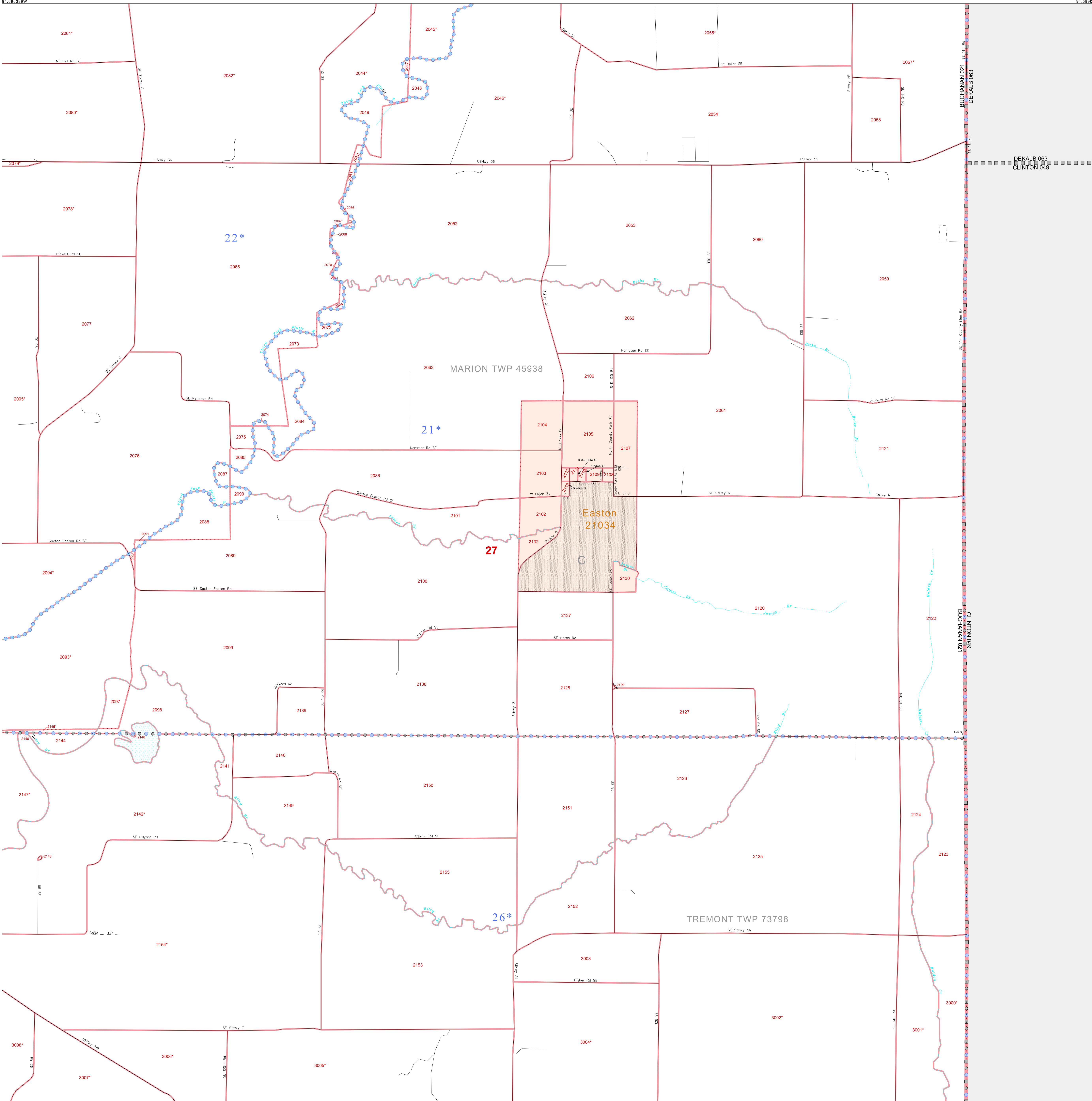

GEOGRAPHIC AREAS LEGEND

SYMBOL	NAME STYLE
*****	INTERNATIONAL
//////	STATE
□□□□	COUNTY
□□□□□□	MINOR CIVIL DIV. ¹
■ ■ ■ ■ ■ ■	Incorporated Place ¹
■ ■ ■ ■ ■ ■	Census Designated Place ¹
-----	Corporate Offset Boundary
●●●●●●	Voting District ²
=====	Census Tract
=====	BLOCK ³
-----	Military

Inset Out Area

1 A "*" following a place name indicates that the place is coterminous with a MCD. "A*" indicates that the place is also a false MCD. In both cases, the MCD name is shown only when it differs from the place name.
2 A "*" following a VTD code indicates an actual voting district. Its absence indicates that the VTD is a pseudo voting district or no information is available as to its status.
3 A "*" following a block number indicates that the block number is repeated elsewhere in the block.

39 676334N
94 696389W

39 676334N
94 696389W

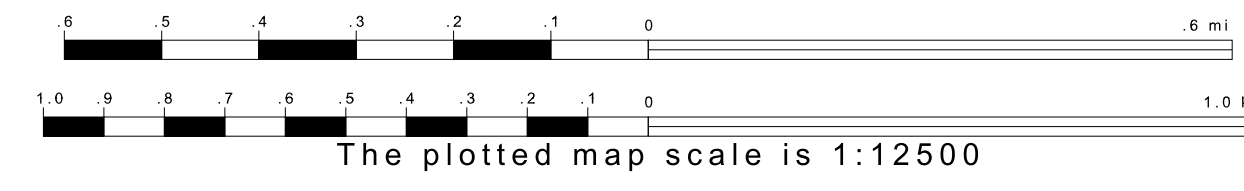

Sheet Location within County

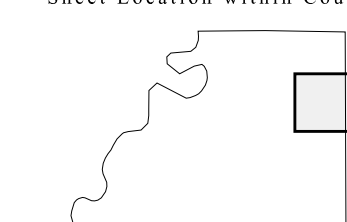

Key to Adjacent Sheets

3	4
7	8
12	13

ST: Missouri (29)
COU: Buchanan (021)
SHEET 8 OF 18 PARENT SHEETS



All legal boundaries and names are as of January 1, 2000. The boundaries shown on this map are for Census Bureau statistical data collection and tabulation purposes only; their depiction and designation for statistical purposes does not constitute a determination of jurisdictional authority or rights of ownership or entitlement. U.S. DEPARTMENT OF COMMERCE Economics and Statistics Administration U.S. Census Bureau