

P.L. 94-171 COUNTY BLOCK MAP (CENSUS 2000)

37 103132N  
93.628704W

37 103132N  
93.504652W

GEOGRAPHIC AREAS LEGEND

SYMBOL	NAME STYLE
*****	INTERNATIONAL
//////	STATE
■■■■■	COUNTY
●●●●●	MINOR CIVIL DIV. <sup>1</sup>
<span style="background-color: yellow; border: 1px solid black; padding: 2px;"> </span>	Incorporated Place <sup>2</sup>
<span style="background-color: pink; border: 1px solid black; padding: 2px;"> </span>	Census Designated Place <sup>2</sup>
-----	Corporate Offset Boundary
●●●●●	Voting District <sup>3</sup>
■■■■■	Census Tract
■■■■■	BLOCK <sup>3</sup>

1 A "\*" following a place name indicates that the place is coterminous with a MCD. "A" indicates that the place is also a false MCD. In both cases, the MCD name is shown only when it differs from the place name.  
 2 A "\*" following a VTD code indicates an actual voting district. Its absence indicates that the VTD is a pseudo voting district or no information is available as to its status.  
 3 A "\*" following a block number indicates that the block number is repeated elsewhere in the block.

Military Inset Out Area

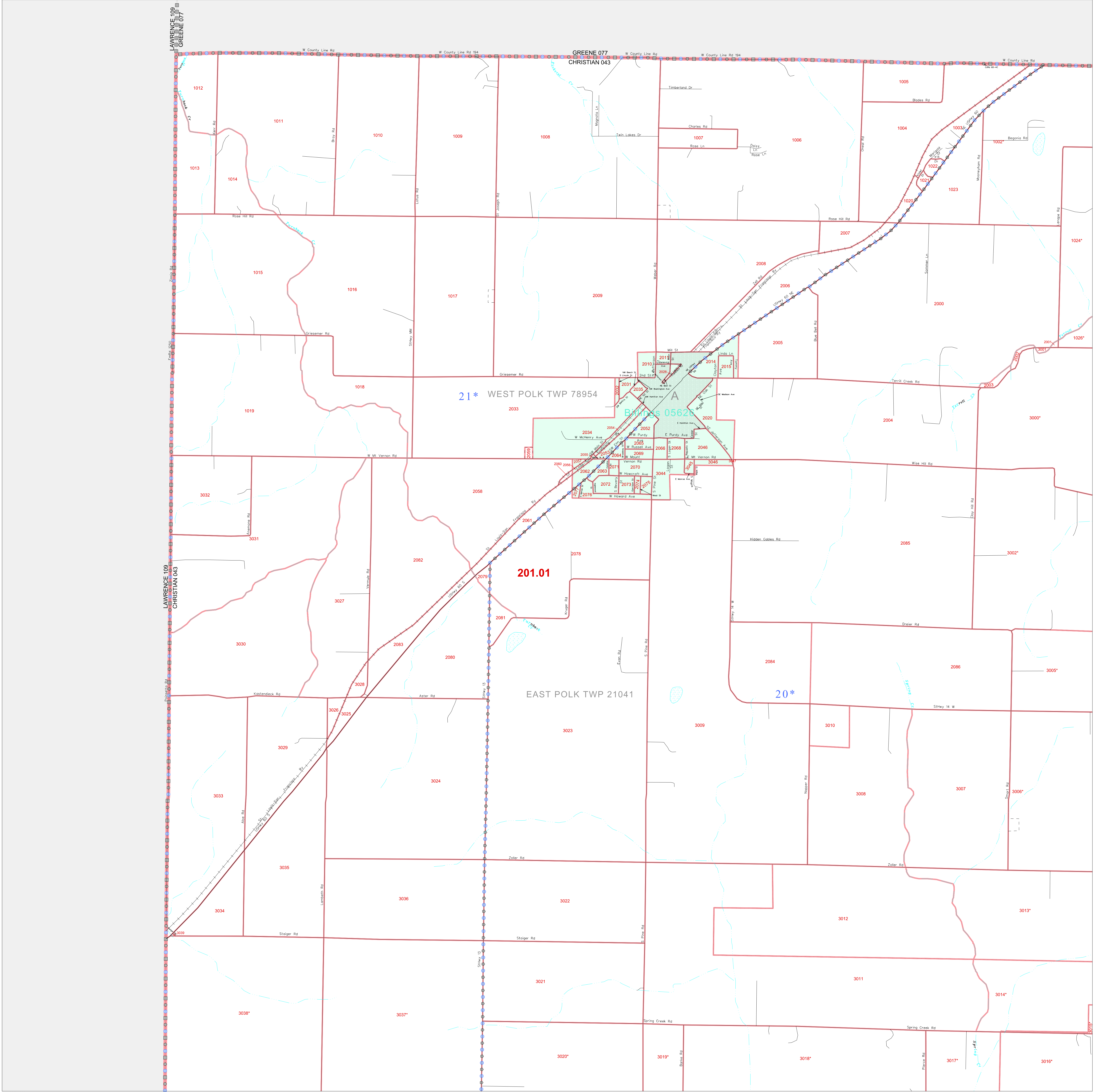

37 003568N  
93.628704W

37 003568N  
93.504652W

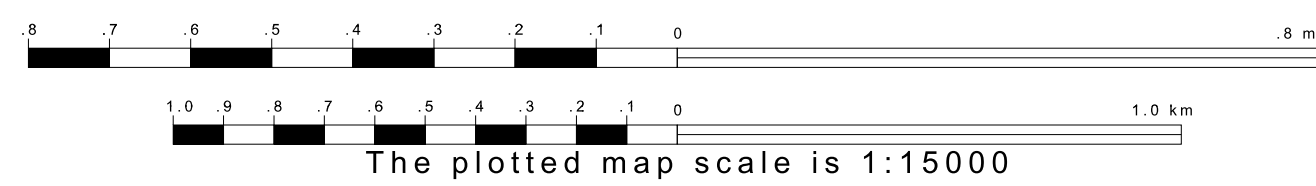
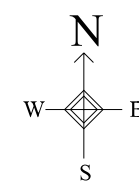

Sheet Location within County

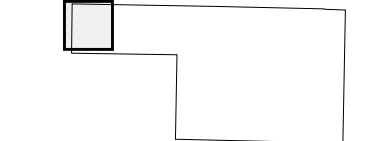

Key to Adjacent Sheets

	1	2
7		8

ST: Missouri (29)  
 COU: Christian (043)  
 SHEET 1 OF 16 PARENT SHEETS

