

### GEOGRAPHIC AREAS LEGEND

SYMBOL	NAME STYLE
*****	INTERNATIONAL
//////	STATE
□□□□□□	COUNTY
○●○●○●	MINOR CIVIL DIV. <sup>1</sup>
Yellow box	Incorporated Place <sup>1</sup>
Pink box	Census Designated Place <sup>2</sup>
Blue dashed line	Voting District
Brown dashed line	SLD-Senate
Blue dashed line with triangles	SLD-House
Blue dashed line with dots	Minority
Inset box	Inset
Out Area box	Out Area

Abbreviation Reference: AIR - American Indian Reservation; SDAISA - State Designated American Indian Statistical Area

<sup>1</sup> A "\*" following a place name indicates that the place is coterminous with a MCD. A "-" indicates that the place is also a false MCD. In both cases, the MCD name is shown only when it differs from the place name.

<sup>2</sup> A "\*" following a VTD code indicates an actual voting district. Its absence indicates that the VTD is a pseudo voting district or no information is available as to its status.

### Voting Districts

Code	Name
30*	FishingRiver1 Voting District
31*	FishingRiver2 Voting District
34*	FishingRiver3 Voting District
52*	Kearay1 Voting District
54*	Kearay2 Voting District
69*	Washington1 Voting District
70*	Washington2 Voting District

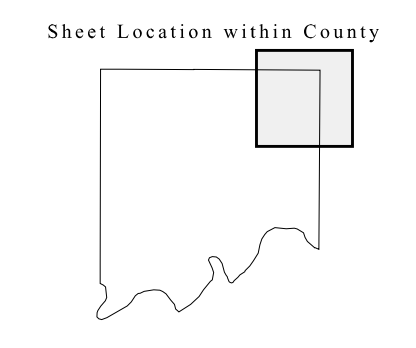
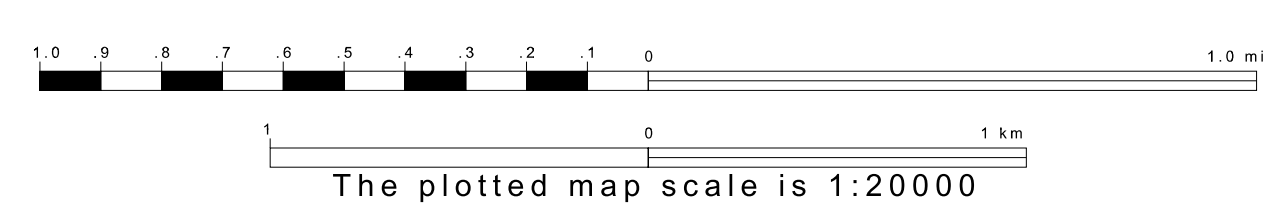
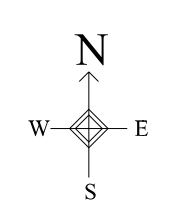
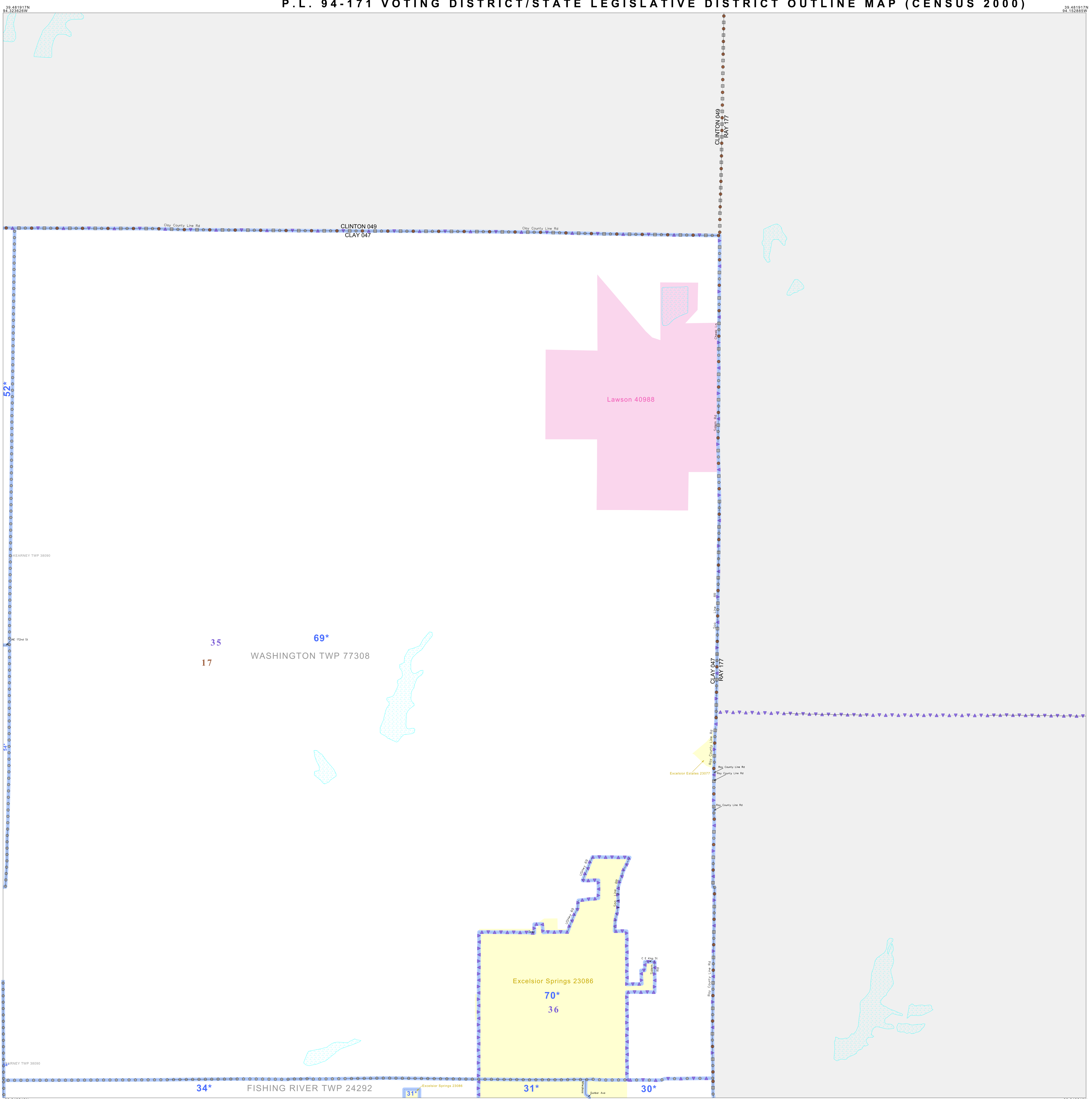

### Key to Adjacent Sheets

2	3
5	6

ST: Missouri (29)  
COU: Clay (047)  
SHEET 3 OF 9 PARENT SHEETS

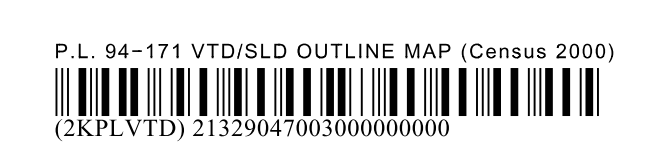

All legal boundaries and names are as of January 1, 2000. The boundaries shown on this map are for Census Bureau statistical data collection and tabulation purposes only; their depiction and designation for statistical purposes does not constitute a determination of jurisdictional authority or rights of ownership or entitlement. U.S. DEPARTMENT OF COMMERCE Economics and Statistics Administration U.S. Census Bureau