

P.L. 94-171 VOTING DISTRICT/STATE LEGISLATIVE DISTRICT OUTLINE MAP (CENSUS 2000)

37 859601N
93 283332W

37 859601N
92 754410W

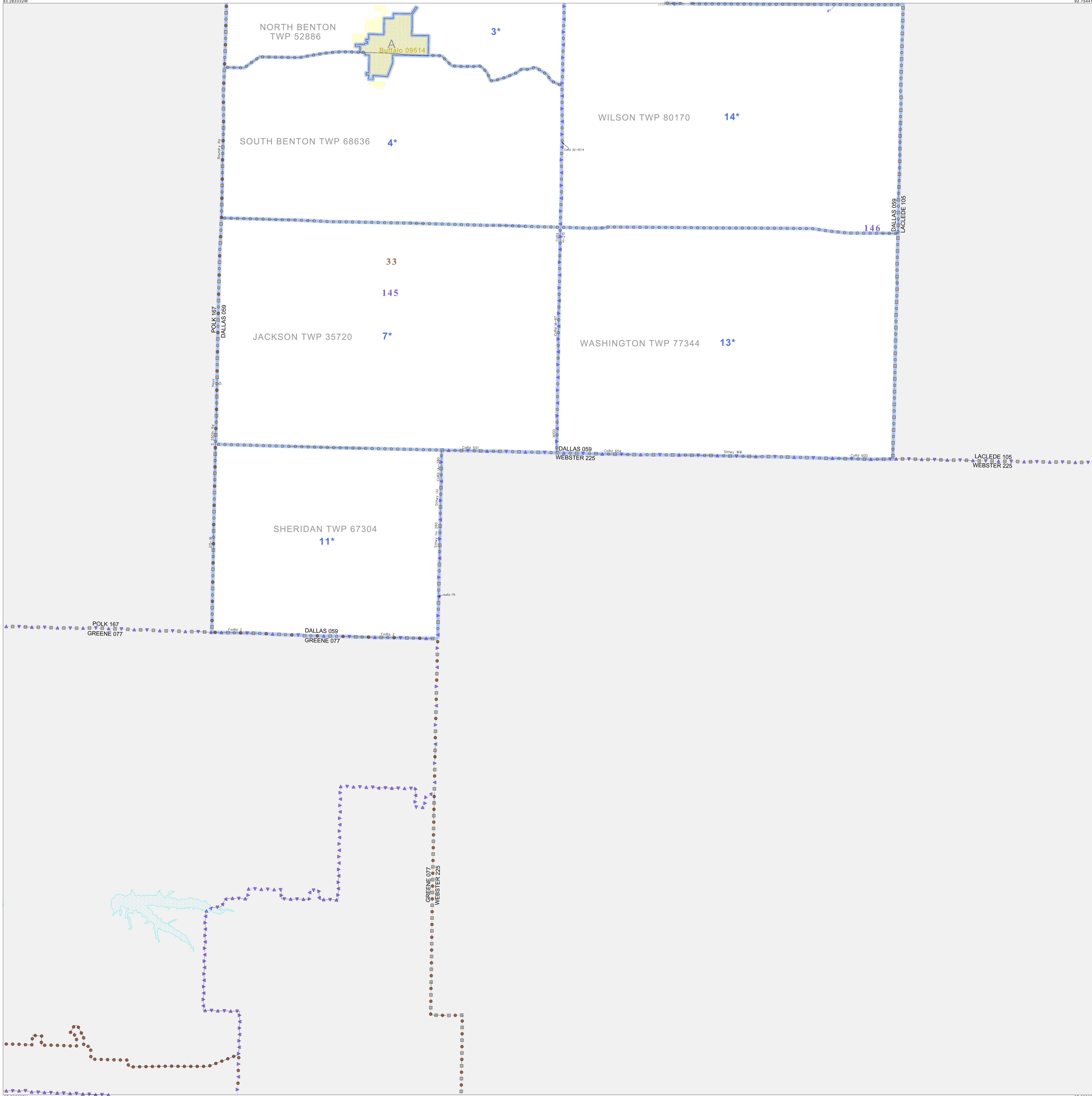

GEOGRAPHIC AREAS LEGEND

SYMBOL	NAME STYLE
*****	INTERNATIONAL
//////	STATE
□□□□□□	COUNTY
○●○●○●	MINOR CIVIL DIV ¹
Yellow shaded area	Incorporated Place ¹
Yellow shaded area	Census Designated Place ¹
Blue dashed line	Voting District ²
Brown dashed line	SLD-Senate
Blue dashed line with triangles	SLD-House

Abbreviation Reference: AIR - American Indian Reservation; SDAISA - State Designated American Indian Statistical Area

¹ A "*" following a place name indicates that the place is coterminous with a MCD. A "-" indicates that the place is also a false MCD. In both cases, the MCD name is shown only when it differs from the place name.
² A "*" following a VTD code indicates an actual voting district. Its absence indicates that the VTD is a pseudo voting district or no information is available as to its status.

Voting Districts

Code	Name
3*	BentonNorth-OGL Voting District
4*	BentonSouth-OGL Voting District
7*	Jackson Voting District
8*	Jasper Voting District
11*	Sheridan Voting District
13*	Washington Voting District
14*	Wilson Voting District

37 238095N
93 283332W

37 238095N
92 754410W

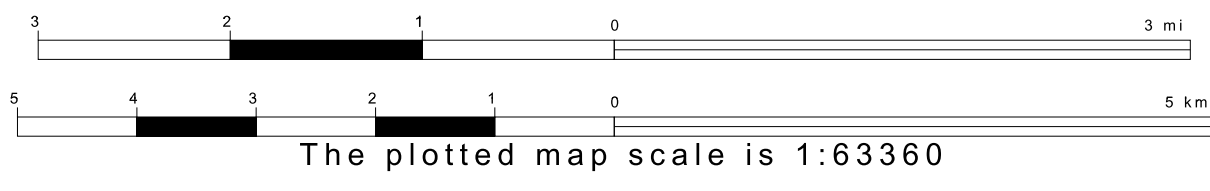
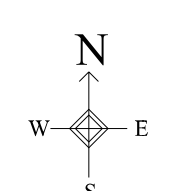

Sheet Location within County

Key to Adjacent Sheets

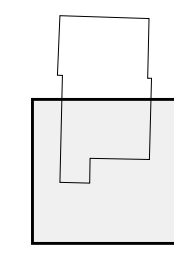

1	2
---	---

ST: Missouri (29)
 COU: Dallas (059)
 SHEET 2 OF 2 PARENT SHEETS

