

37 457188N  
93.675804W

37 457188N  
93.509758W

### GEOGRAPHIC AREAS LEGEND

SYMBOL	NAME STYLE
*****	INTERNATIONAL
//////	STATE
□□□□	COUNTY
○ ○ ○ ○	MINOR CIVIL DIV. <sup>1</sup>
■ ■ ■ ■	Incorporated Place <sup>1</sup>
■ ■ ■ ■	Census Designated Place <sup>2</sup>
■ ■ ■ ■	Voting District
● ● ● ●	SLD-Senate
▲ ▲ ▲ ▲	SLD-House

Military  Inset  Out Area

Abbreviation Reference: AIR - American Indian Reservation; SDAISA - State Designated American Indian Statistical Area

<sup>1</sup> A " " following a place name indicates that the place is coterminous with a MCD. A " " indicates that the place is also a CSD. In both cases, the MCD name is shown only when it differs from the place name.  
<sup>2</sup> A " " following a VTD code indicates an actual voting district. Its absence indicates that the VTD is a pseudo voting district or no information is available as to its status.

### Voting Districts

Code	Name
1*	Boone1 Voting District
2*	Boone2 Voting District
14*	Cass-Boone1 Voting District
26*	MurrayBoone1 Voting District
109*	WalnutGrove Voting District

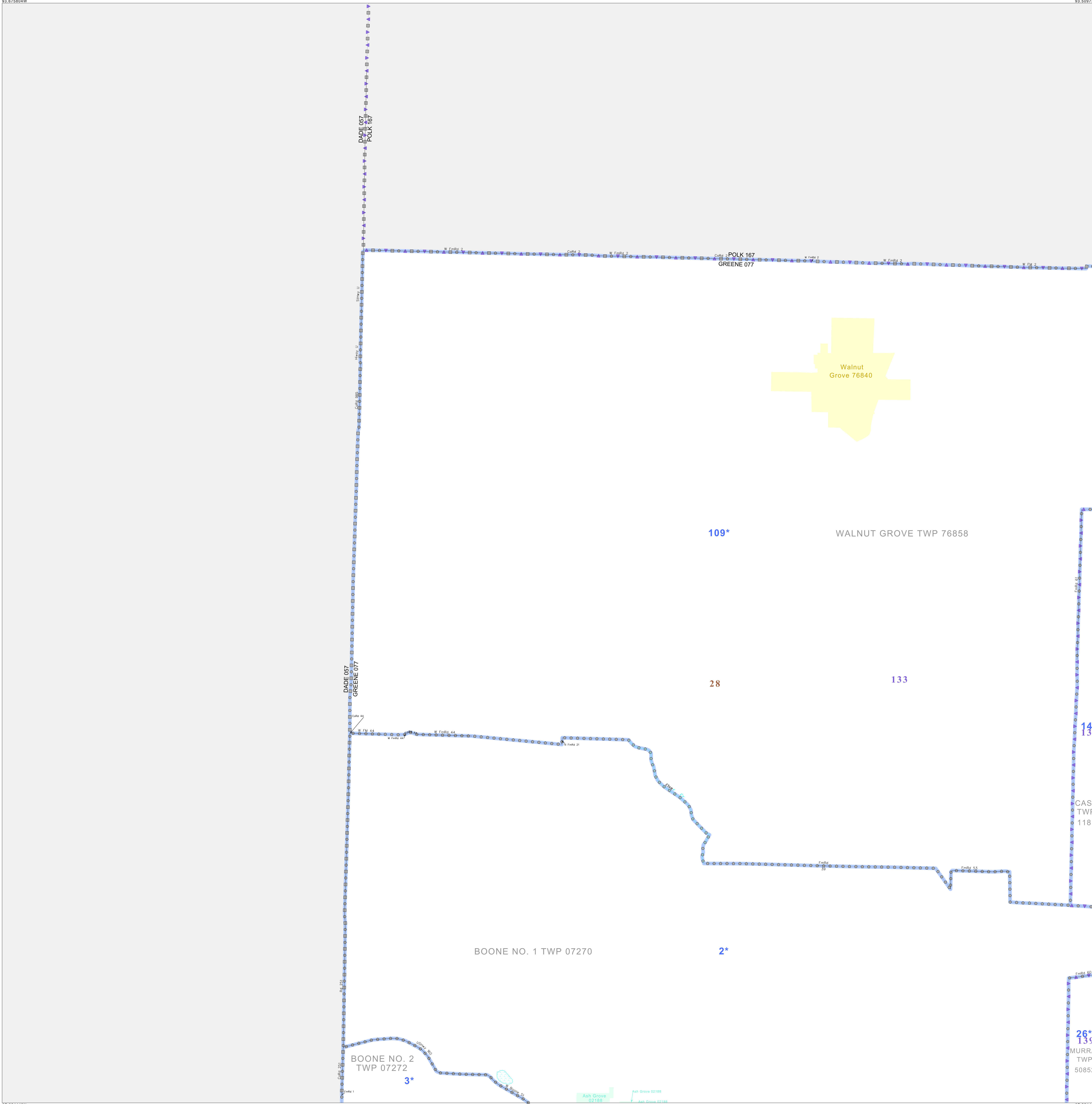

37 324443N  
93.675804W

37 324443N  
93.509758W

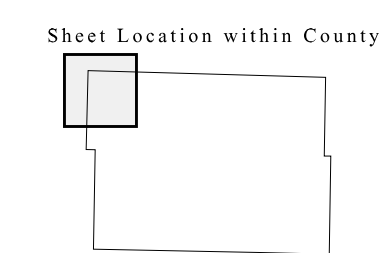
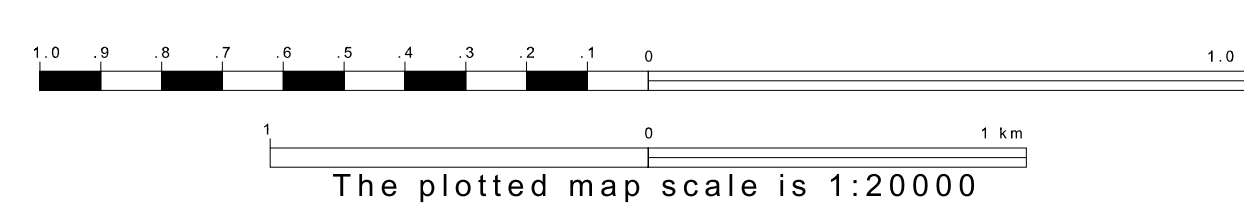

### Key to Adjacent Sheets

	1	2
5		6

ST: Missouri (29)  
 COU: Greene (077)  
 SHEET 1 OF 12 PARENT SHEETS

