

P.L. 94-171 VOTING DISTRICT/STATE LEGISLATIVE DISTRICT OUTLINE MAP (CENSUS 2000)

GEOGRAPHIC AREAS LEGEND

SYMBOL	NAME STYLE
*****	INTERNATIONAL
//////	STATE
□□□□□□	COUNTY
○ ○ ○ ○ ○ ○	MINOR CIVIL DIV <sup>1</sup>
■ ■ ■ ■ ■ ■	Incorporated Place <sup>1</sup>
■ ■ ■ ■ ■ ■	Census Designated Place <sup>2</sup>
— — — — —	Voting District
● ● ● ● ● ●	SLD-Senate
▲ ▲ ▲ ▲ ▲ ▲	SLD-House
□ □ □ □ □ □	Minority
□ □ □ □ □ □	Inset
□ □ □ □ □ □	Out Area

Abbreviation Reference: AIR - American Indian Reservation; SDAISA - State Designated American Indian Statistical Area

<sup>1</sup> A "\*" following a place name indicates that the place is coterminous with a MCD. A "-" indicates that the place is also a false MCD. In both cases, the MCD name is shown only when it differs from the place name.  
<sup>2</sup> A "\*" following a VTD code indicates an actual voting district. Its absence indicates that the VTD is a pseudo voting district or no information is available as to its status.

Voting Districts

Code	Name
22*	Franklin Voting District
23*	Franklin-1 Voting District
24*	Jackson Voting District
31*	Robberson18 Voting District
32*	Robberson19 Voting District
33*	Robberson2 Voting District

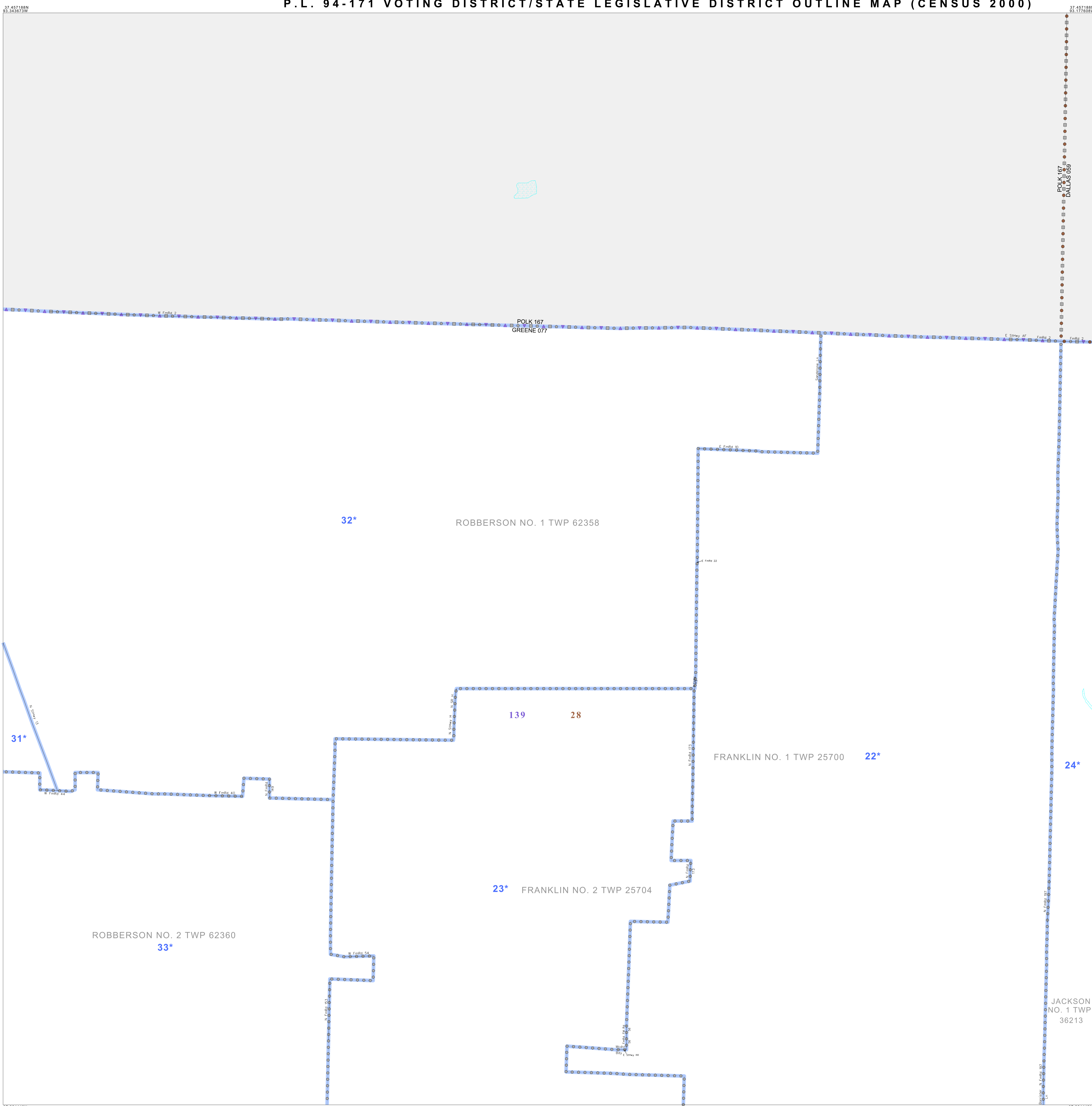

37 324443N  
93 343673W

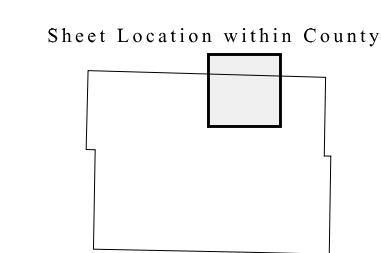
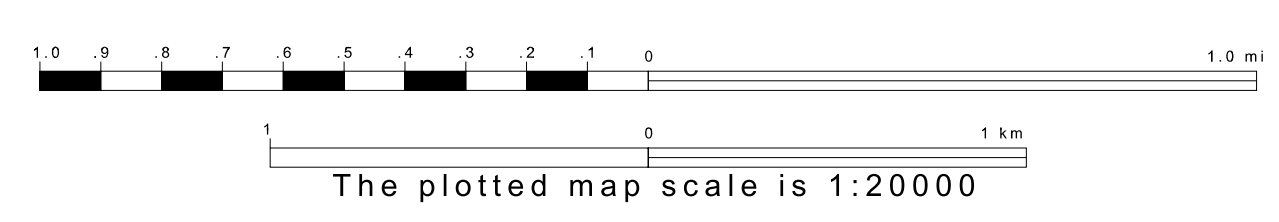
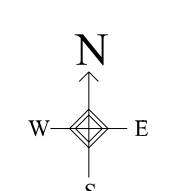

Key to Adjacent Sheets

2	3	4
6	7	8

ST: Missouri (29)  
 COU: Greene (077)  
 SHEET 3 OF 12 PARENT SHEETS

