

P.L. 94-171 VOTING DISTRICT/STATE LEGISLATIVE DISTRICT OUTLINE MAP (CENSUS 2000)

38 463845N  
93 894386W

38 463845N  
93 892057W

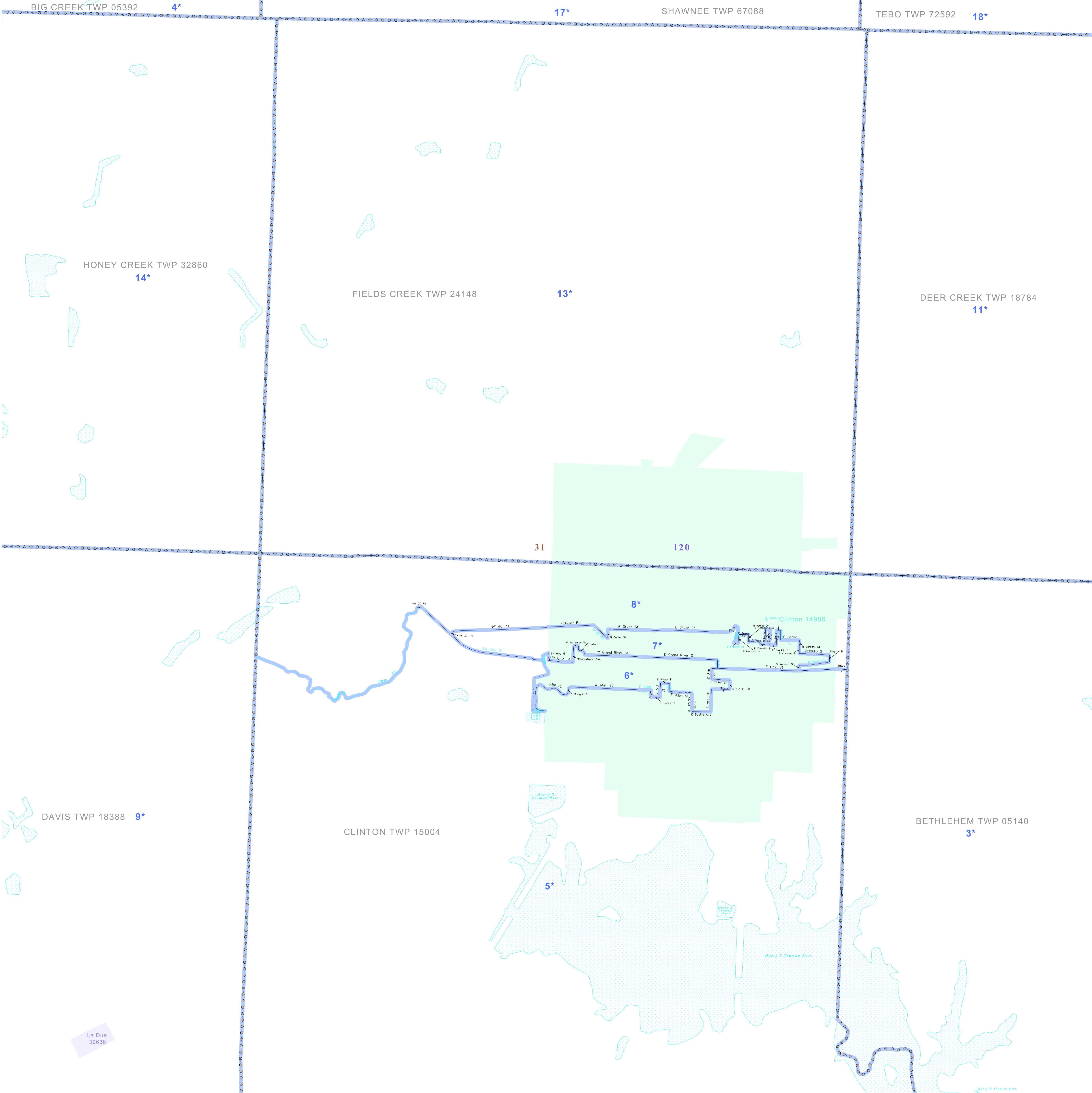

**GEOGRAPHIC AREAS LEGEND**

SYMBOL	NAME STYLE
*****	INTERNATIONAL
//////	STATE
□□□□□□	COUNTY
○●○●○●	MINOR CIVIL DIV. <sup>1</sup>
■	Incorporated Place <sup>1</sup>
■	Census Designated Place <sup>2</sup>
■	Voting District
●●●●●●	SLD-Senate
▲▲▲▲▲▲	SLD-House
□	Minority
□	Inset
□	Out Area

Abbreviation Reference: AIR - American Indian Reservation; SDAISA - State Designated American Indian Statistical Area

<sup>1</sup> A "\*" following a place name indicates that the place is coterminous with a MCD. A "-" indicates that the place is also a false MCD. In both cases, the MCD name is shown only when it differs from the place name.

<sup>2</sup> A "\*" following a VTD code indicates an actual voting district. Its absence indicates that the VTD is a pseudo voting district or no information is available as to its status.

**Voting Districts**

Code	Name
3*	Bethlehem Voting District
4*	BigCreek&Bigard Voting District
5*	ClintonWard1
6*	ClintonWard2
7*	ClintonWard3
8*	ClintonWard4
9*	Davis Voting District
11*	DeerCreek Voting District
12*	FieldsCreek Voting District
13*	HoneyCreek Voting District
14*	Shawnee Voting District
17*	Springfield&Iber Voting District
18*	

38 304582N  
93 894386W

38 304582N  
93 892057W

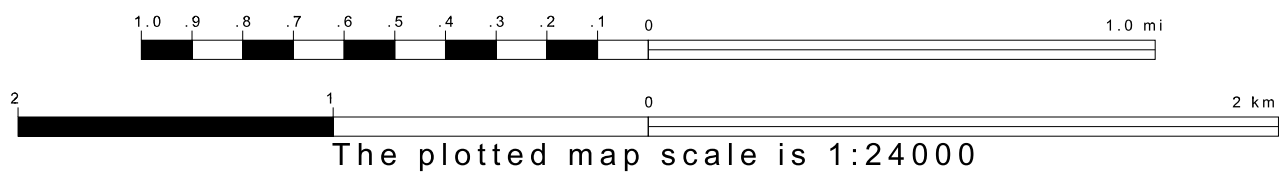
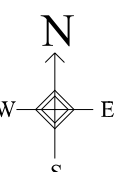

Sheet Location within County

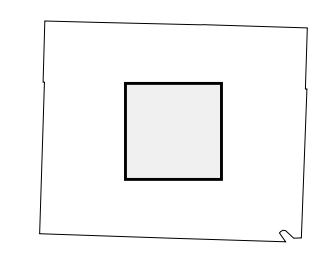

Key to Adjacent Sheets

1	2	3
4	5	6
7	8	9

ST: Missouri (29)  
COU: Henry (083)  
SHEET 5 OF 9 PARENT SHEETS

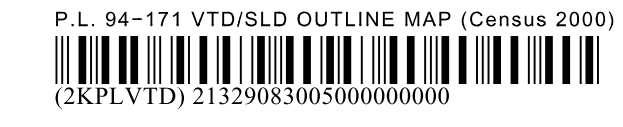

All legal boundaries and names are as of January 1, 2000. The boundaries shown on this map are for Census Bureau statistical data collection and tabulation purposes only; their depiction and designation for statistical purposes does not constitute a determination of jurisdictional authority or rights of ownership or entitlement. U.S. DEPARTMENT OF COMMERCE Economics and Statistics Administration U.S. Census Bureau