

P. L. 94-171 COUNTY BLOCK MAP (CENSUS 2000)

GEOGRAPHIC AREAS LEGEND

SYMBOL	NAME STYLE
*****	INTERNATIONAL
///////	STATE
■■■■■	COUNTY
●●●●●	MINOR CIVIL DIV ¹
	Incorporated Place ²
	Census Designated Place ²
.....	Corporate Offset Boundary
●●●●●	Voting District ³
	Census Tract
	BLOCK ³
	Military
	Inset
	Out Area

1 A "*" following a place name indicates that the place is coterminous with a MCD. A "-" indicates that the place is also a false MCD. In both cases, the MCD name is shown only when it differs from the place name.
 2 A "*" following a VTD code indicates an actual voting district. Its absence indicates that the VTD is a pseudo voting district or no information is available as to its status.
 3 A "*" following a block number indicates that the block number is repeated elsewhere in the block.

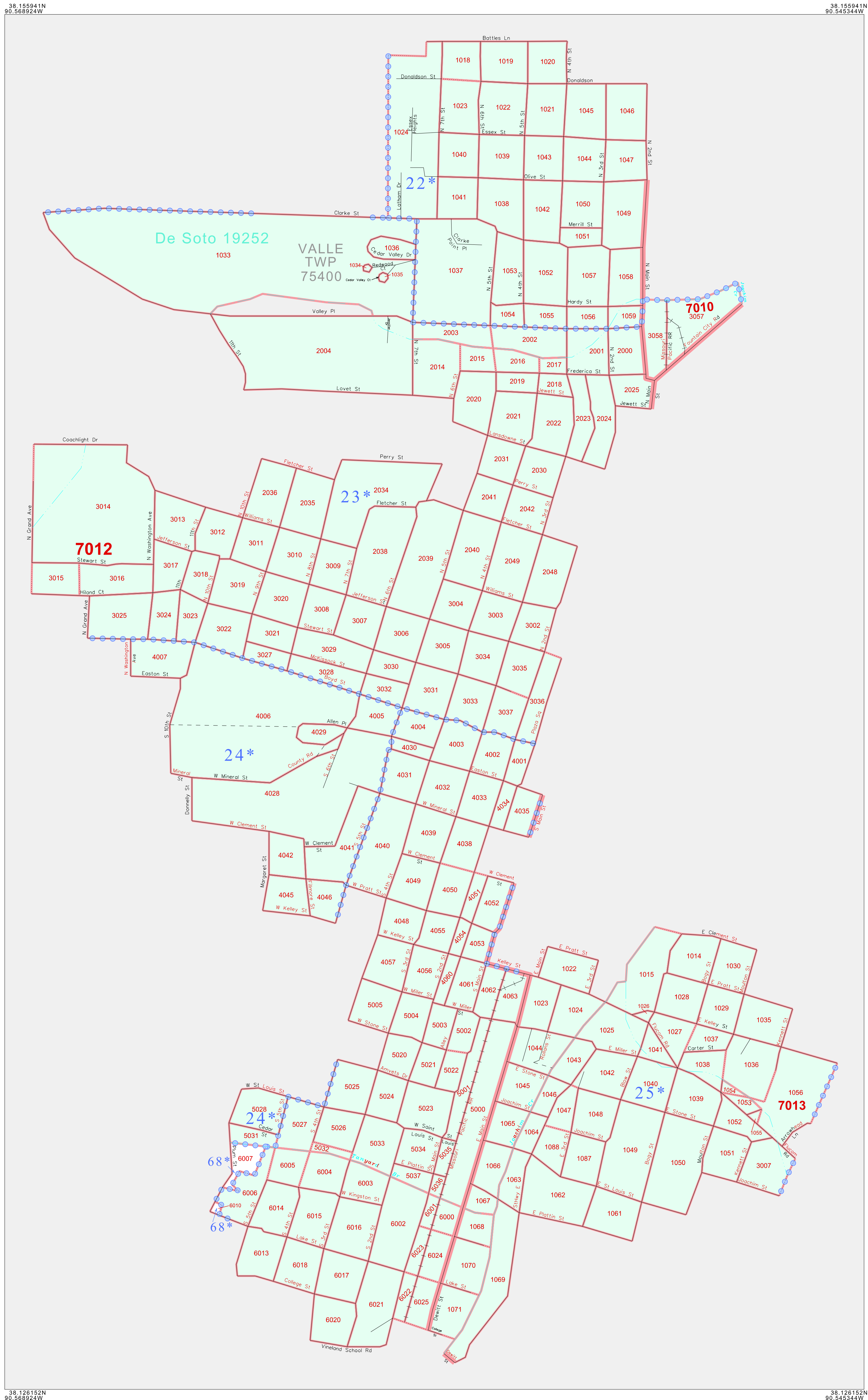

38 105841N 90.545244W 38 105841N 90.545244W

38 126152N 90.545244W 38 126152N 90.545244W

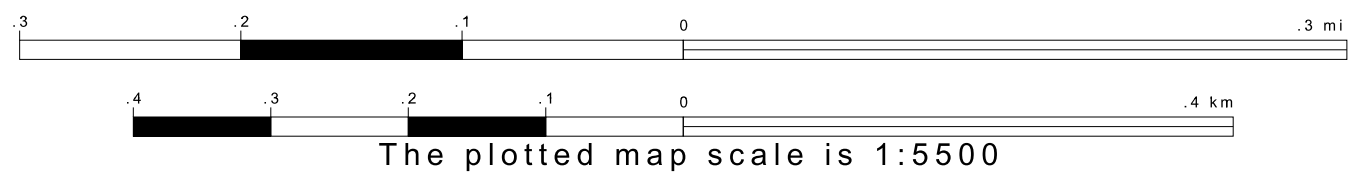
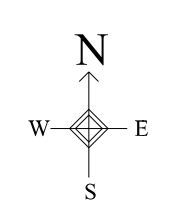

Sheet Location within County

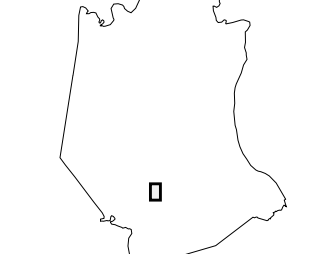

Key to Adjacent Sheets

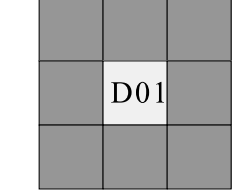

ST: Missouri (29)
 COU: Jefferson (099)
 INSET SHEET D01

