

P.L. 94-171 VOTING DISTRICT/STATE LEGISLATIVE DISTRICT OUTLINE MAP (CENSUS 2000)

### GEOGRAPHIC AREAS LEGEND

SYMBOL	NAME STYLE
*****	INTERNATIONAL
//////	STATE
□□□□	COUNTY
○ ○ ○ ○	MINOR CIVIL DIV. <sup>1</sup>
■ ■ ■ ■	Incorporated Place <sup>1</sup>
■ ■ ■ ■	Census Designated Place <sup>2</sup>
—	Voting District
● ● ● ●	SLD-Senate
▲ ▲ ▲ ▲	SLD-House
□ □ □ □	Minority
□ □ □ □	Inset
□ □ □ □	Out Area

Abbreviation Reference: AIR - American Indian Reservation; SDAISA - State Designated American Indian Statistical Area

<sup>1</sup> A "\*" following a place name indicates that the place is coterminous with a MCD. A "-" indicates that the place is also a false MCD. In both cases, the MCD name is shown only when it differs from the place name.

<sup>2</sup> A "\*" following a VTD code indicates an actual voting district. Its absence indicates that the VTD is a pseudo voting district or no information is available as to its status.

### Voting Districts

Code	Name
1*	AuroraNorth Voting District
2*	AuroraSouth Voting District
3*	BuckPrairie Voting District
4*	Freistatt Voting District
5*	Green Voting District
6*	Hoberg Voting District
7*	Lincoln Voting District
8*	Mount Pleasant Voting District
9*	Mount Vernon Voting District
10*	Newton Voting District
11*	Verona Voting District
12*	Marionville Voting District
13*	Stotts City Voting District
14*	Miller Voting District
15*	Halltown Voting District
16*	Pierce City Voting District
17*	Monett Voting District
18*	Spring River Voting District
19*	Turnback Voting District
20*	Vineyard Voting District

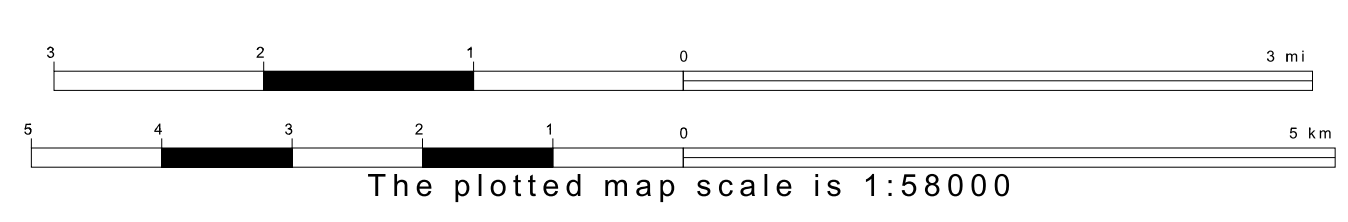
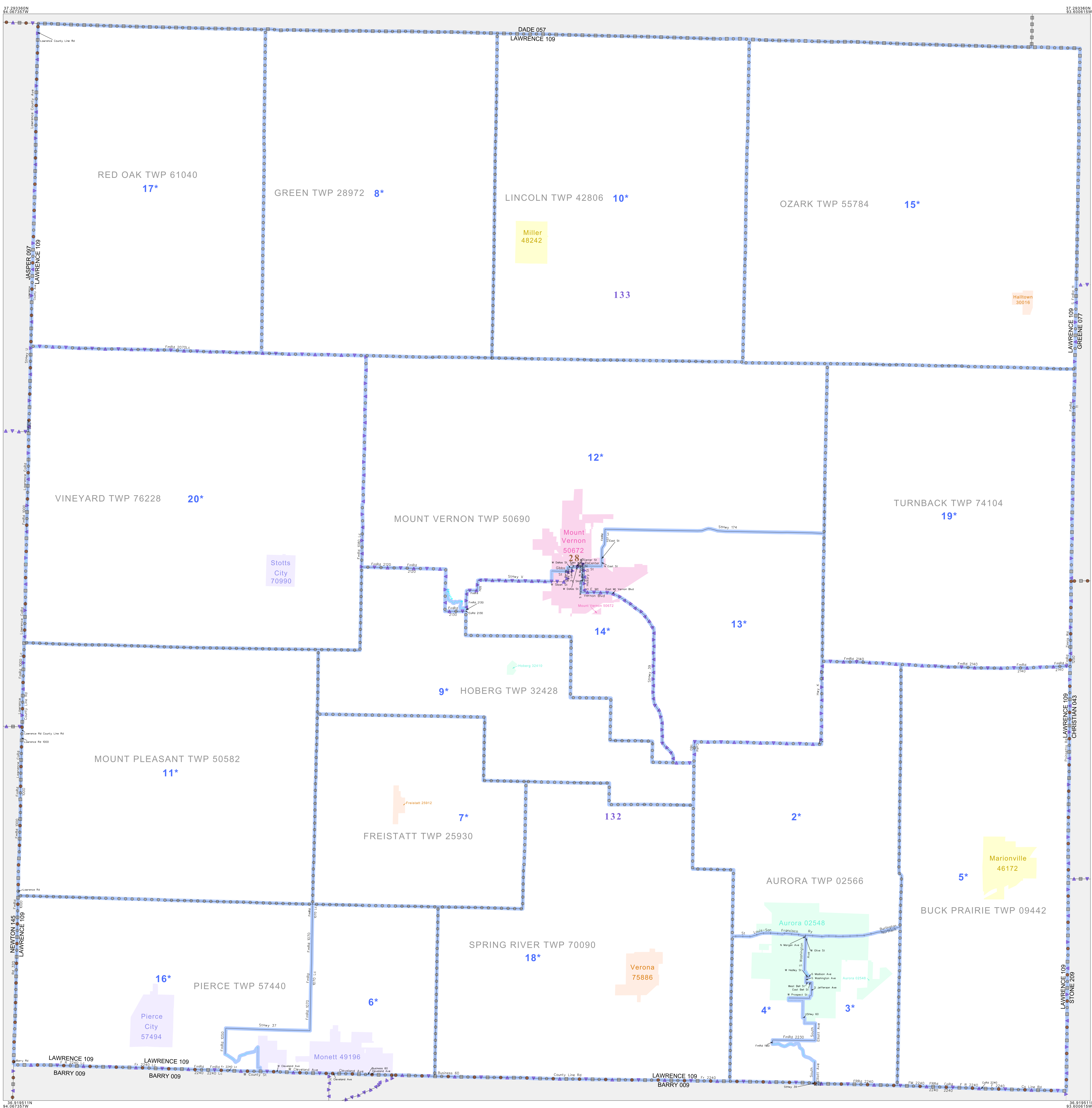

ST: Missouri (29)  
 COU: Lawrence (109)  
 SHEET 1 OF 1 PARENT SHEET

All legal boundaries and names are as of January 1, 2000. The boundaries shown on this map are for Census Bureau statistical data collection and tabulation purposes only; their depiction and designation for statistical purposes does not constitute a determination of jurisdictional authority or rights of ownership or entitlement. U.S. DEPARTMENT OF COMMERCE Economics and Statistics Administration U.S. Census Bureau

