

### GEOGRAPHIC AREAS LEGEND

SYMBOL	NAME STYLE
*****	INTERNATIONAL
//////	STATE
□□□□□□	COUNTY
○	MINOR CIVIL DIV. <sup>1</sup>
■	Incorporated Place <sup>1</sup>
■	Census Designated Place <sup>2</sup>
■	Voting District
●	SLD-Senate
▲	SLD-House

Military  Inset  Out Area

Abbreviation Reference: AIR - American Indian Reservation; SDAISA - State Designated American Indian Statistical Area

<sup>1</sup> A "\*" following a place name indicates that the place is coterminous with a MCD. A "-" indicates that the place is also a false MCD. In both cases, the MCD name is shown only when it differs from the place name.

<sup>2</sup> A "\*" following a VTD code indicates an actual voting district. Its absence indicates that the VTD is a pseudo voting district or no information is available as to its status.

### Voting Districts

Code	Name
3*	ChillicotheCityWard1
4*	ChillicotheCityWard2
5*	ChillicotheCityWard3
6*	ChillicotheCityWard4
7*	ChillicotheCityVoting District
8*	CreamRidge Voting District
12*	Jackson Voting District
16*	RichHill Voting District
17*	Sampsel Voting District

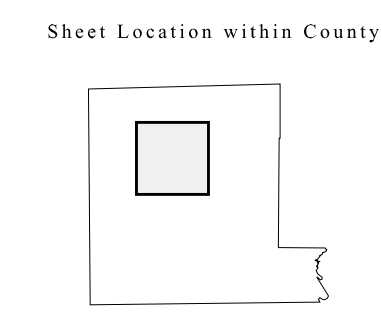
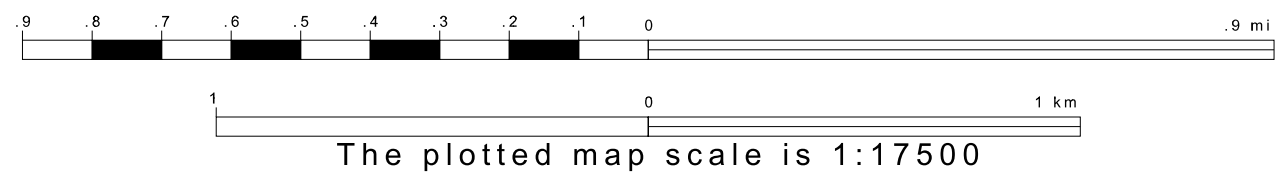
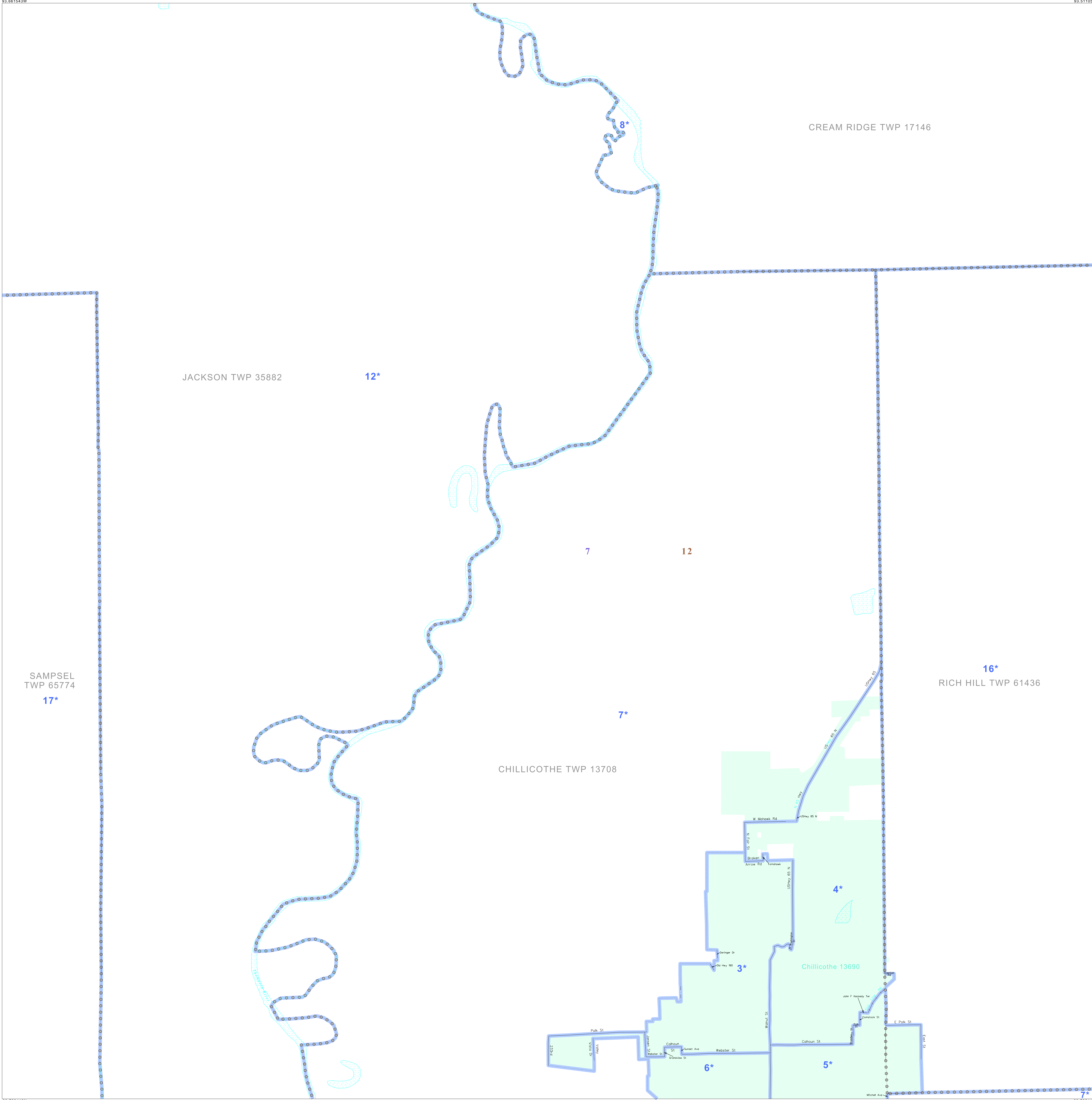

Key to Adjacent Sheets

1	2	3
4	5	6
7	8	9

ST: Missouri (29)  
 COU: Livingston (117)  
 SHEET 5 OF 14 PARENT SHEETS



All legal boundaries and names are as of January 1, 2000. The boundaries shown on this map are for Census Bureau statistical data collection and tabulation purposes only; their depiction and designation for statistical purposes does not constitute a determination of jurisdictional authority or rights of ownership or entitlement. U.S. DEPARTMENT OF COMMERCE Economics and Statistics Administration U.S. Census Bureau