

P. L. 94-171 COUNTY BLOCK MAP (CENSUS 2000)

36 850746N
92 854225W

36 850746N
92 889471W

GEOGRAPHIC AREAS LEGEND

SYMBOL	NAME STYLE
*****	INTERNATIONAL
///////	STATE
■■■■■	COUNTY
□□□□□	MINOR CIVIL DIV ¹
■■■■■	Incorporated Place ²
■■■■■	Census Designated Place ²
.....	Corporate Offset Boundary
●●●●●	Voting District ³
■■■■■	Census Tract
■■■■■	BLOCK ³
■	Military
■	Inset
■	Out Area

1 A "-" following a place name indicates that the place is coterminous with a MCD. A "-" indicates that the place is also a false MCD. In both cases, the MCD name is shown only when it differs from the place name.
 2 A "*" following a VTD code indicates an actual voting district. Its absence indicates that the VTD is a pseudo voting district or no information is available as to its status.
 3 A "-" following a block number indicates that the block number is repeated elsewhere in the block.

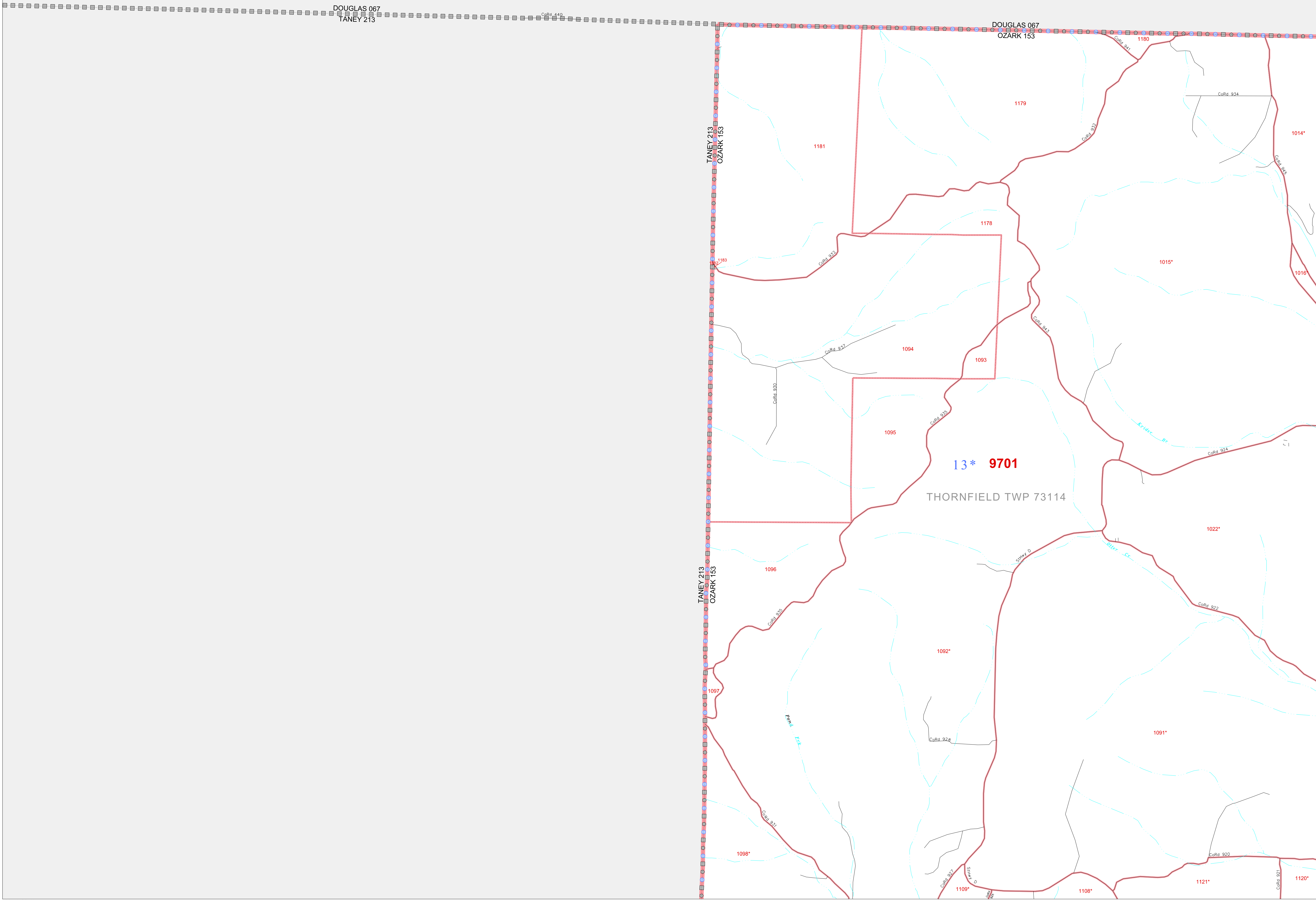

36 717987N
92 854225W

36 717987N
92 889471W

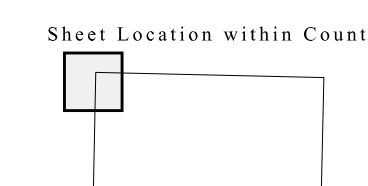
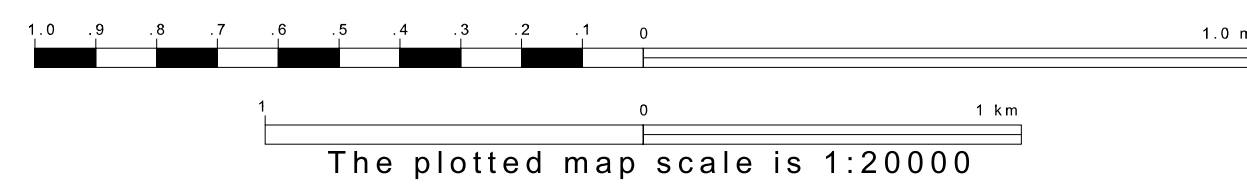

Key to Adjacent Sheets

	1 2	
	6 7	

ST: Missouri (29)
 COU: Ozark (153)
 SHEET 1 OF 15 PARENT SHEETS

