

GEOGRAPHIC AREAS LEGEND

SYMBOL	NAME STYLE
*****	INTERNATIONAL
//////	STATE
□□□□□□	COUNTY
○	MINOR CIVIL DIV. ¹
■	Incorporated Place ¹
■	Census Designated Place ²
■	Voting District
●●●●●●	SLD-Senate
▲▲▲▲▲▲	SLD-House
□	Inset
□	Out Area

Abbreviation Reference: AIR - American Indian Reservation; SDAISA - State Designated American Indian Statistical Area

¹ A "*" following a place name indicates that the place is coterminous with a MCD. A "-" indicates that the place is also a CSD. In both cases, the MCD name is shown only when it differs from the place name.

² A "*" following a VTD code indicates an actual voting district. Its absence indicates that the VTD is a pseudo voting district or no information is available as to its status.

Voting Districts

Code	Name
4*	Hardin Voting District
5*	Knoxville Voting District
8*	Millville Voting District
11*	Richmond 1&2 Voting District
12*	Richmond 3&4 Voting District
13*	Slet Voting District

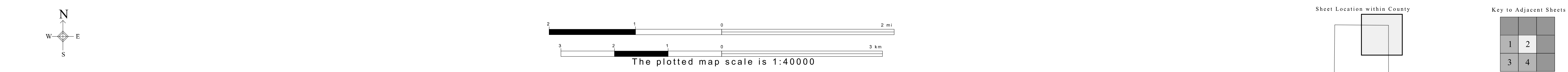
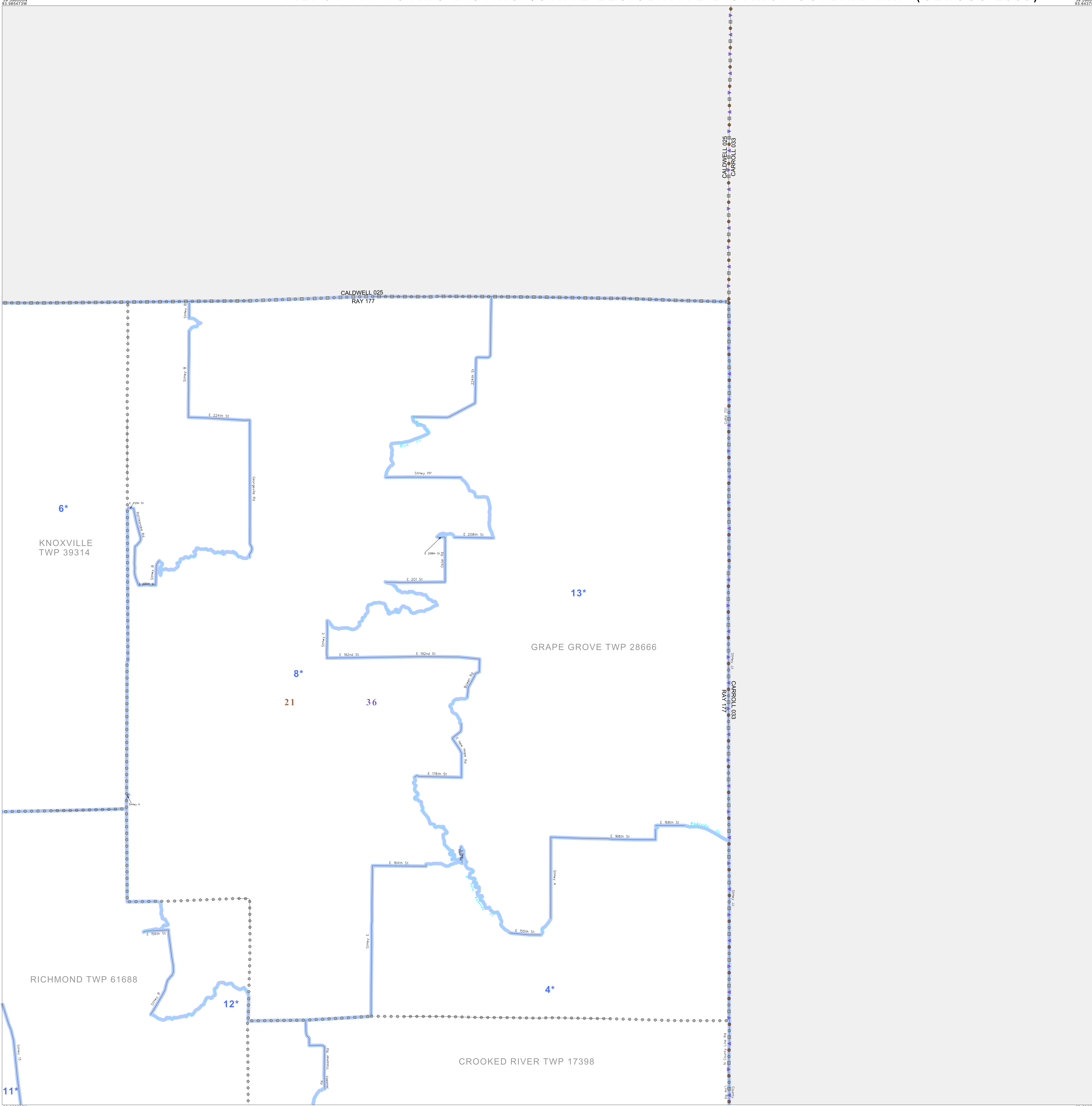

ST: Missouri (29)
 COU: Ray (177)
 SHEET 2 OF 4 PARENT SHEETS

P.L. 94-171 VTD/SLD OUTLINE MAP (Census 2000)
 (CKPLVTD) 2152917700200000000

All legal boundaries and names are as of January 1, 2000. The boundaries shown on this map are for Census Bureau statistical data collection and tabulation purposes only; their depiction and designation for statistical purposes does not constitute a determination of jurisdictional authority or rights of ownership or entitlement. U.S. DEPARTMENT OF COMMERCE Economics and Statistics Administration U.S. Census Bureau