

MIROBRIGA

EAST BATHS
ROOM 14

Room 14

Mirabriga 1982

EAST Baths
Room 14

Amy Mechlin
Paula Pote
James Rehard

Datum Point = 223.352

The area to be excavated has been designated for location as Room 14 of the East Baths. The area's dimensions will be a ~~1.5m~~^{2m} x 2m. trench. Balis are designated north, south, east, & west, the west balk being the irregular edge of exposed fill seen from Room 13. The south balk is flush with the south wall of Room 14. The datum point for the area is the ~~pointed~~^{scratched} point on the S wall. ^(243/352) No features within the area were visible preceding excavation, ~~the~~ balk shows only rubble fill down to a floor level.

This area was dug by James Richard, Amy Mecklin, and Paula Pote.

MIKOBKIG A 1982
EAST BATHS
ROOM 14

Top. 223.30
Bottom. 223. ~~50~~ 00

July 28 - Wed.

Locus 001
P.B. 1 NO POTERY

Clearing for beginning photos.
Begin clearing locus 001 a
destruction layer (seemingly
undug) composed of sand size
soil (Munsell 7.5YR 7/4 pink),
numerous boulders (limestone),
cobble, broken tile & brick,
mortar, + fragments of schist.
Kleber's accounts for approx. 45-
50% of the locus. 001 covers
the entire area + is a fairly
compact material.

PHOTOS:

82-293 View to South
showing walls + balk

82-294 View to west

Note: P.B. #1 cut into loc 002 - description of 001 top soil ~~does~~ should include sledge brick + stone inclusion (also below in 002)

largest tile frags. measure 20cm x 14 x 5 → 21 x 26 x 5cm.

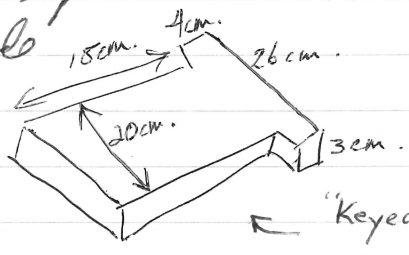

← "Keyed" - type floor tile found in 002 level

July 29
~~Monday~~

New Locus 002
P.B. 2

5 YR 4/4 reddish brown

East Baths
Room 14

July 28

Locus 002 P.B.2 (cont.) This is a layer of building debris partially removed in P.B.1 as 001.
No Pottery Soil matrix of 5YR 4/4 reddish brown ~~and~~ to 7.5YR 4/4 dark brown soil with granule to pebble size mortar inclusions. About 60-75% of this locus is building debris in the form of fired building ~~tiles~~ (some still bonded with mortar to one another in groups of 2 to 3), ~~and~~ ceramic tiles (mostly fractured) and cobble to boulder size limestone rocks (white, yellow, + red (dolomitized) limestones) and grey-green slate. All of these elements can be seen in walls 003 + 004

top 223.00
bot. 222.75

New Locus 003 Assigned to fillstone wall which forms the southern boundary of this excavated area. Wall 003 runs 125° E of N, is 2 to 3 courses wide w. rubble filled center. Stones are roughly heavy limestone and slate with occasional ceramic tiles or bricks. Top of wall is 60 cm thick. Wall 003 bonds w. wall 004

New Locus 004 Assigned to a fillstone wall which ^{partially} forms the western boundary of this excavated area. Wall 004 runs 215° E of N and bonds w. only 62cm wall 003. Wall 004 is of limestone and slate + is ca. 46 cm wide. This wall ^{well} forms a right angle w. wall 004. Some traces of a concrete facing remain on the lower portion of wall 004.
on the W & N face.

TOP PLAN #1

11/03/86 1987
EAST BATHS RM 14
7/29/82

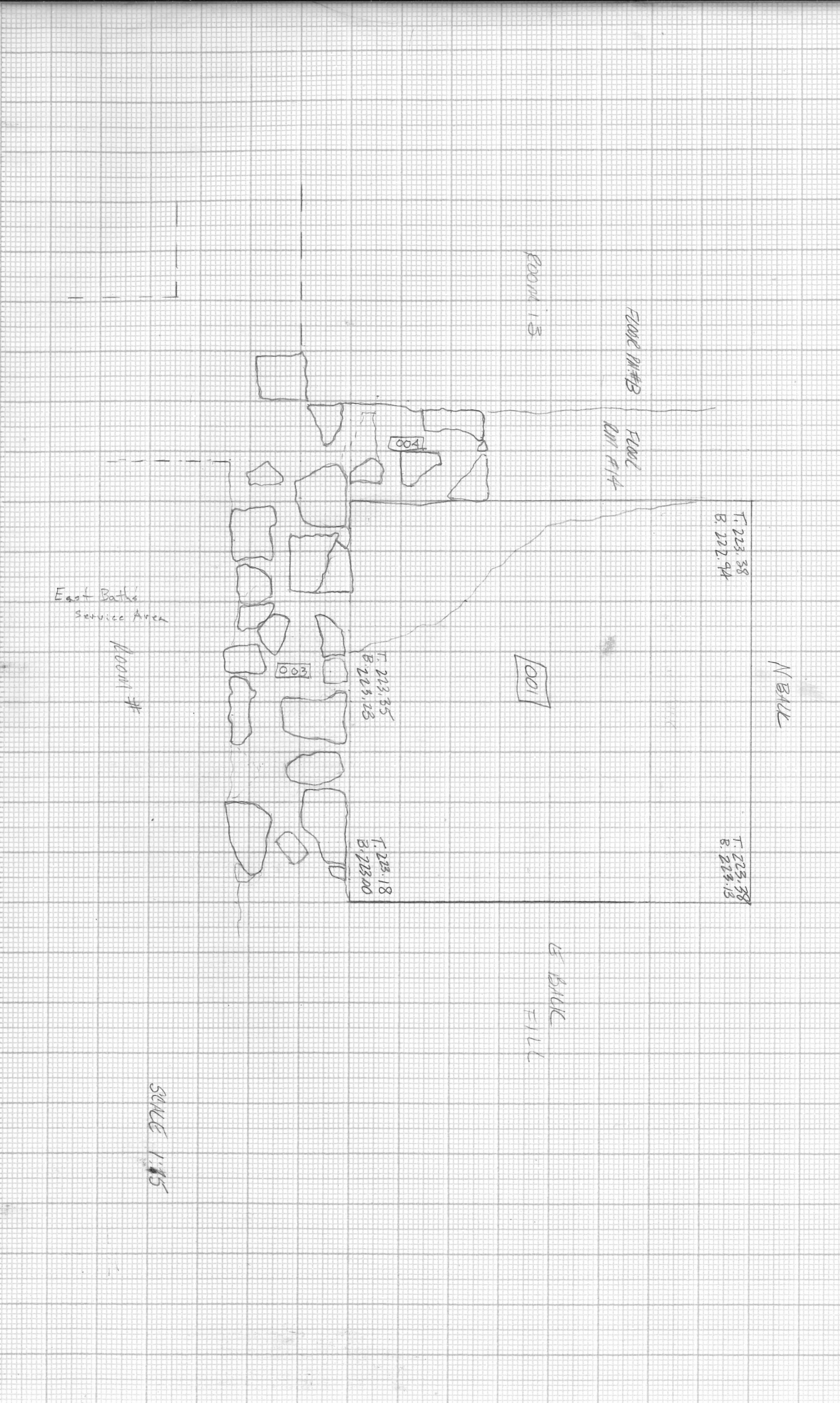

ROOM 13

EAST BATHS

ROOM #14

004

T. 223.38
B. 222.94

East Baths
Service Area

Room #

003

T. 223.35
B. 223.18

001

N BULK

T. 223.38
B. 223.18

T. 223.18
B. 223.00

E BULK
FILL

SINCE 1.15

Mississippi 1982
East Oaks
Room 14

July 29

Towns 002
P.B. 3

Continue removing building rubble from area begun yesterday. Area touches wall 003 to 2.00 west of 003 and from wall 004 to 2.00 east of wall 004. Matrix & composition remain the same as yesterday, perhaps a few more examples of natural brick today though especially in lower levels.

top 222.75

both NE 222.65

SE 222.62

NW 222.52

Room 13

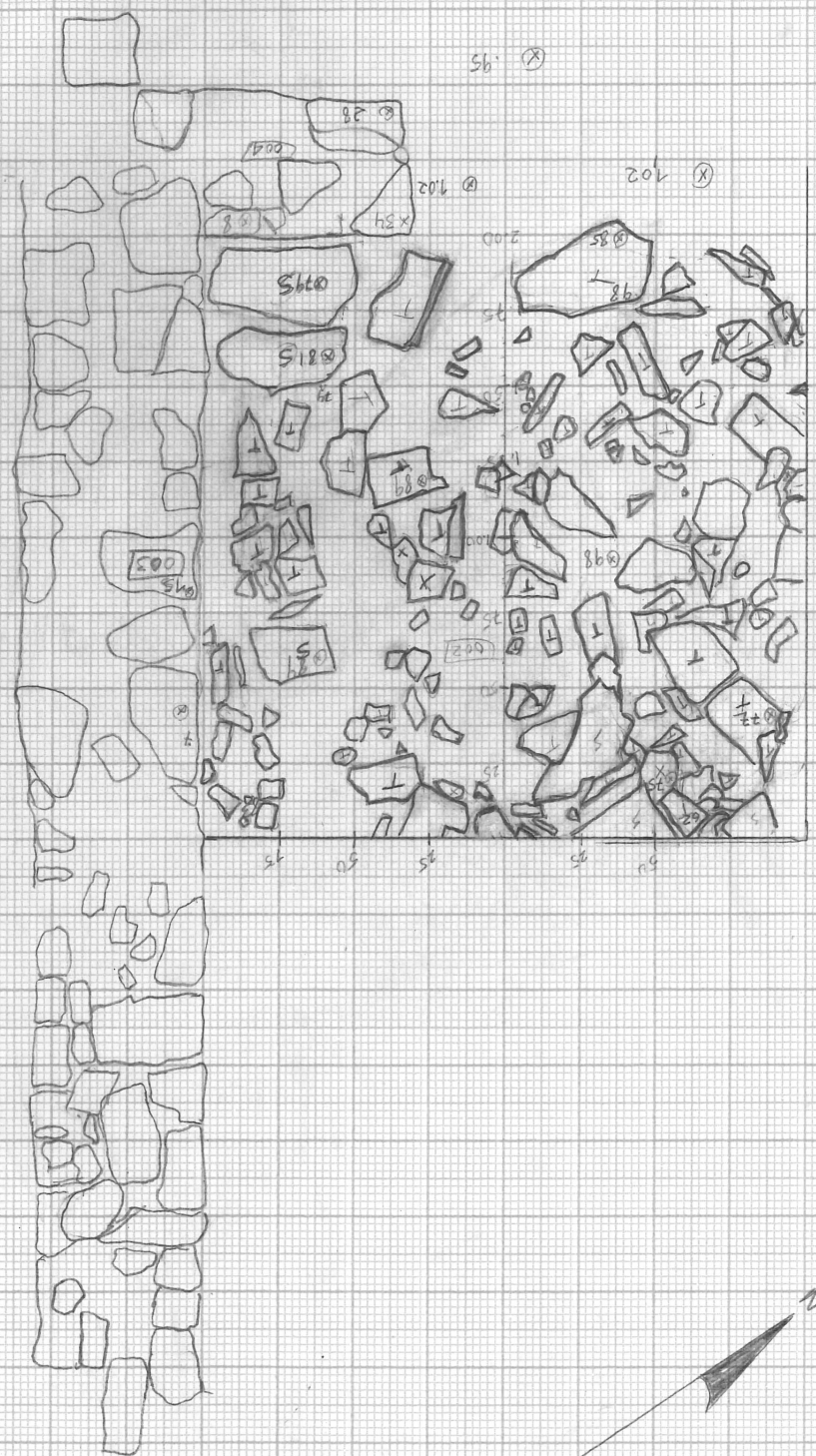

26
 26
 25
 56
 56
 41
 25
 29
 82
 81
 58
 29
 22
 152
 43
 153
 18
 141
 50
 50
 52
 52
 50
 60
 72

Scale 1:25

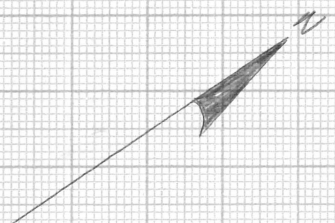

Miesbrunn 1982
 East Bath Rm. 14
 7/30/82

MIRROBRIGA 1987
EAST BATHS
ROOM 14

July 30

Top. 222.52
Bottom. 222.37

Focus 002
P.B 4

PHOTOS:



82-397 View to SE showing E balk

82-398 View to NW

Continue removing focus 002,
until the ~~is~~ probably
flooring is reached, the
last bit of 002 is
the lowest strata of 002
is being drawn for the
top plan by Paula.

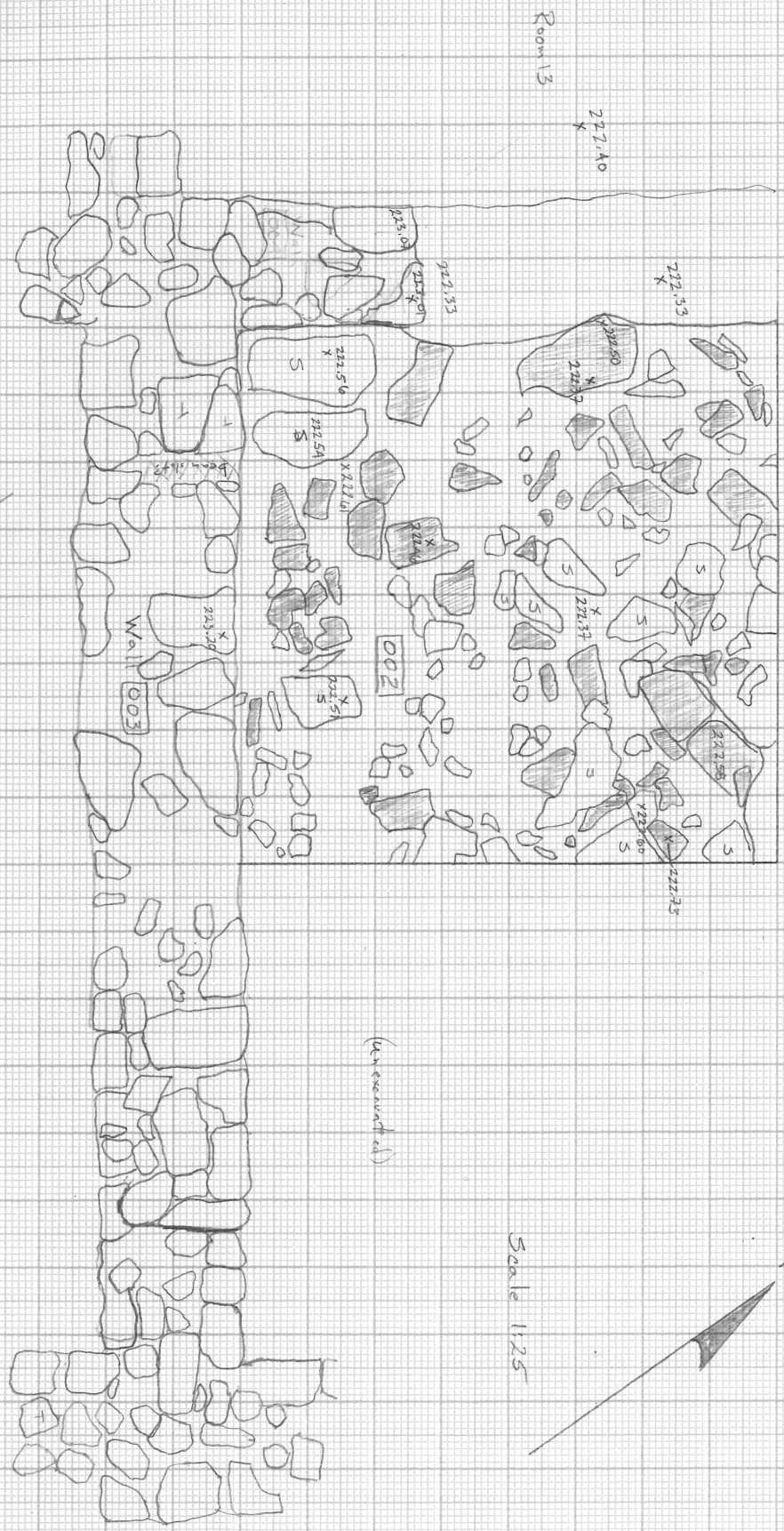
End of day notes: Since rubble hauling is being
made, remainder of day was spent clearing tops of
walls 003 & 004. Also the tops of these walls
as they extend westward into room 13 and
eastward ~~to~~ across unexcavated portion
of room 14. We were able to find the eastern
extent of wall 003 & this will be added to
top plan when time permits



 = Ceramic Tile/Brick
 = Stone

East Baths Service Area

Scale 1:25

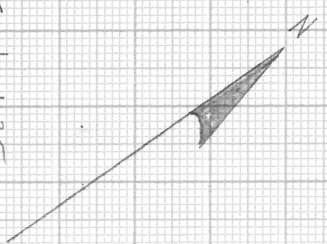

(in southeast ed)

~~P4~~

MIROBRIGA 1982
EAST BATHS
ROOM 14

July 31 - Sunday

No excavation in Room 14 today. Top plan of fall of debris layer 002 was completed between intermittent rain showers. Worked only in the morning today & mostly cleaning Room 13.

Aug. 2 - Monday

Top. ~~98~~ (222.37)
Bottom . . 98 (222.37)

Locus ~~001~~ ~~002~~ 002
P.B 5

Final removal of 002 - 1 bone frag from this P.B.

New Locus 008
P.B 6

Top 98 (222.37)
bottom (222.25)

Changed locus for control still removing building debris (brick, ~~tile~~ tile, mortar, slate)
the matrix 5YR 4/4 'reddish brown
mortar - 10 YR 7/3 very pale brown
+ pockets of 7.5 YR 5/6 strong brown sand
The sand pockets seem to make the matrix softer

(Room 13)

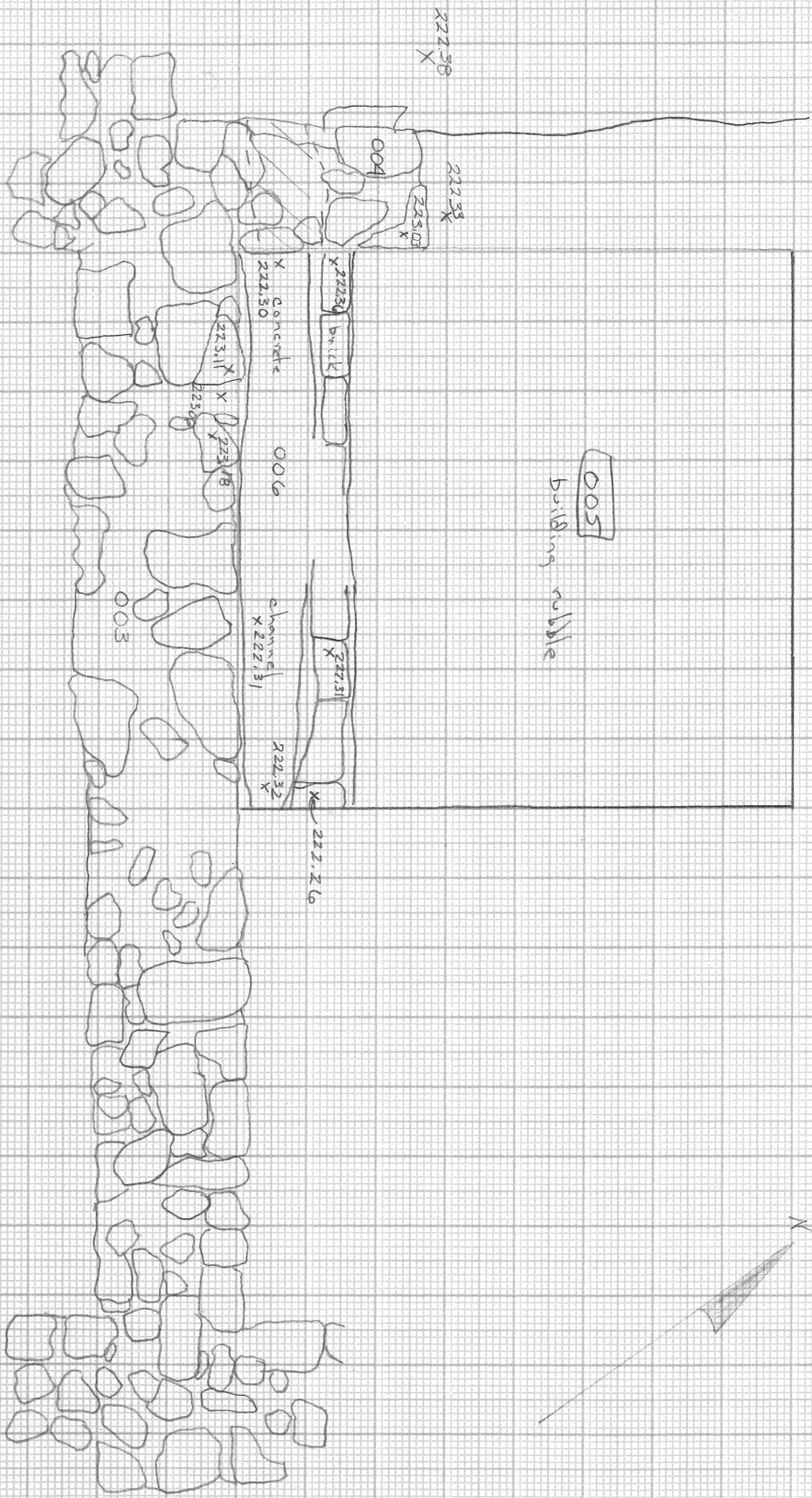

Mirebrigs 198
 East Baltic
 Aug 2

Mindigo 1982

East Baths

Room 14

Aug. 2 (cont.)

P.B. 6 (cont.)

005 is the material under the bottom of 002 & was originally thought to be just above a floor (as suggested from elevation in floor of nearby Room 13). However removal of 005 revealed a change in level from Room 13 to 14 - no floor at the Room 13 ^{floor} level in Room 14. I noted installation 006 - an apparent brick & concrete faced water channel was found along side wall 003, starting at well 004. Installation 006 extends northward from wall 003 about 30 cm. North of 006, debris layer 005 continued downward & reveal the collapse of a stack of squared ~~and~~ tiles across the area of excavation on a N-S axis. These tiles fell on long rectangular tiles that are aligned along side one another. Not all of layer 005 was removed today. There are different types of tiles in 005 - curved tile (roof tile?) a few "keyed" tiles, square tile, rectangular tile.

Mimbiqua 1982
East Battery
Room 14

Aug. 2 (cont.)

New tower 006 assigned to a brick & concrete installation which is built along side the north face of wall 003. Seems to be a channel formed in the top of this, probably for water transport.

Approximate cross section of 006:

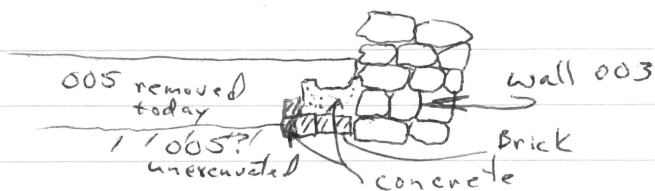

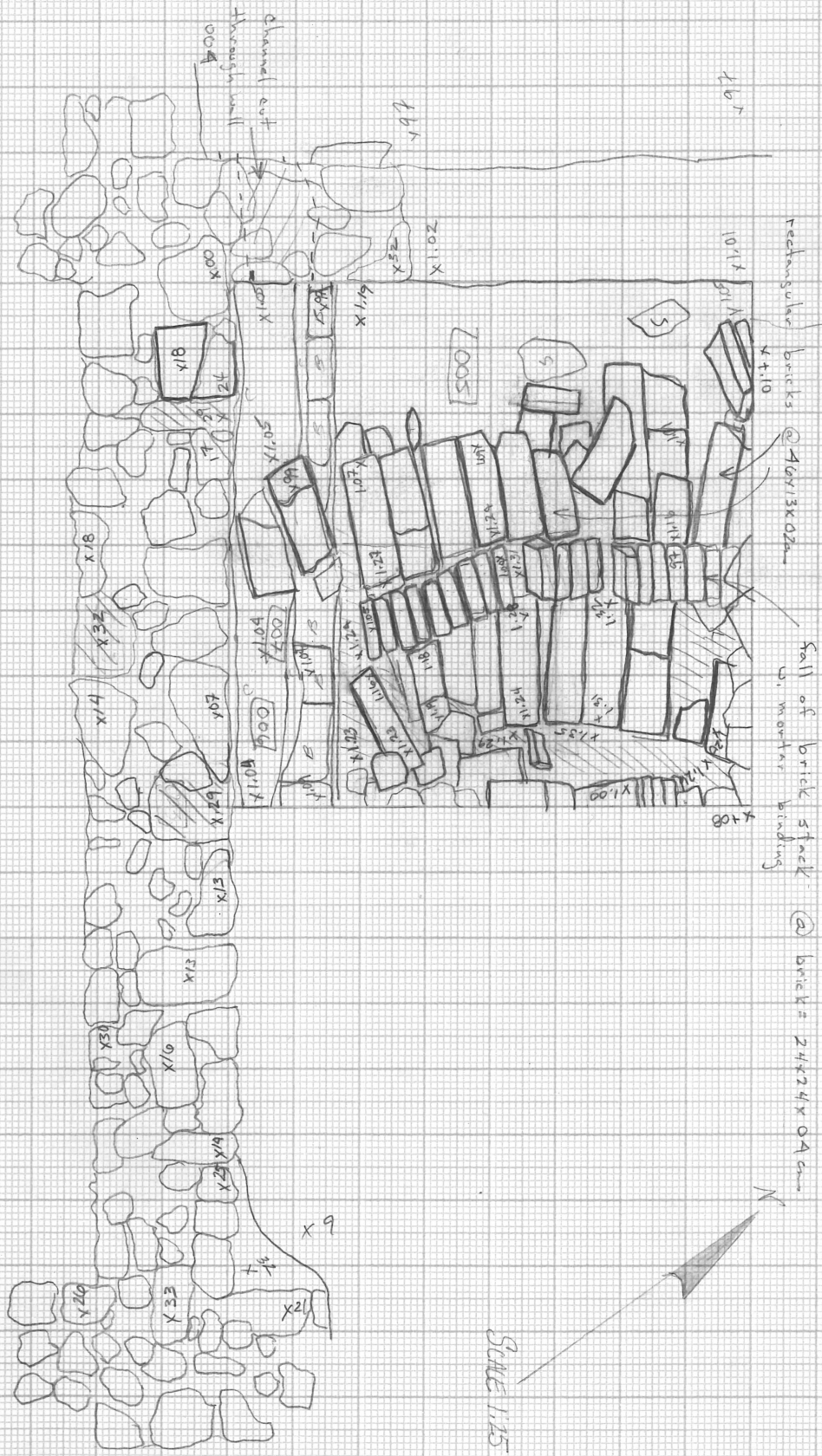

MARILISA 1982
 EAST BATH UNIT
 9/30/82

Mikolaj 1982
 East Bath Room 1A
 Final Top Plan

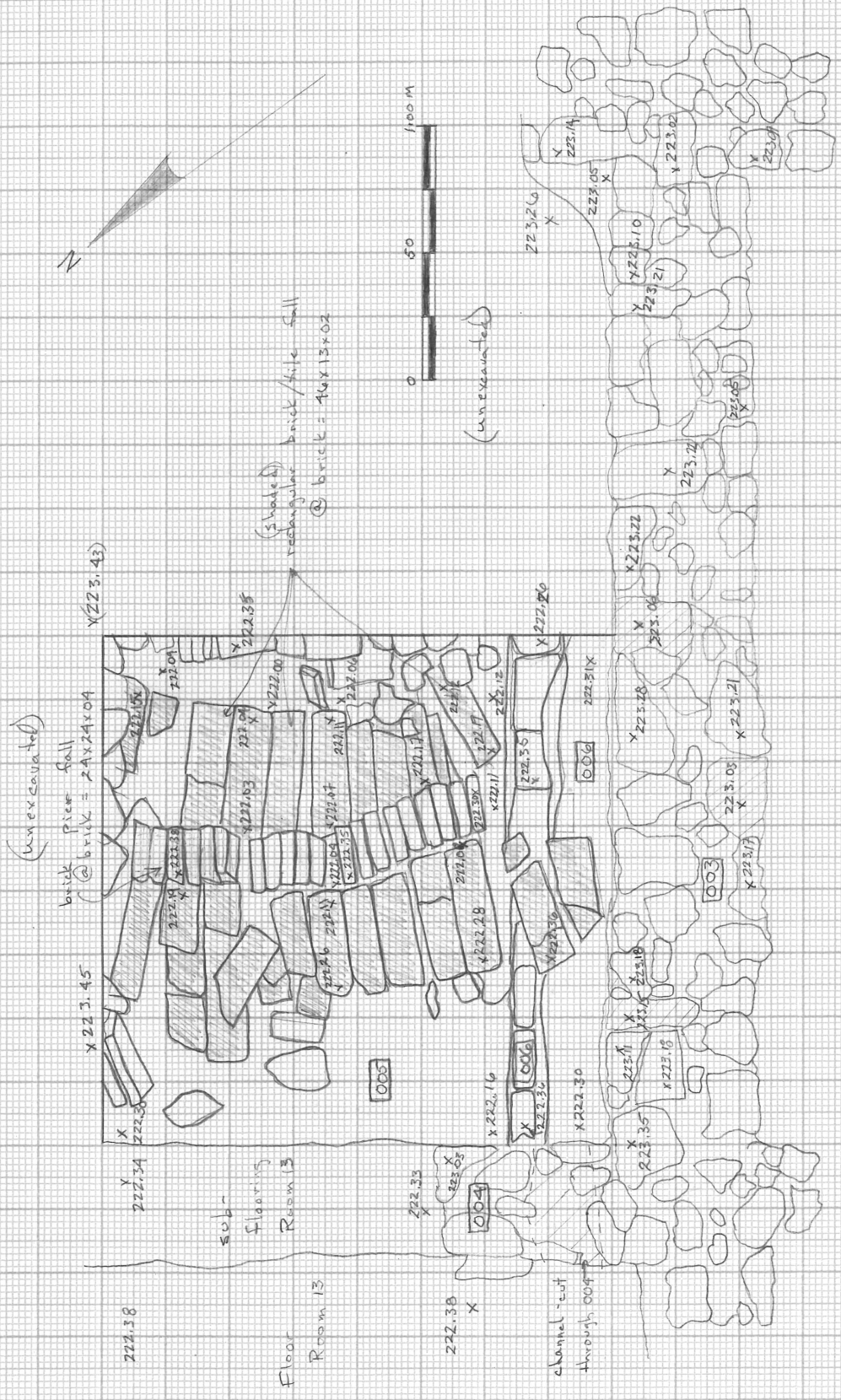

East Bath Service Area

Mirabeja 1982
East Baths Room 14

August 3

P.B.#7 Focus 005 Continue removing debris
from around the alignment of fallen
No Pottery tile (bricks?). In this debris layer
are numerous tiles or bricks of various
size - some curved tiles (roof tiles?)
which were about 1 cm. thick, & one very
large intact brick - 31 x 31 x 04. The
bricks forming the fallen stack are all
24 x 24 x 04 and the long rectangular
bricks they've fallen on are 46 x 13 x 02.
top 222.25
bottom 222.00

P.B.#8 NEW Locos 007 assigned to 10PR4/4
dark yellowish brown soil in drain/channel
A few shreds 006 along north face of wall 003. Soil
is hard & crumbly, inclusive of pebbles & cobble
size slate & limestone fragments.

Bone sample

top 95 ~~222~~ (222.40)
bot. 1.05 (222.30)

Also 007 continued westward beneath wall
004, forming a tunnel connecting 006 with
room 13.

Aug. 4

Photo #	Final Photos
82 - 532	view to west
82 - 533	" " S
82 - 534	" " N
82 - 535	+ E East side
82 - 536	± E general

Room 14 is located to the east of Room 13 and to the north of the service area for the East Bath complex. A 2x2 meter area in the south west quadrant of the room was excavated this season. Rooms 13 & 14 are separated by two pilaster wall sections joined by a common floor. Previous excavation by Almeida (sp?) has exposed exposed Room 13 and the opening between the two rooms but did not touch the deposits in Room 14. Thus Room 14 had a visible balk which we were able to use as a guide for our 1982 excavation. The southern wall - 003 - formed the southern extent of the excavated area and the western wall - 004 - formed the western limit. Our probe ~~is~~ extends ~~for~~ 2 meters from both of these walls.

Wall 003 ~~is~~ bonds with wall 004 at a right angle. Wall 003 continues eastward from the excavated area for another 1.80 meters where it ~~is~~ bonds with another wall which turns back to the north. Two possible beam slots are near the top of the exposed wall. ⁰⁰³ Wall 004 is narrower than wall 003 & extends only 62 cms. to the north of wall 003. A cutting has been made through wall 004 at the floor level of Room 13. This cutting empties into channel 006 which was built along the north face of wall 003 & touches the east face of wall 004. Channel 006 is of ~~the~~ mortared bricks & faced with concrete (the concrete facing

East Baths Room 14

also continues up the north face of wall 003 for about 30-35 cms. The channel 006 is parallel with wall 003 and was used to drain water from Room 13. The north face of channel 006 is faced with a concrete/plaster which also faces the east face of wall 004 and continues northward along the sub flooring of room 13. Thus the plaster facing along the channel 006 & wall 004 forms the uppermost limits of an architectural feature (pool perhaps).

Into the architectural feature bounded by the plastered walls and onto the top of channel 006 as well, fell a cluster of bricks or tiles, all $46 \times 13 \times 02$ cms. These are all aligned along side one another in 2 rows, 2 tiles of one row fell onto the top of channel 006. Onto these tiles fell a stack of bricks, all $24 \times 24 \times 04$ and still bonded together with mortar. 21 of these square bricks were exposed in this probe. There seem to have been a pier & would have been at least one meter high. This stack of bricks & the bricks they fell on compose the bottom of debris layer 005 which was characterized by numerous bricks & tile fragments and stones. Above debris layer 005 was debris layer 002 which had fewer bricks & tile and ~~had~~ more large stones. Debris layers 002 & 005 are interpreted as the collapse of wall 004, 003 & walls to the N & E of this excavated area.

Mirebriga 1982

Final Summary p.3

East Baths Room 14

Excavation of the probe in Room 14 was ceased for the 1982 season due to a lack of time. The exposed stack of bricks and the tile/bricks they fell on were left in situ in order that they remain until the 1983 season. ~~when~~ ^{then} the entire room can be excavated to this level and the full extent of the bricks exposed. Once the remainder of the brick pier collapse is exposed ~~the~~ understood, the pool (?) can be cleared.

Respectfully submitted
on Aug. 5, 1982
James Ruland

EAST SECTION

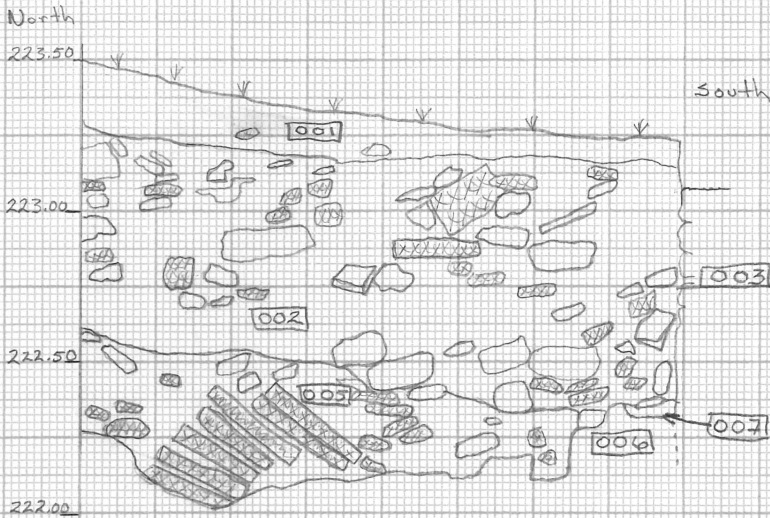

 = Brick

 = Concrete/Mortar facing

SOUTH SECTION

(North face of Wall 003)

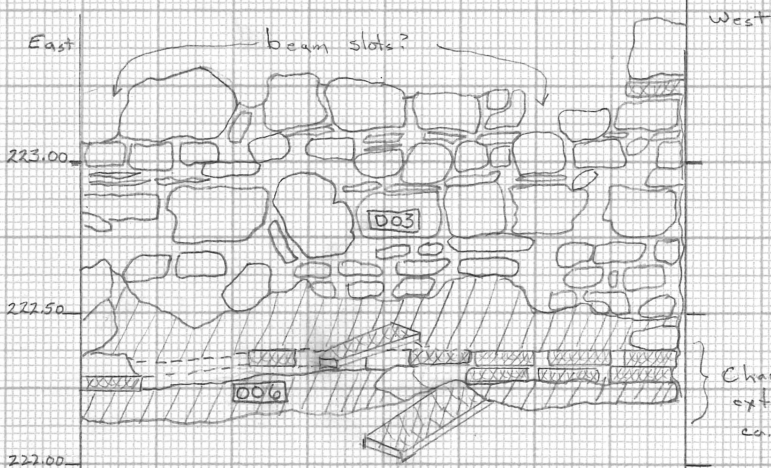

Channel 006 extends northward ca. 30-35 cms from 003

YEAR 1982, 1983

GRID AREA East Baths Room 14

SITE Mirebriga

LOCUS NO. 001

GENERAL IDENTIFICATION Top soil

DATE (s) July 28, 1982
June 17, 20, 21, 1983

Top levels 223.50 Top plan July 28; Bottom levels 223.25 Top plan _____

Sections East Drawn by architect _____ Photo No. 82-293
82-294

PHYSICAL DATA

What is it made of?: Mostly soil - rain wash w. occasional stone or brick fragments, 1983

What size particles? sand to granule Color 7.5YR 7/4 pink

Features

Compass orientation _____

_____ courses high; _____ rows wide

Overall dimensions _____

How was it built?:

Soil Layers

Direction & Degree of slope slope downward from N to S

Degree of compaction: hard, permeable

Distribution of particles (e.g., random, laminated, graded bedding)

STRATIGRAPHIC DATA

This Locus is below ~~loc.~~ Surface & is above Loc. 002

Lateral extent 2x2m Max. thickness 10cms touches balk(s) E, N, S, W

How does this Locus relate to all other loci it touches?:

above all others - including tops of wall 003 & 004

This Locus is contemporary with which loci mentioned above?:

None

How was this Locus formed?:

rain wash from higher elevations to the north and east

No Battery

10/11/85

03-243

10/11/85

YEAR 1982

GRID AREA East Batho Rm 14

SITE Mirobriza

LOCUS NO. 002

GENERAL IDENTIFICATION Debris layer

DATE (s) July 28

Top levels 223.25 Top plan 7/29; Bottom levels 222.50 Top plan 7/31

Sections E Drawn by architect _____ Photo No. 82-397
~~82-398~~

PHYSICAL DATA

What is it made of?: Building debris in a soil matrix. Debris includes fired bricks (20x19x5, & 21x26x5) also couple of keyed tiles (see drawing July 28 notes); limestone fragments - cobble to boulder size, slate, mortar.

What size particles? soil - fine sand to granule Color 5YR 4/4 reddish brown
to 7.5YR 4/4 dark brown

<u>Features</u>	<u>Soil Layers</u>
Compass orientation _____	Direction & Degree of slope <u>Slight slope from N to S</u>
____ courses high; ____ rows wide	Degree of compaction: <u>hard</u>
Overall dimensions _____	Distribution of particles (e.g., random, laminated, graded bedding)
How was it built?:	<u>random fall</u>

STRATIGRAPHIC DATA

This Locus is below Loc. 001 & is above Loc. 005

Lateral extent 2x2m Max. thickness 65cm touches balk(s) E, S, N, W

How does this Locus relate to all other loci it touches?:

butts against walls 003 & 004

This Locus is contemporary with which loci mentioned above?:

probably contemporary w. debris layer 005

How was this Locus formed?:

by collapse of wall 003, 004 & walls to N & E of excavated area

YEAR 1982

GRID AREA East Baths Rm 14

SITE Minoabaiga

LOCUS NO. 003

GENERAL IDENTIFICATION Wall

DATE (s) 7/28

Top levels 223.35 Top plan 7/28; Bottom levels ^{not excavated} to foundation Top plan Final

Sections E, S Drawn by architect _____ Photo No. 82-293
-294

PHYSICAL DATA

What is it made of?: ^{hewn} field stone + occasional bricks

What size particles? cobble to boulder Color _____

Notes North of Wall 003 is Room 14, South of wall 003 is East Baths Service Area

Features

Compass orientation ca. 125° E of N

7 courses high; 3-4 rows wide

Overall dimensions 3.80 x .60

How was it built?: rubble fill between mortared sides

Soil Layers

Direction & Degree of slope _____

Degree of compaction: _____

Distribution of particles (e.g., random, laminated, graded bedding)

STRATIGRAPHIC DATA

This Locus is below Loc. 001 & is above Loc. _____

Lateral extent _____ Max. thickness .60 touches balk(s) E wall 004

How does this Locus relate to all other loci it touches?:

wall 003 is bonded with wall 004; installation 006 (channel) touches the N face of wall 003

This Locus is contemporary with which loci mentioned above?:

004 + 006

How was this Locus formed?: stone by stone

YEAR 1982

GRID AREA East Baths Room 14

SITE Mirobriga

LOCUS NO. 004

GENERAL IDENTIFICATION Wall

DATE (s) 7/28

Top levels 223.27 Top plan 7/28; Bottom levels foundry levels not excavated Top plan Final

Sections None Drawn by architect _____ Photo No. 82-293
- 294
532-536

PHYSICAL DATA

What is it made of?: hewn field stone (limestone)

What size particles? cobble to boulder Color _____

Note: East of wall 004 is Room 14, West of wall 004 is Room 13

Features

Compass orientation 215° E of N

_____ courses high; 2-3 rows wide

Overall dimensions 46 x 62

How was it built?: hewn limestone & mortar. Channel 006 was cut through wall 004 to form a small "tunnel"

Soil Layers

Direction & Degree of slope _____

Degree of compaction: _____

Distribution of particles (e.g., random, laminated, graded bedding)

STRATIGRAPHIC DATA

This Locus is below Loc. exposed previous to excavation & is above Loc. _____

Lateral extent 46 x 62 m Max. thickness 46 touches wall 003-bonded ~~back(s)~~

How does this Locus relate to all other loci it touches?:

bonds with wall 003 and channel 006 touches the E face of wall 004 - cuts through

This Locus is contemporary with which loci mentioned above?:

wall 004, channel 006

How was this Locus formed?:

YEAR 1982

GRID AREA East Baths Room 14

SITE Mino briga

LOCUS NO. 005

GENERAL IDENTIFICATION Debris layer

DATE (s) Aug. 2

Top levels 222.65 Top plan 8/3; Bottom levels 222.35 Top plan Final

Sections E Drawn by architect _____ Photo No. 82-532-554

PHYSICAL DATA

What is it made of?: soil matrix with brick, tile, ~~slate~~ slate, and limestone fragments (cobble to boulder size)

What size particles? soil - ^{silt} ~~fine sand~~ to granule Color 5YR 4/4 reddish brown

<u>Features</u>	<u>Soil Layers</u>
Compass orientation _____	Direction & Degree of slope <u>irregular top</u>
_____ courses high; _____ rows wide	Degree of compaction: <u>hard & clayey</u>
Overall dimensions _____	Distribution of particles (e.g., random, laminated, graded bedding)
How was it built?:	Bottom of 005 has a fall of a brick pier onto 2 rows of rectangular tiles (see final top plan)

STRATIGRAPHIC DATA

This Locus is below Loc. 002 & is above Loc. not excavated further

Lateral extent 2x2m Max. thickness .50 touches balk(s) E, N

How does this Locus relate to all other loci it touches?:

butts against wall 003 & 004 - covers channel 004

This Locus is contemporary with which loci mentioned above?:

002

How was this Locus formed?: collapse of wall 003, 004 & wall to N & E of area excavated

Mirabriga 1982
GENERAL IDENTIFICATION

Locus No. 006

Date (s) Aug 2

Top levels 222.36 Top plan 8/2; Bottom levels not excavated to foundation level Top plan Final

Sections 5 Drawn by architect Photo No. 82-532-534

PHYSICAL DATA

What is it made of?: brick & concrete

What size particles? _____ Color _____

<u>Features</u>	<u>Soil Layers</u>
Compass orientation <u>125° E of N</u>	Direction & Degree of slope _____
<u>2</u> courses high; <u>2</u> rows wide	Degree of compaction: _____
Overall dimensions <u>31 x 2M x 23</u> ^{exposed at}	Distribution of particles (e.g., random, laminated, graded bedding)
How was it built?: <u>mortared bricks & then faced with mortar/concrete. Built to form a channel for water drainage from Room 13</u>	

STRATIGRAPHIC DATA

This Locus is below Loc. 005-007 & is above Loc. not excavated further

Lateral extent 2M Max. thickness .31 Touches balk(s) E

How does this Locus relate to all other loci it touches?:

built along the north face of wall 003 & runs from East face of wall 004

This Locus is contemporary with which loci mentioned above?: 004 & 003

How was this Locus formed?:

built against N face of wall 003 after destruction of wall plaster

YEAR 1982

GRID AREA East Baths Room 14

SITE Mirobriga

LOCUS NO. 007

GENERAL IDENTIFICATION Debris layer

DATE (s) Aug. 3

Top levels 222.40 Top plan 8/3; Bottom levels 222.30 Top plan 8/3

Sections E Drawn by architect _____ Photo No. None

PHYSICAL DATA

What is it made of?: soil with pebble to cobble size limestone & slate fragments

What size particles? sand to granule Color 10YR 4/4
dark yellowish brown

<u>Features</u>	<u>Soil Layers</u>
Compass orientation _____	Direction & Degree of slope _____
____ courses high; ____ rows wide	Degree of compaction: <u>hard</u>
Overall dimensions _____	Distribution of particles (e.g., random, laminated, graded bedding) <u>random</u>
How was it built?:	

STRATIGRAPHIC DATA

This Locus is below Loc. 005 & is above Loc. 006

Lateral extent _____ Max. thickness 10cms touches balk(s) E

How does this Locus relate to all other loci it touches?:

This is a soil-debris which fell into channel of installation 006.

This Locus is contemporary with which loci mentioned above?:

contemporary w. debris fall 005

How was this Locus formed?:

collapse of building.

Room 14, 1983

East Balun, Room 14

June 17 Workmen began excavation (after
 Locus 001 removal of dump yesterday) in an area
 Basket 1-wapo ca. 3.80m E/W x 4.60m N/S max. D.
 Photo 83.2.3 in an L-shaped area N and E of 1982
 test trench. Top levels 222.932 S, 223.302 N.
 Area extends over top of NE and SE
 walls of Rm 14. Began first with strip
 1.65 m wide along NW side.

Two stones resting on hillside above
 NE wall were moved. Both are cut
 in similar fashion.

Photos

83.3.7

83.3.8

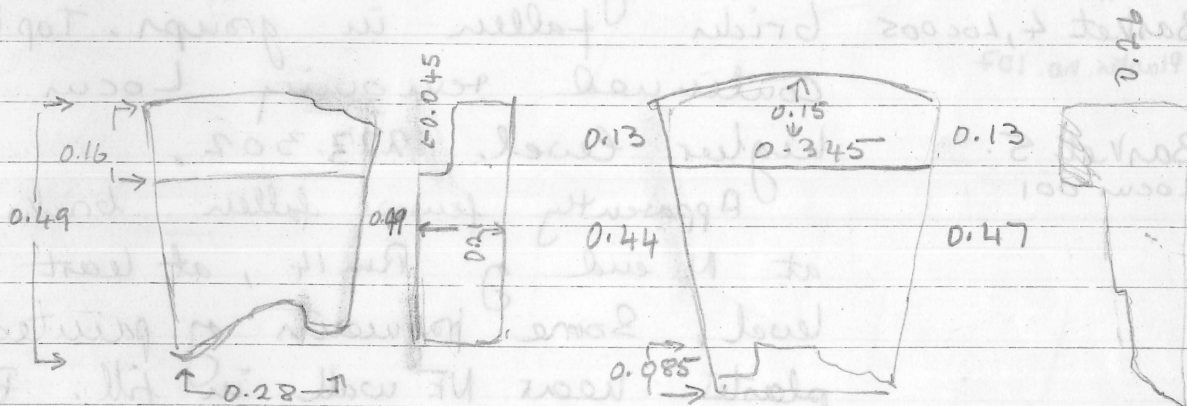

Large rectangular stone was also moved
 According to guard it was originally found in the
 hypocaust of Rm 17, tilted on one end.
 P.L. 1.33?, W. 0.40, H. 0.21. Rough surface.
 Stone: Limestone?

Marble block also moved from scarp. Found
 by de Almeida in Rm 13. P.L. 0.76, Max P.W. 0.17
 Max P.H. 0.13.

2 worked faces preserved

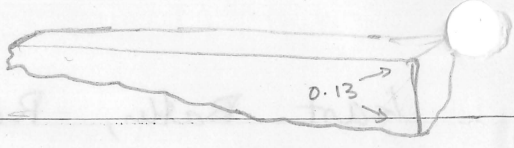

Locus 002 AT 222.662 well into Locus 002. Darker soil, more stones from collapsed wall.
Basket 2
no pottery

Locus 001 Stopped digging just above layer of fallen bricks reached last season. Started workman on another section of fill with Basket 3
Basket 3
no pottery

Monday June 20 Locus 005. Digging fill just above level of fallen bricks, exposing more bricks fallen in groups. Top level 222.132
Basket 4, Locus 005
Plaster no. 107
Basket 5. Locus 001
Continued removing Locus 001 at higher level. 223.302.

Apparently fewer fallen bricks in groups at N end of Rm 14, at least at this level. Some fragments of painted wall plaster near NE wall in fill. Began to clean a patch of fill of brick fragments, ^{on face of wall} ^{near NW corner} ^{could see} more fragments of painted plaster in section, obviously fallen. Stopped cleaning.

At 221.837m - reached top of ledge along NE wall. Stopped going down ^{immediately to south or} here and began cleaning off protective fill from 1982 season of southern part.

East Bath, Room 14

- June 21 Top of NE wall had some fill on top.
 Locus 001 Began cleaning this off. Top of this wall
 Basket 6 further to SE reached yesterday; cleaned
 this off this morning. Workmen continued
 digging Locus 001 at high level
 while students removed protective fill from
 area uncovered in 1982 and begin with Basket 7
 articulating level reached yesterday with
 Basket 4. kept back along higher level.
 Locus 005 with Basket 6 top of SE wall ^{at 222.697}
 Basket 7 room exposed and face of wall with
 Plaster no 108 some unpainted plaster, heavily protective
 layer of dirt over it.
 Plaster no 108 → with Basket 7 more fallen bricks
 uncovered. Fragment of plaster 0.09 x 0.10
 m. max dims with remain of yellow painted
 surface with red design. $W. 0.04, L. 0.06$
 (max dims of pres. painted face) resting
 against wall below ledge on NE side
 of room.
 Photo
 83.2.14 → Hunk of earth and filler-plaster
 earth + plaster fragments adhering to ~~NE~~ NE wall of room.
 on face of wall has been removed. Top level 222.837. Bottom
 level 221.837. ca 0.10 m thick. cleaned
 off face of wall to East also where had left

some dirt for protection. At base of wall painted plaster preserved in situ. Removed dirt, but put some loose earth back. Continued removing 005 to reveal fallen bricks

with Basket 6 a patch of white mortar with brick aggregate uncovered on top of SE wall of room at 222.932 m. at 2.00 m. from S corner of room. 0.40 m wide. Level at end of day 222.367 except for 1.0 m wide strip at ^{W.}

June 22
Basket 8
Locus 001
no pottery

Workmen continued removing Locus 001 at N end. Top level 222.942 down to level in rest of area 222.367. Narrow balk left along edge then removed. Although kept this as Locus 001, digging has gone deeply into 002, earth quite dark, darker than 002 in last year's test trench

Basket 9
Locus 002
= Plaster #95

Patch of earth and fallen wall plaster adhering to NE wall was removed today. Quite large fragments preserved, one 0.22 m long. Color: reddish purple, yellow with red pattern. Underneath plaster in situ on NE wall and on NW spurs wall was revealed: a dark stripe as a border on NE wall with red inside - possibly some kind of low dado at base. Yellow or red on spur wall with vertical red borders at corners.

East Bath, Room 14

- June 22
Basket 10
Locus 002
No pottery
Plaster no 96
- Workmen continue going down over whole SE side of room. Top level 222.367
Fragments of painted plaster coming up: yellow with red decoration; frag. of blue. These from NE ^{quarter} of room. Still many large stones, some brick fragments
- 83.2, 35, 36
C 83.3, 4 and 5
- Finished removing tumble of earth and fallen plaster. Photos of plaster in situ on NE wall and NW spur wall before cleaning. Began drawing design as record before trying to clean up surface.
- Basket 10
No pottery
- With Basket 10 a large fragment of flooring preserving raised edge. White mortar with brick aggregate, max L. 0.46, max W. 0.27. Another smaller fragment Digging to south; little ^{pld} no. wall plaster frags coming up. Still many large stones
Levels at end of day: 222.392 N, 222.012 S
- * Very large stone upended against SE wall.

Room 14, East Batter

June 23

Locus 002
Basket 11
Workmen continued in SE half removing fill of stones, brick frags and earth, first removing balk left along edge. Many stones, head size, some brick frags including flanged ones.

Photo
83.3.6
Patch of white mortar with brick aggregate on SE wall of Room
with Bark 11 fill much darker on S side of room, mixed with more crumbled mortar on N. Reached continuation of water channel running along ledge of SW wall, some cover tiles. Water channel appears to turn corner.

Photos
83.3.9 whole NE wall
83.3.10 detail
83.3.11 NW wall
83.3.11 Corner
Colos
C 83.3.13, 16
Wall plaster. Washed surface with water to remove mud, revealing white stripes as border for black line seen yesterday.

Plaster 97
Workmen continuing to dig 002. Some painted frags coming up in ^{quarters} NW side of room. Several more cover tile frags. Coming down on brick fall and clearing off surface one quarter brick in fill Th. 0.06, H. 0.16 from column.

Locus 007
Basket 12
no pottery
Began clearing in water channel along SW wall soil very compact; small frags of ash. Edge of channel badly preserved. One row of bricks and remains of mortar lining

Nirobira

East Baths, Room 14

June 24

Began cleaning walls of room, removing

Locus 002

protective layer of dirt left over face.

Basket 13

(Plaster nos 98-99)

Painted wall plaster fragments coming up.

Basket 14

(Plaster no 100)

Basket 13 for plaster from NE wall

Basket 15

(Plaster 102)

Basket 14 " " " " SE wall, N end

Basket 15 " " " " " " " " S end

Basket 16

Pottery

With Basket 14 yellow fragments at north end whereas grey fragments are coming up more towards the center, but still north of patch of mortar on top of wall.

Below patch of mortar wall appears to be broken away and large stones have been packed in. Not yet cleaned off.

cover tiles - 15 frags from lowest loc. pass taken yesterday. Several preserve one ^{or two} edges but no complete diameter could be taken. Max P.L. 0.37 m. Max P.W. 0.17. Apparently two types. One has much shallower curve

P.M. continue cleaning face of wall which appears to be preserved below packing of two large stones in center of SE wall. Three

thin flat bricks have fallen close to the SE wall north end. The mortar with which they were laid is powdered underneath and chunks of the same type of mortar were removed from the fill in this area.

A pinkish grey mortar - close to 7.5YR 6/2. Also some fragments of white mortar with brick aggregate came up in this area.

The drain or water channel along SW wall apparently has an outlet through the SE wall just north of junction with SW wall, ca. 0.26 m. from corner.

Some bricks laid flat north of outlet. Traces of mortar on edge of ledge further north.

East Bath, Room 14

June 27 Continue removing painted plaster frags fallen against walls of room and cleaning dirt from face of plaster still in situ. Basket 17 ~~from~~ for plaster from NE wall near East corner.

Locus 002
Basket 17
Plaster nos 103, 104

Also began cleaning heavy fill from tumbled bricks over whole area of room (or pool as it must be). Fragment of roof tile (pan tile with raised edge) & other similar frags in fill. Bricks decomposed in NW part of room.

Locus 005
Basket 18

Locus 002
Basket 19
Plaster nos 105, 106

Basket 19 for plaster on SE wall at N end

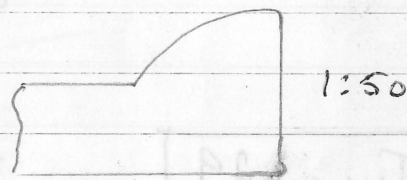

At end of day walls have been cleaned of fallen earth and plaster except for 2 1/2 long flat bricks resting at an angle against north end of SE wall. Still some fallen plaster frags underneath. Plaster in situ at base of wall in area cleared has not yet been washed, or down.

for removal
see p. 12

June 28, 1983

East Ballus

Room 14

Locus 005

Cleaning off tangle of bricks, stones and mortar for record that photos before removing some so that area can be drawn.

Photos: 83.4.1-9 Views from all directions.

C 83.4.6-14

Locus 005

Basket 20

Plaster no. 109

Continued removing more bricks and tiles to expose more than flat bricks lying flat. Some tile fragments, both coars and pan tile

June 29

Brushed surface and pushed removing some smaller brick fragments in preparation for drawing of the area.

~~Fragment~~ Lubricer

~~Pan tile~~ Area - 50 to 60 map recovered with Locus 005. Several different types - small high; large and shallow. Distinguished 3 types; examples taken up for inventory.

East Baths, Rm 14

June 30

Locus 008

Basket 21

Drawing completed, began removing some of the bricks fallen at a higher level.

Photos:

83.6.8-11

83.5.3 and 4

Fragment of a brick arch fallen at entrance. Th. mortar 0.05 at top, 0.01 at base. 3 bricks preserved - of ~~flange~~ type with flanges. Levels on highest stacks of bricks 221.727 and 222.097. Level on flat bricks 221.727 and 221.807

987

New locus no for the fall of bricks and tile.

Pan tile frag.

Flanged. ~~broken~~ brick w 0.25 top; ^{P.W} 0.20 bottom L. 0.32. Th. 0.045. flanges at bottom broken away ^{or some} Th. of mortar ~~0.045~~ 0.005 fine greyish white

Room 14

July 1

Locus 008

Basket 22

Locus 002

Basket 19 (4)

Continued removing bricks and some fill. Began working wall plaster in situ.

Still removing some fallen fragments. Used Basket no 19 of June 27 for those against the SE wall on the ledge below 2 1/2 flat bricks. Basket 22 for other fragments in Locus 008.

Took a line E/W through room at 1.88m from SW wall and began removing all visible bricks here, starting with ribs. ^{1st (Eastern) rib} to there

* one formed of square? bricks 0.24 L, Th. 0.038, with mortar thickness of 0.015, 0.02, 0.025. The mortar appear to be of uniform thickness and not part of an arch.

Second rib formed of flanged bricks L. 0.32, W. 0.24 upper, 0.21 lower w/o flange. flange project 0.03 m. Th. brick 0.035. Removed one section of 3 ~~at~~ bricks - mortar 0.01 at top narrowing to 0.005 at bottom. One flange missing on all 3 bricks.

* 1st rib also of flanged bricks. Proved too difficult to take out ribs first. Began removing flat ones also. These proved to be not completely flat but have a slight curve to them. Mortar appear to be all

* on the underside. Th. mortar 0.017-0.02 very pale brown grey mortar with coarse sand. 104R 713. 0

Room 14

July 1

Locus 008
Basket 22

cont. Brick L. 0.465; W 0.13; Th. 0.023-0.025.
1 frag of flooring - white mortar with
brick aggregate was removed from SE
shelf.

Two frags. covers tile removed with
the basket

Par tile, prop. 1, covers tile 1

Mortar on undersurface of long flat tile
varies in thickness? 0.012-0.017; 0.035

Photo:
83.10.23
C 83.7.3

Mortar on ^{several} ~~one~~ tiles stops at 0.025 ^{or 0.032} from one
short edge. One complete example shows that ^{on} both
edge short edges mortar stopped. Traces of fine white
mortar preserved on some bricks at ~~the~~ ^{the} ends.

Lump of charcoal 0.15 m long, ca. 0.015
0.125
m deep removed from ca. 3.0 m from SW
wall just below threshold.

Under ^{lowest} ~~second~~ fall of flat bricks at
west side fallen wall plaster, but seems to be
^{mostly} ₁ backing not painted surface. Some frags of
white and some light blue grey. Fall on
large stone

July 6 * Some of the thin flat bricks still in situ
in north part of trench base mortar on the upper
surface

Room 14

July 4

Locus 008
Basket 23
Plaster nos 111, 113

Little
No painted
plaster found.

Most of the bricks from the fall were removed on July 1. Continued in the south part of the trench removing fill of brick frags., stones from wall, some crumbled plaster. Large patch of fallen plaster removed in lumps from just SE of threshold. Will need conservator to separate.

Top levels 221.602 and 221.762. Very uneven surface. Much charcoal in small pieces, in west side fill more compact and clay-like except near SW wall. Reached first step at 221.577

After lunch put workmen in area to dig. Much ptl plaster frags coming up in SE quarter (as their morning), stones, brick fragments. Some of these are type used in screen wall construction. 0.08 x 0.05, P.L. D.17. Fragments of flanged bricks. Also some larger bricks 0.28 m W, Th. 0.05, still getting thin, narrow bricks. Large frag. of mortar with brick aggregate 0.04 thick. Fill appears quite dark; probably getting into another locus. Similar to fill on west side reached thru am. One painted frag. At end of day level 221.297 except for 0.80 m. east of step (221.577)

Room 14

July 5

Locus 008

Basket 24

Plaster no. 112
115

Continued workmen removing higher level of fill not taken out yesterday. Top level 221.577. More painted plaster fragments. At base of first step coming down on fall of flooring fragments and bricks probably resting on second step. 2 fragments of bricks, narrow brick W. D. 145, Th. D. 04, P. L. 0.185. Also more long bricks W. D. 07, Th. 0.05

Locus 009

Basket 25

Plaster 116

At 221.297 down into chocolate brown level all over trench. Fall of flooring frags still remain against first step at 221.49 top level. Locus 009 run over them here. Some fallen plaster fragments visible. Large stones, brick frags. Many wall plaster frags ^{and decayed mortar} near SW wall. Pantile frags. Long brick W. D. 07 x 0.05, P. L. 0.15, 0.22. One large pantile P. L. 0.31 with groove in base. Not getting any of them flat tiles/bricks as in Locus 008. More pantile frags. More large bricks, Th. 0.04-0.042, one with W. D. 29, many large chunks of fallen mortar with brick aggregate, Th. 0.035-0.04. 1 cover tile P. L. 0.36. Fill continuing the same but no painted plaster, or much brick or stone

July 5

Room 14

continued working with bricks from fall of neg. Several sections of flanged tiles/bricks had been removed together

Photos:

Mortar dimensions:

83.11.4-7

(1) 3 bricks - ~~0.005~~ - 0.025

83.7.8,9

(2) 3 bricks 0.005-0.012; 0.008-0.008

Groups

→ (3) 6 bricks together w. 0.30 bottom, 0.355 top.

measured from brick edge to brick edge

(4) 3 bricks top 0.195, 0.135

(5) 4 bricks top 0.20, bottom 0.20.

(6) 2 bricks top 0.09, bottom 0.09

(7) 3 bricks top 0.14, bottom 0.15

(8) 2 bricks top 0.10, bottom 0.09

(9) 3 bricks top 0.14, bottom 0.135

(10) 7 bricks top 0.33 bottom 0.36

(11) 5 bricks top 0.24 bottom 0.245

(12) 3 bricks top 0.16 bottom 0.14 cont p. - 21

Basket 25 cont.

1 quarter tile from a column.

At 221.122 m. reached top of second step. Level at end of day 220.952

Although brick frags of the correct thickness came up today, none had flanges.

July 6

Room 14

Locus 009

Basket 26

Top level 220.952
 Continued removing fill over floor of pool. No painted plaster coming up, or pottery. Brick frags, roof tile frags still abundant. Three frags of stone plaquel³ very surface very much destroyed. One a triangle $0.32 \times 0.23 \times 0.44$. Different types of bricks W. 0.22, Th. 0.038; W. 0.11, Th. 0.045; W. 0.15, Th. 0.032-0.036. No complete lengths.

With this basket 2 frags of flat ceiling tile 0.024. None thick bricks Th. 0.042-0.05

Partial tile frag with P.L. 0.31, P.W. 0.15
 other partial frag with
 kerbs at back
 20 frags. of pav tiles altogether
 from Locus 009
 Small brick frag 0.07 Th.

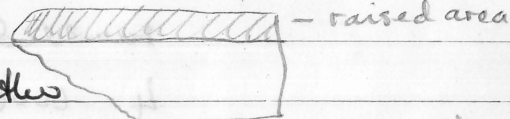

One frag. of flanged brick, the first clearly identifiable as such at this level.

A few pieces of painted plaster seen SE wall.

At 220.58^{-220.66} m. reached bottom of pool. Outlet lies at south corner.

Basket 27

Had workmen trim scarp. 1 piece of pottery & 1 bone.

Room 14

July 7

2hp

Dimensions of flanged bricks.
 H. 0.31, W. top 0.25 W. bottom w flanges
 0.27. flange project 0.025-0.03.
 Th. 0.04. H. of flange 0.032 tapering
 out to 0.03
 Flanged tiles have mortar on lower
 edge ca. 0.008th.

Locus 009 Roof tiles: 20 frags of pentile/tegulae
 several with notch at back. Most
 differ slightly in profile. Some are
 more upright.
 28 frags of imbricen
 cover tiles, 2
 sent up for in Denton.

Locus 008 Roof tiles - 3 frags of pentile
 removed, 1 still in unexcavated fill.
 4 cover tile frags

15 large frags of flooring (white +
 brick aggregate) 0.03 - 0.04 m-th.

5 fragments preserving a vertical corner
 2 frags with sloping
 edge probably
 from threshold of Ru 13
 into pool.

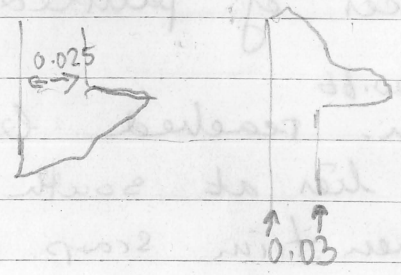

July 7

Room 14

83.10.31-34 General views

Final Photos:

.35 detail of drain

C 83.7.4-7 General views.

Final description - not really a step but kerb/d.

Steps. ^{treads} W. Upper 0.44; middle 0.405; lower 0.31

H. risers Upper 0.345; middle 0.47; lower 0.56.

Floor slopes down to outlet in S. corner ~~W 0.045~~ ^{where lead}

pipe preserved D. outlet 0.045.

Walls of pool - max H. 1.36.

Walls, floor and steps covered with well preserved white mortar with fine brick aggregate, Th. of layer 0.015-0.02. Junction ~~wall~~ walls and floor, riser of lower step and floor, vertical junction of walls and where step treads & risers meet wall of pool sealed with rounded mortar, 0.06-0.07 m. wide on horizontal ^{level} and vertical for riser of steps. In S. corner 0.10 m. wide across corner.

Since mortar of well preserved construction of steps and walls not visible except along upper edge ^{of pool} where some bricks are visible

wide ledge runs around three sides. W. 0.27-0.28, sloping down towards pool.

On SW ledge a water channel has been built mortar covering of ledge broken away for construction of bricks, two courses preserved at NW end, to form

outer wall, inner wall and floor formed of mortar with brick aggregate which also lined the brick outer walls & is preserved to H. 0.08m above floor of channel. W. channel 0.10 at base, 0.13 at top.

When channel was built wall plaster had already fallen off this wall since not preserved under mortar of water channel [presumably pool filled in?]

Outlet for channel is rectangular - W. 0.16, H. 0.10. One brick forms lintel.

Threshold block probably across entrance to pool. H. 0.12 m. indicated by preserved section of mortar sealing junction of floor of Room 13 & block.

walls: Max P.H. 1.47 above ledge. At 1.95 from S corner opening in SE wall begins, W. 0.54, bottom level 0.36m above ledge. Opening filled with two large stones and one brick fragment. On top a patch of mortar with ^{coarse} brick aggregate. [Should be cleaned out?]

Construction of walls: Stones, schist, white mortar. All bond together.

July 7

Room 14

Final photos:

83.11.10 - 15

General views

C 83.7.12 - 17

Continued from p. 16

Observations on ^{groups} ~~bricks~~ of flanged bricks. 10 groups were lifted together, ~~from the~~ ~~east side of the~~ measurements of individual mortar joints were difficult. Measurements of the groups were taken. In some cases there may be misleading since mud has settled in between the bricks, if bricks are from an arch it seems likely that it was a flat one. Only in a few examples can one be positive that the mortar is thicker at the top than at the bottom.

Mortar was adhering to the bottom surface of many bricks, but the upper surface was clear.



H. 0.05
W. 0.06

Holding at base of bottom step.

Room 14
East Bath
1:26

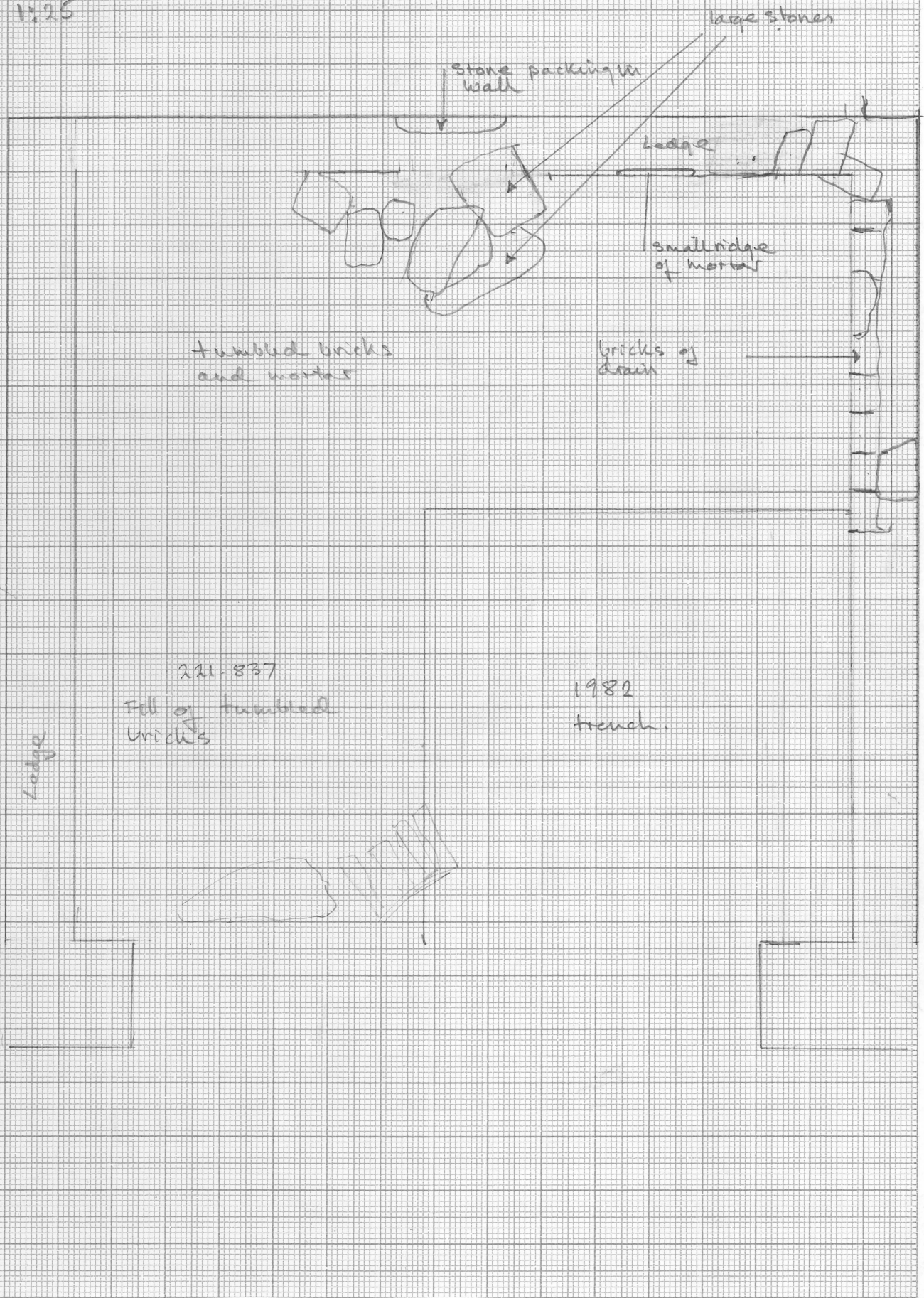

East Baths
Room 14

June 20-22, 1983

Scale 1:25

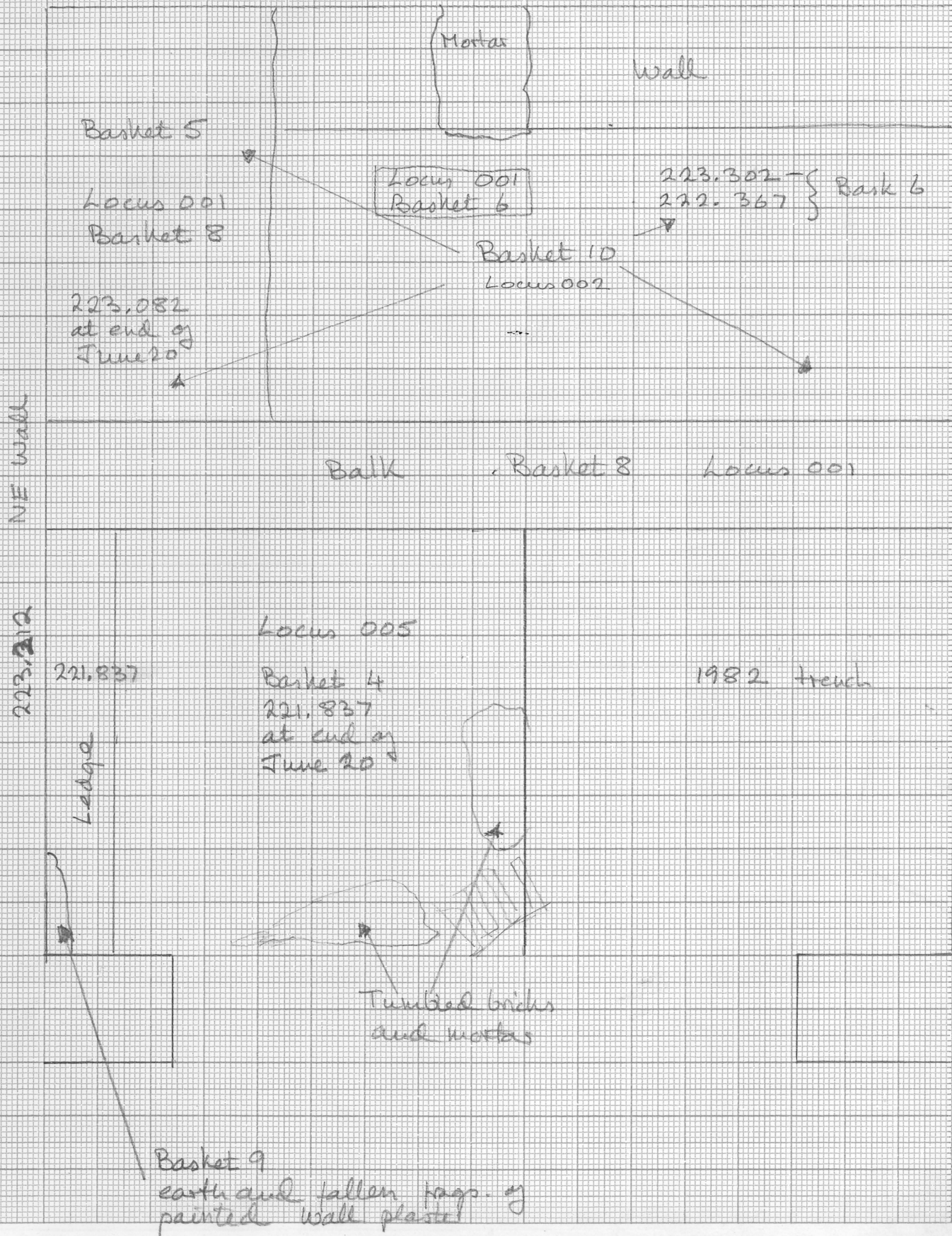
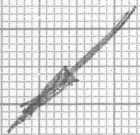

Room 14, 1983

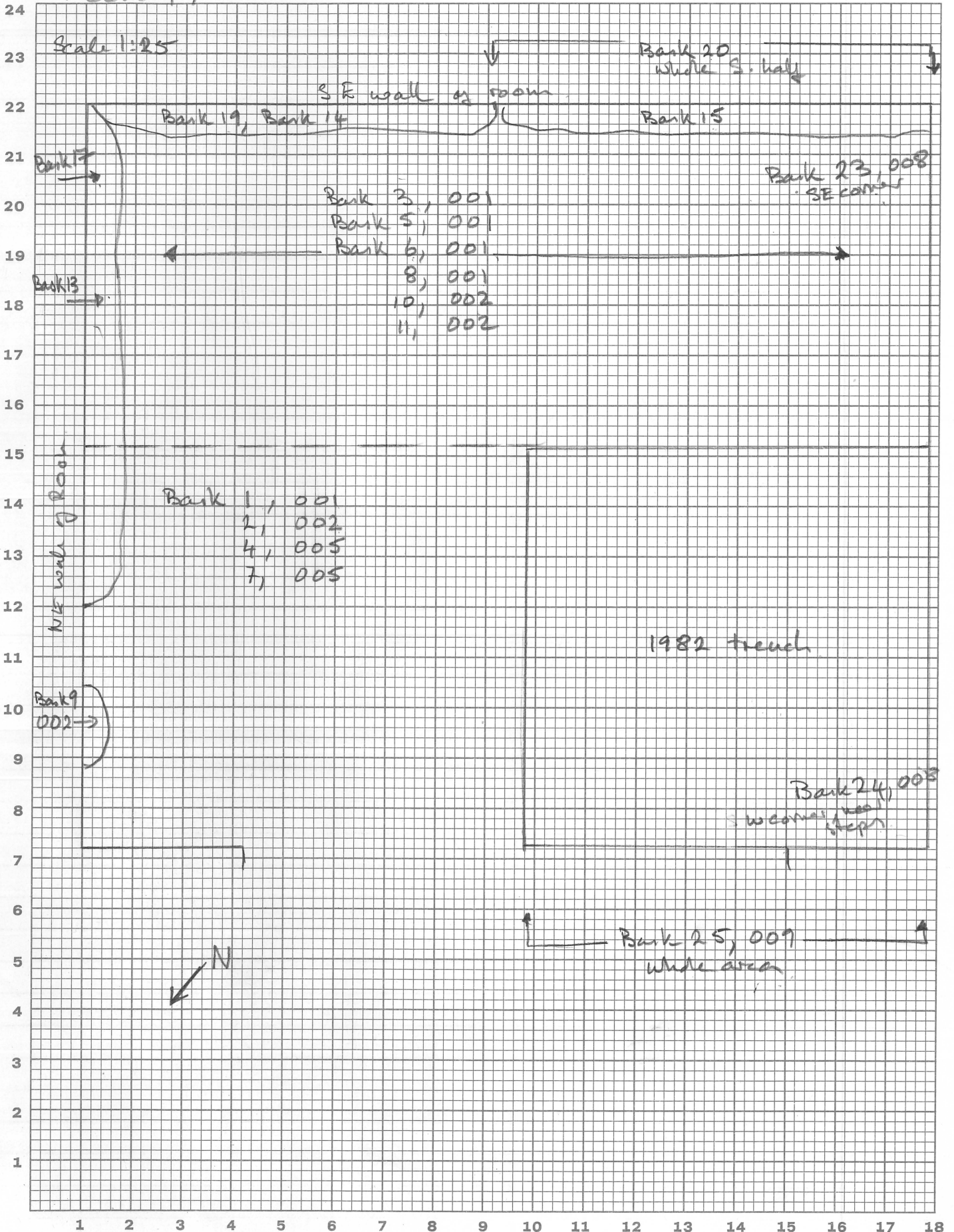

MIDOBRI6A 1983
N.W. SPUR WALL - WALL
PLASTER IN SITU
JUNE 22, 1983

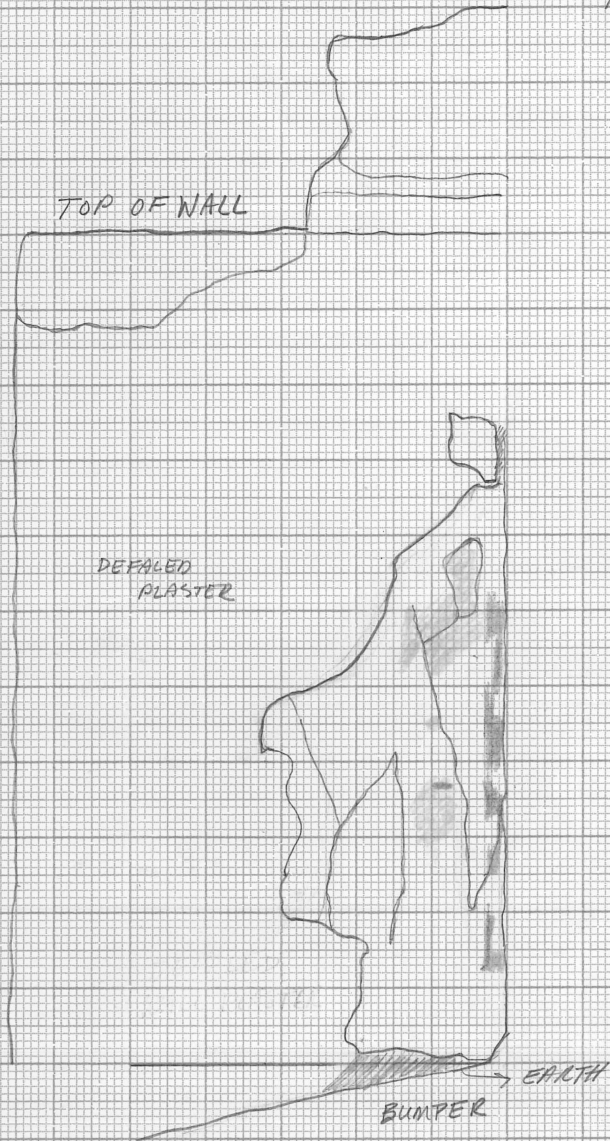

SCALE 1:10

At corner
Vertical Red Stripe 0.035
Vertical White Stripe P.W. 0.012

MIROBRIGA 1983
 NORTHEAST WALL
 ROOM 14 E. BATHS
 JUNE 22, 1983

TOP OF WALL

LINE OF DEFACED WALL PLASTER

23
6

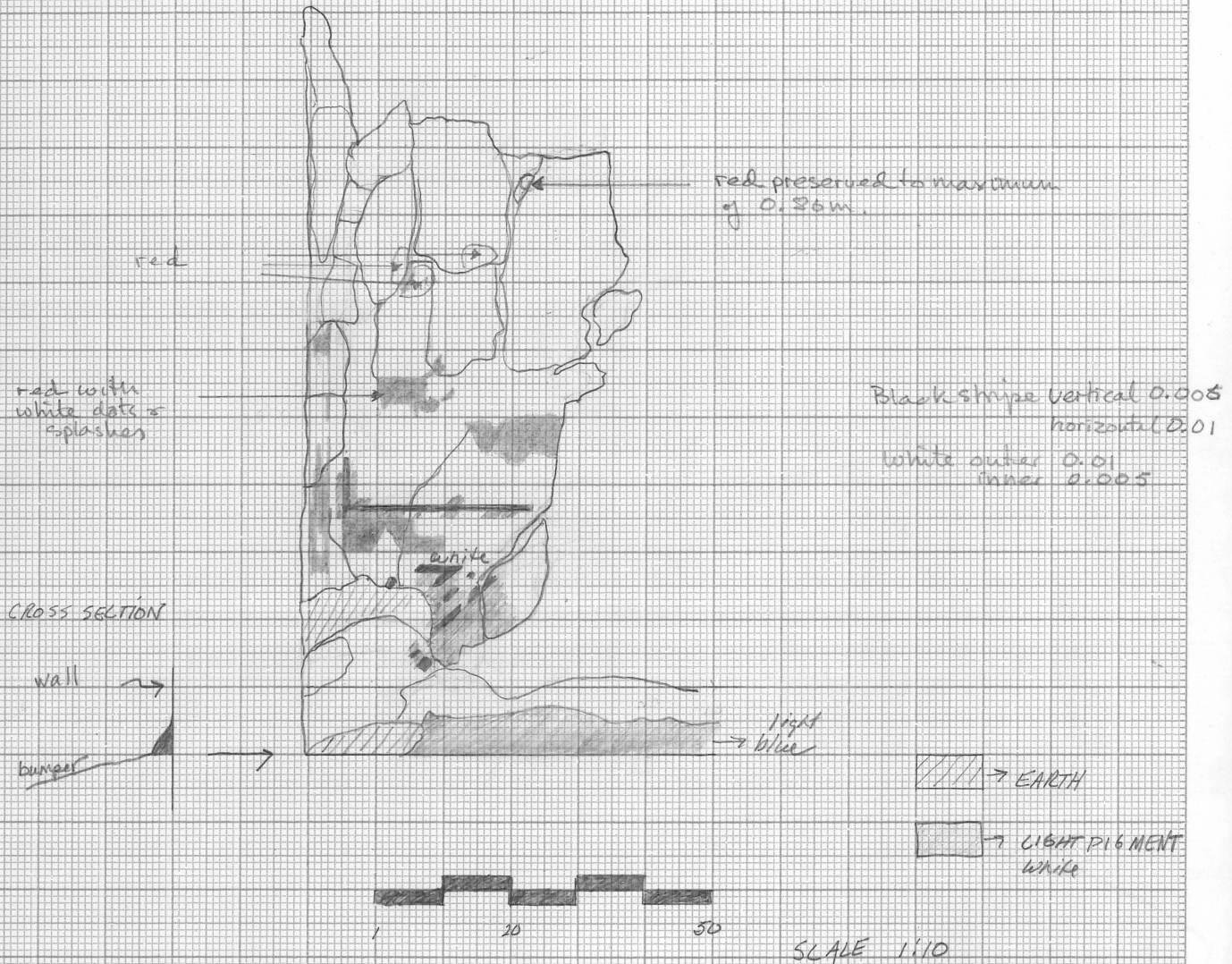

NORTHEAST WALL
ROOM 14

TOP OF WALL

↑ 1.24

↑ 1.25

- light blue
brown = yellow

Light blue w/ deposits

1.40 m

1.50

DETAILED
PLASTER

DETAILED
PLASTER



Panels: Border: Black stripe 0.005-0.006
 white inner 0.008
 white outer 0.008

Scale 1:10

South EAST WALL

Vert. white
w/ 1.5cm
North of top panel 2.5



Vert. Red 3/8 cm

Width of panel 0.70 m.

69.5 yellow panel fr. outer edge of blk. Scale 1:10

EAST ALL

EARTH FILL

TOP OF WALL

RETAINED WALL

RED
RETAINED WALL

Red

completely
Detailed

light blue

1.45

2m

light blue

brick
Drain
opening

brick
bricks

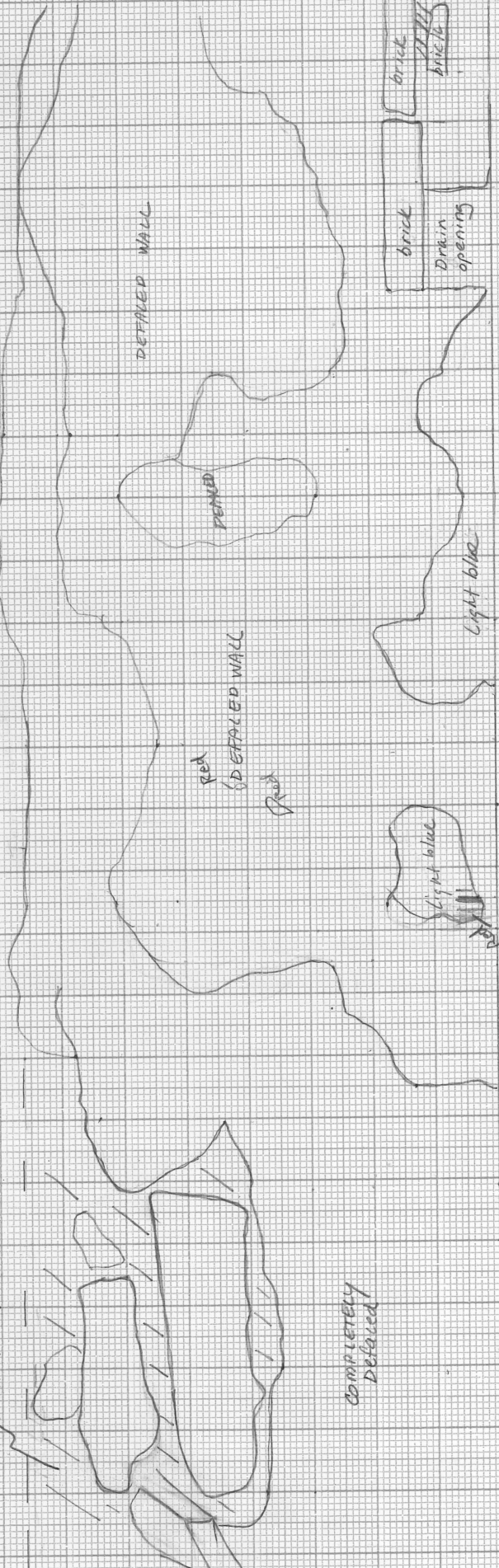

Red spot
1.31 fr. Rt. edge
37 fr. bottom

vent Blk. 9m wide
Vent whlt. 1.2cm wide

Locus 001 1983

East Baths
Room 14

POTTERY

Basket No.	Date Dug	Level	Field Reading	Reg. Sherds
1	June 17		1 frag 1st 1st c? no pottery	
			1 bowl rim white Alentejo cw1	
			1 base? cw3	
			2 amph. handles	
			2 unidentified cw	
		A	2 ARS, plate 3-4th c, v. worn	#351
5	June 20	223.302	6 joining frags of v. burned coarse flat base,	unidentifiable
			1 burned cw rim, cw3?	probably an olla.
6	June 21		1 white Alentejo cw tile or pipe frag.	(discarded)
9	June 22		1 white Alentejo cw1	
			1 silver cooking fabric base	

MATERIAL CULTURE AND OBJECTS

MC	Reg. No.	Assoc. Pottery Basket No.	Identification
		5	1 bone frag - discarded
		6	teeth, bone - discarded

Locus 002

1983

All pottery and TC discarded, not Chronolog. sig.

POTTERY East Baths, Room 14

Basket No.	Date Dug	Level	Field Reading	Reg. Sherds
2	June 17		No pottery	
10	June 22		No pottery	
11	June 23		1 brick frag → discarded 1 frag cw3? discarded 1 burned coonewave handle 2 unidentified cw including basin base 1 cw2? 2 white Alentejo, cw1 including base.	
		discarded		
	771?	R?	1 S. Gaulish relief sherd (Drag 30?) up to mid 2nd ce.	
19A	June 22		1 white Alentejo cw1 1 Sines cooking fabric base	
16	Discarded		1 frag cw3; 1 cw4; 1 unident cwF	

MATERIAL CULTURE AND OBJECTS

MC	Reg. No.	Assoc. Pottery Basket No.	Identification
		10	teeth - discarded
		11	3 bone frags - discarded

East Basin, Rm 14

POTTERY Locus 005 Baskets fm 1983

Basket No.	Date Dug	Level	Field Reading	Reg. Sherds
4	June 20		2 tile frags 1 handle, CW	- Discarded
37	June 21		3 tile frags - discarded	
			1 frag CW 3, v. small - discarded 1 ARS bowl sherd, undatable but before 5th c. SDNR	
20	June 28		1 tile or pipe, 1 pink Aleutyo flat coated rim 1 frag CW 4, 3 frags CW 3	v. small frags. All thrown.
18	June 27		2 cover tile frags 1 white Aleutyo wheel made 3 frag CW 3 including probable rim 2 tile frags - thrown.	
	small v. worn All thrown			

MATERIAL CULTURE AND OBJECTS

MC	Reg. No.	Assoc. Pottery Basket No.	Identification
		4	1 bone frag - discarded
		7	1 iron nail, 1 bone frag - bone discarded
		20	1 iron nail - discarded
		18	2 bone frags, 3 chips - discarded

GENERAL IDENTIFICATION

Fall of bricks and tiles
East Bales, Rm 14

Locus No. 008
Date (s)

221.987, 222.097

Top levels 221.727/807 Top plan ; Bottom levels 221.297 Top plan

Sections _____ Drawn by architect Photo Nos. 83.4.1-9
83.6.8-11
83.10.23

PHYSICAL DATA

83.4.6-14, 83.5.3,4
83.7.3

What is it made of?: Bricks, tiles, earth with some charcoal,
crushed material with brick aggregate painted plaster map, stones,

What size particles? large and small Color 7.5 YR 6/4

Features

Soil Layers

Compass orientation NA

Direction & Degree of slope

_____ courses high; _____ rows wide

Degree of compaction: Loose

Overall dimensions _____

Distribution of particles (e.g., random, laminated, graded bedding)

How was it built?: _____

NA random

STRATIGRAPHIC DATA

This Locus is below Loc. 005 & is above Loc. 009

Lateral extent _____ Max. thickness _____ Touches balk(s) _____

How does this Locus relate to all other loci it touches?:

Earlier than 009
Later than 005

This Locus is contemporary with which loci mentioned above?: None

How was this Locus formed?:

By collapse of roof.

008

POTTERY

Basket No.	Date Dug	Level	Field Reading	Reg. Sherds
23	July 4		3 painted frags, (1 brick frag or pipe frag)	discarded
24	July 5		1 frag ARS, plate 3rd - 4th c. 1 unidentified bowl rim, prob. CW3 + color mark	floor worn 357
27	transhumming bank		Jas rim CW5?	thrown

MATERIAL CULTURE AND OBJECTS

MC	Reg. No.	Assoc. Pottery Basket No.	Identification
		23	2 teeth; 2 bone frags.
		22	17 bone frags; 3 teeth, charcoal samples
		27	knuckle 1 bone frag discarded

GENERAL IDENTIFICATION East Bath,
Room 14

Locus No. 009
Date (s) _____

Top levels 221.297 Top plan /; Bottom levels 220.56 Top plan _____

Sections _____ Drawn by architect _____ Photo No. _____

PHYSICAL DATA

What is it made of?: fine packed earth, large stones, brick
frags, tile frags
What size particles? _____ Color Dark yellowish brown
10YR 4/4

Features

Soil Layers

Compass orientation NA
/ courses high; / rows wide
Overall dimensions _____
How was it built?: _____

Direction & Degree of slope level
Degree of compaction: Hard
Distribution of particles (e.g., random, laminated, graded bedding)
Random

STRATIGRAPHIC DATA

This Locus is below Loc. 008 & is above Loc. floor of pool

Lateral extent _____ Max. thickness _____ Touches balk(s) _____

How does this Locus relate to all other loci it touches?:
Earlier than 008

This Locus is contemporary with which loci mentioned above?:

How was this Locus formed?:

Accumulation of fill after East Bath had
been abandoned. Fill washing in; tiles & bricks
being thrown in or falling in.

009

POTTERY

Basket No.	Date Dug	Level	Field Reading	Reg. Sherds
25	July 5		1 TSH frag - not datable	
			1 cw3	
R		R	2 joining frags	base of basin
			3 joining frags related to cw4	" " "
R		R	3 joining frags	imported 354
			pitcher neck + everted lip	flaring mouth
			1 frag silver chry fabric	
			1 unidentified with grey core	cream colored ware
#349 R	Late 1st - 3rd cen 4th c.)		frags of 4 diff	Roman amphoras:
			1 handle of	Pelischet 46
#353 R			1 handle with	amphora stamp.
			1 unidentified	coarse w
26	July 6	Discarded	1 tile or pipe rim	
			1 white Alentejo	
			2 joining frags	unidentifiable cw

MATERIAL CULTURE AND OBJECTS

MC	Reg. No.	Assoc. Pottery Basket No.	Identification
		25	15 bones
		26	4 bone chips - discarded
			3 joining frags from
			jaw bone with tooth

Room 14, 1984
1985

Mirobriga 1984

Room 14

May 28

Began with 4 workmen cleaning up fallen earth and cutting weeds.

Iron nail from fill fallen onto top of SE wall. Removed stone wall put up to protect painting on NE & SE wall over the winter, leaving 1"-2" layer of earth over surface.

Removed loose bricks and tiles on fill at ^{221.70} in North part of trench, ~~to~~ ¹ or saving them all in Room 13. Made smooth surface in fill to facilitate work or painting. Cleared out pool area excavated in 1983 full ground, water and earth fallen in from scarp over the winter. Constructed makeshift shelter with black plastic and began removing potchise layer of earth.

Bricks removed: 30-40 bricks ^{mp} from vault - flat narrow type.
ca 34 large mps of flanged bricks
6 buckets smaller mps of same type.

Nimbraga, 1984

June 25, Kart Baku, Room 14

Loc 008

Basket 1

Began digging pit of pool in Room 14, left last season, ca 2.00m width N/S. Restoration of wall painting completed except for final touch up and possible repainting - Top level for basket 1 ca. 221.70. Still some bricks from roof fall.

Removed two fallen fragments of wall plaster from SE ledge at 1.00m from S. corner. Had fallen off during winter.

Dug a channel for drainage of water along the SE face of the SE wall exposing preserved top of face. Some bricks built in at this level, perhaps indicating that break in this wall was for a brick-built water channel. Wall destroyed more extensively in this area on SE side and packed with fragments of flooring, large stones

with Basket 1 fragments of fallen wall plaster in the north corner in an area 1.30m E/W, including some with green paint and one that forms an irregular large patch of fallen fragments at 1.10m from N corner resting against wall of pool.

At 221.57 reached top of first step.

Bricks from vault still coming up in this

used, especially in east side. Many large stones also in this area. Backing fragments from this wall in great quantity, but in very small fragments. One screen wall brick.

As we dig to the east, it becomes apparent that there is fallen plaster all around the edge of the pool, apparently resting on about 221.57, the level of the top step.

Locus 008
Basket 2 A large fallen fragment, mainly red, had fallen face up at 1.52 m from NE wall and 0.87 m from top step. Removed with Basket 2.

Continued removing fragments from base of NE wall within pool. Mainly red with white splashes, yellow with red, but some green.

June 26
Locus 008 Continued removing fallen wall plaster in large chunks (see plan)

June 27
Locus 008 Continued removing wall plaster beginning at base of SE wall. A great deal of mortar above and below the plaster fragments (sample of mortar saved). Fragments sometimes fell face to face, some back to back. No. 54 has green

Ninbriga 1984, Room 14

June 27 paint and v. large yellow w/ red area. No. 55 - roof tile fragment came up with it.

June 28 continued removing fallen wall plaster, working in east corner. Some bricks and tiles (4-5), a few bones.

Locus 009
Basket 3 AT 221.29 N / 221.56 E / 220.92 S all fallen plaster removed. Began digging 009. Shells, bones, roof tiles, some brick. 2 frags red painted plaster. Fragment of plain marble resetment h. 0.14 m., Th. 0.029 m. Charcoal. Fine, chocolate brown silt. Plaster nos 78 and 79 with this basket. 3 large stones from east end of trench:
0.38 x 0.32 x 0.15; 0.28 x 0.33 x 0.33;
0.36 x 0.23 x 0.20, fragment of flooring or pool bedding (brick aggregate and mortar). Reached level of second step at end of day 221.11.

10 small frags of tegulae

100 frags of imbrices

7 screen wall bricks (0.07 x 0.05) none complete.

1 brick from vault W 0.155, Th. 0.03

7 frag. bricks Th 0.05 (one with notch at

top :- wt from room) Th. 0.055
45% frags bricks Th. 0.04 - 0.045
2 1 narrow brick W. 0.11, Th. 0.048

June 29

Locus 009 continued with Locus 009, top level
Basket 4 22.11. At ca. 220.80m three frag-
ments of plaster with green paint. 2
beaching fragments, 6 other frags. In east
side of trench 2 frags of red painted
plaster - light red. Other frags listed as
Plaster "82". Many bricks and tiles in this
level including many with width 0.28,
Th. 0.05. No complete ones preserved.
In east corner 0.45 x 0.38 fallen piece
from top of wall preserving set back. Plaster
no 83. Had fallen face up with set back
almost at r. angle to SE wall. Level 220.82.
At end of day ca. 0.12m of pit left
in east corner. Floor of pool reached in
remainder of area.

Bricks and tiles from this basket:

Tegulae: 13 frags

Imbrices: 52 frags + 13 other frags

Bricks: screen wall, 1 frag 0.065 x 0.05
others - (none complete)

W. 0.28, Th. 0.045 (ca. 55 frags saved)

Quobinga 1984 East Bathn
Room 14

June 29 cart

Bridle cart

greatest pres. L. 0.28 (17 frags.)
maj. w. 0.28, Th. 0.05, max P.L. 0.28_n
(0.27-0.29)

w. 0.28 (1 ex.) Th. 0.04 (10 frags)

w. 0.165 (1 ex.) Th. 0.04

w. 0.205 (1 ex.) Th. 0.04

July 2.

Locus 009
Basket 5

no pottery

Small section of pit remaining in E.
corner removed today. Top level
220.920 Bottom level - floor of pod.

Bridle from 1984 excavation of Room
14 stored against the NW wall of
the service area. Tiles piled
separately from bridle

July 3

A Togg was erected over the
NE wall to protect the wall
plaster in situ.

Miróbriga 1985 - Room 14

June 10 -

Began work on conservation of loose plaster fragments from previous seasons. The system of numbering the plaster in groups was applied to the 1983 and 1984 fragments that had locus nos and basket nos, so that less numbers need be written on the back of each fragment.

June 27

The water channel dug behind the SE wall of the pool at the end of the 1984 season had filled up during the winter. It was cleaned out and the scarp was cut back to form a slope. Another 6" probably ought to have been taken off at the top.

1-84

Room 14

1984

Top

221.56 S

June 27, below nos 26-31

June 25

221.66 E com

Bottom -
221.67 E com

34

33 (32)

86

87
Basket
1
east

June 28 below no. 34

Top
221.61 E com 77

Bottom
221.49 E com.

June 26, 27, 28

top. 221.71

bottom 221.66 E corner
221.56 S.

31 30 29 28 27 26

76 75 74 73 72 71

70 69 68 67 66 65 64 63 62 61 60 59 58 57 56 55 54 53 52 51 50 49 48 47 46 45 44 43 42 41 40 39 38 37 36 35

edge of
first step

91
Basket
2

88
Basket
1
north

89

June 29

Level 220.820

84
83

edge of first step

June 28
Basket 3
Locus 009

79

221.29 top
level 221.09 bottom

1:25

78

80

81
82

June 29 # 82
220.97
220.74

009
Basket 4

GENERAL IDENTIFICATION

E. Butler, Room 14

Locus No. 008

Date(s) June 25, 1984

Top levels 221.70 Top plan _____; Bottom levels ^{221.22N}221.56E Top plan _____
_{220.91S}

Sections _____ Drawn by architect _____ Photo No. _____

PHYSICAL DATA

What is it made of? filled plastic bags, bricks from vault, large stones

What size particles? _____ Color _____

Features

Soil Layers

Compass orientation _____

Direction & degree of slope _____

____ courses high; ____ rows wide

Degree of compaction _____

Overall dimensions _____

Distribution of particles (e.g., random, laminated, graded bedding)

How was it built?

STRATIGRAPHIC DATA

This Locus is below Loc. 005 and is above Loc. 009

Lateral extent hits pool Max, thickness _____ Touches balk(s) _____

How does this Locus relate to all other loci it touches?

This Locus is contemporary with which loci mentioned above? none

How was this Locus formed?

fall of wall plaster

GENERAL IDENTIFICATION

East Bath, Room 14

Locus No. 009
Date(s) June 28, 29

Top levels ^{221.29N} ~~221.56 E~~ ~~220.92S~~ Top plan _____; Bottom levels ^{220.58} ~~220.56~~ Top plan _____

Sections _____ Drawn by architect _____ Photo No. _____

PHYSICAL DATA

What is it made of? fine, chocolate brown silt, shaly, bones, red tile
frag, some wall plaster frags.

What size particles? _____ Color chocolate brown.

Features

Soil Layers

Compass orientation _____

Direction & degree of slope _____

_____ courses high; _____ rows wide

Degree of compaction _____

Overall dimensions _____

Distribution of particles (e.g.,
random, laminated, graded bedding)

How was it built?

STRATIGRAPHIC DATA

This Locus is below Loc. _____ and is above Loc. _____

Lateral extent _____ Max, thickness _____ Touches balk(s) _____

How does this Locus relate to all other loci it touches?

later than pod
earlier than 008

This Locus is contemporary with which loci mentioned above?

How was this Locus formed? sitting up of pod after
abandonment of building

POTTERY

Basket No.	Date Dug	Level	Field Reading	Reg. Sherds
3	June 28		1 burned frag of	pipe-thrown
			1 unidentified c. w. ring handle	-thrown
			1 frag CW3?	
4	June 29		2 joining & 1 non-joining frags of	same or another pipe + diameter of 0.7cm
			7cm - thrown	
			9 joining frags of	bottom of unidentified
			coarse ware flat-based vessel	
			1 frag white Alentejo tile - thrown	
			1 sherd Ching fabric thick coated in	ARS
			1 frag 3rd-4th c	
			2-6 joining & non-joining frags of small	cooking pot + half like profile
			1 (CW) orange handle	

MATERIAL CULTURE AND OBJECTS

MC	Reg. No.	Assoc. Pottery Basket No.	Identification
		4	1 cow horn.
			25 bone frags
			1 jaw frag with teeth.
			1 oyster shell.
		3	19 frags of bone
			1 tooth
			1 frag of oyster shell, w/o oyster.

Painted Plates

East Baths, Room 14
 Painted Plaster from NE wall
 POTTERY

6/86 Discarded ~~the~~ plaster fragments
 were dumped behind the
 chapel.

1983

Basket No. Date Dug Level Field Reading Reg. Sherds

9

June 22

002

13 plain red

2 Plaster no
 95

*

2 joining frags with broad red
 stripe and yellow back
 red $\frac{1}{2}$ max w. 0.035

Neg C 85.4.15

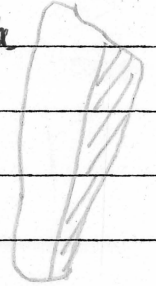

17 thrown

-

40 yellow with red design
 including one with mostly yellow
 and red on sides

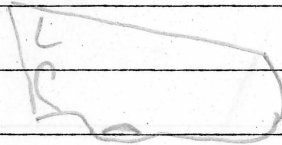

P.W. 0.08

and one with traces of green on per-
 edges

*

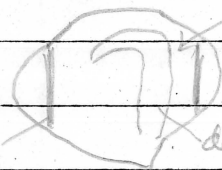

greenish yellow

P.W. 0.075

red darker yellow

MATERIAL CULTURE AND OBJECTS

* 2 frags with red paint over pale
 blue

MC Reg. No. Assoc. Pottery Basket No. Identification

MC	Reg. No.	Assoc. Pottery Basket No.	Identification
			* 2 white background with dark red stripe and diagonal pink lines

East Baker, Rm 14
 Painted Pottery from NE wall
 POTTERY

Basket No.	Date Dug	Level	Field Reading	Reg. Sherds
13 (2)	June 24	002	1 frag plain red	} worn } brown
			1 frag pale with red stripe	
			12 frags too encrusted to distinguish color - plain backing - brown	
13 (1)		-	76 pale blue including some large frags max L. 0.12. On several thickness of ptd layer = 0.007 - 0.009; others apparently thicker 0.02, but possibly ptd layer is not visible	
= Plaster no 98		54 worn frags brown	1 black	
Neg C 85.4.10			2 red with white dots	
			10 plain red - 2 worn frags brown	
			1 white with red stripe	
			4 pink? background with darker pink & red lines including 1 with black stripe	
			3 plain white (1 has small blob of red on edge?)	

MATERIAL CULTURE AND OBJECTS

Assoc. Pottery Basket No.

MC

Reg. No.

Identification

P19

2 joining frags of pale blue background with green, yellow & dark red marbling; 1 yellow & blue

P18

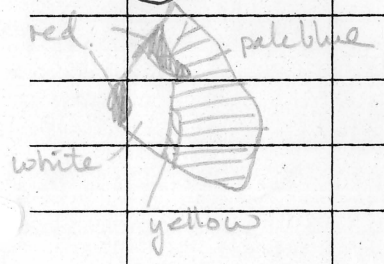

cast from

1 white & green frag
 2 frags pale blue, white, yellow & dark red
 6 frags green, red and blue probably similar to 2 joining frags

East Baths, Room 14
Painted Plaster from NE wall

P20-23

POTTERY

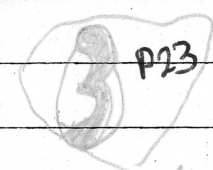
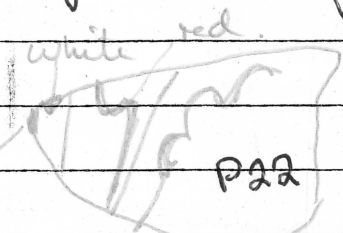
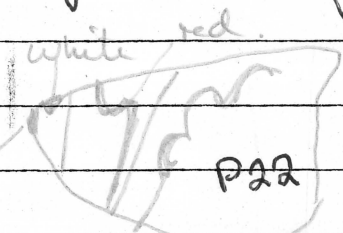
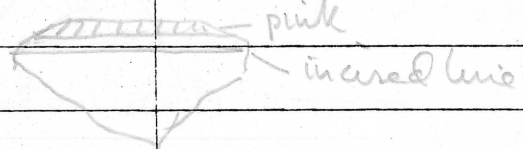
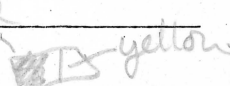
Basket No.	Date Dug	Level	Field Reading	Reg. Sherds
13 (3)	June 24	002	20 66 pale blue including 2 joining worn & brown	
= Plaster no 99			33 yellow + red design including strown	
Neg C 85.4.17			one 	
			and one 	
			1 with incised line, dark red & pink	
			1 small frag red, white & black	
			2 frags pink	
			1 yellow, red & white	
			4 frags (2 + 2 joining) of red, green, white; 2 similar of lower edge (white 0.007)	
			2 frags + black & white stripes & dark red	
			1 dark red with white stripe & incised rouletting	
			3 frags black	

MATERIAL CULTURE AND OBJECTS

MC	Reg. No.	Assoc. Pottery Basket No.	Identification

P21

red + white dots

green & dirty yellow + white dots

P20

white background diagonal red dark red

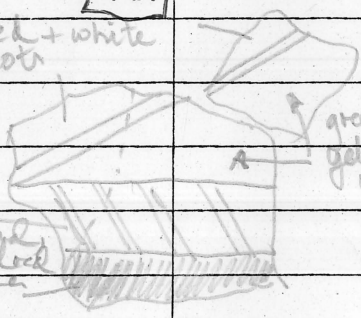

East Baths, Room 14

Painted Plaster from SE wall, Nend

POTTERY

Basket No.	Date Dug	Level	Field Reading	Reg. Sherds
19	June 27	002	2 2 plain red -	1 discarded
= Plaster no 105			4 pale blue with red oves	
Neg C 85.4.19			12 pale blue -	7 discarded
			3 pale pink or white background with dark red stripes	
			1 dark red background with white spots	
			2 possible dark red with white spots	
19 (2)		All discarded	10 frag of backing	
			13 frag of yellow with red design ^{very worn}	
19 (3)			41 210 frag pale blue, v. worn -	40 thrown
= Plaster no 106			10 8 frags green	
Neg C 85.4.19			3 2 yellow with red design -	thrown v. small
			1 yellow with red stripe	
			1 dark red	
			6 8 pink	
			15 backing frags, discarded	
			2 not visible	
			1 blue with red stripe?	

MATERIAL CULTURE AND OBJECTS

MC	Reg. No.	Assoc. Pottery Basket No.	Identification
19(4)	July 1	002	5 small green frags, worn + v. small
		discarded	54 pale pink, worn + v. small
			34 plain backing frags, discarded

