

MIROBRIGA

WEST BATHS

NW of Rm 3
Road
Room 2
Exterior, SE

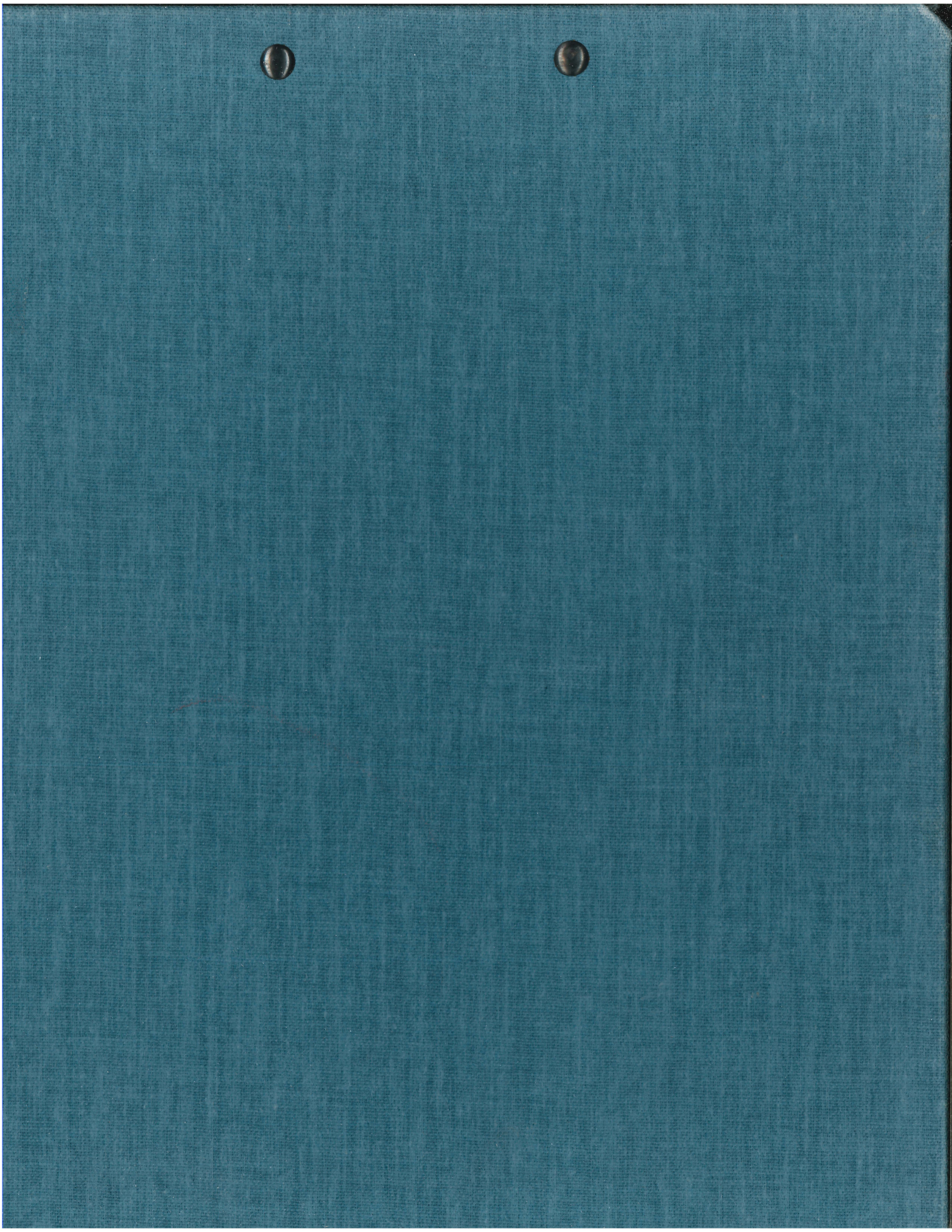



83-281 3 Ring
83-289 3 Ring with Clip
Made in U. S. A.

NW of Rm 3

Airbriga 1983 - West Baths. NW of Room 3 between spur walls.

June 14. Workmen began clearing fill. Locus 001.
 Basket 1 NE face of continuation of S spur wall exposed to NW scarp, apparently bonding with retaining wall of NW courtyard. At end of day, reached bottom of level, i.e. NW extent, of waterproofing already exposed between spur walls up against NW face of wall of Rm 3. Top level of ^{S spur} wall 226.184

June 15 Workmen continued removing fill. Locus 001 coming down on top of a retaining wall ^{for water proofing} parallel to NW wall of Rm 3.
 Basket 2 Top level: 226.092 N, 225.832 S
 Level of fill at end of day: 225.882 S, 225.852 N.

June 17 Student cleaning walls - retaining wall of NW courtyard and top of S spur wall which bonds with it.
 Basket 3

Mirobriga 1983
 NW of Km 3 when spur walls
 June 17, 1983

LOCUS 002 PB3

Photos 83.2 4
 83.2 5
 83.2 6

(on the 20th)
 Begin removal of more
 compact fill in a 1m. test
 trench bordering the ~~N~~ face of the
 spur wall + the waterproofing which
 runs ~~NE~~ ^{NE}. Soil is compact,
 silt size + Munsell 10 YR 5/3
 brown. Soil contains inclusions of
 chestnut, brick + stone. The purpose of
 this test is to ascertain + articulate
 the Roman soil or possibly surface
 level here. The datum point is
 226.526 + located as a nail
 in the SW extreme of the spur wall.

June 20, 1983

LOCUS 002 PB3

Top 225.876, 225.906

Bottom 225.816

MC 1 frag lead bone
 2 frags glass

numerous pot frags

LOCUS 002 PB4

Top 225.816

Bottom 225.746

MC Toys
 Pottery - fluted pottery frags

Begin actual excavation of locus
 002. Lg quantities of pottery
 frags coming out of this very hard
 level.

Bedrock appears on west bank
 along w/ a foundation course for the
 N face of the spur wall (which
 forms the S bank of the area.
 Waterproofing also appears on
 bumper forming the E bank.

Muobriga 1983
NW of km 3 btwn. spur walls
June 21, 1983

PHOTO: 83.2.11 (also colour)
C83.2.1

New LOCUS 003 PB5
Top: 225.764
Bottom: 225.666 (-)

Perhaps a more compact +
older level of soil. Stone
sole of spur wall appears (top
of sole) + also bedrock in the
western portion of the area. Soil
is very compact. (Munsell 10
YR 4/4 dk. yellowish brown)
with pebble size inclusions of
pink stone, sandstone + schist.

June 29 1983

LOCUS 003 PB5
Top: 225.764

Same as above, will begin
removing 003 so as to expose
the remainder of bedrock
003 completely removed
showing bedrock in western
half of area. Sole for spur
wall has been cut into this
(see Top Plan#) In
the eastern half of the area a
surface of 90% bedrock 10%
earth covers the area. Here the
schist breaks horizontally,
while in the w. half it
breaks vertically w/ no east
included.

LOCUS 004 - Bedrock
Top: 225.836

LOCUS 005⁵ PB6 - schist + earth

unexcavated

Top. 76 225,666

Mussell - same as schist of

NO POTTERY 225,676

004 - some earth - 85% schist

2.5 yr 6N5 - grey

FINAL PHOTOS:

83.6.6 colour C.83.5.2

83.6.7

Handwritten notes at the top left of the page, including the number '100' and some illegible text.

Handwritten notes at the top right of the page, including the number '100' and some illegible text.

Handwritten notes in the middle right section of the page, including the number '100' and some illegible text.

223.67

The area NW of Room 3 between the spur walls includes two walls running north-south (northernmost runs 1.54 m. width .65 m., the southern 2.86 m width .46 m) which do not bond into the western face of the NW wall of Room 3. The wall construction is dry-wall, a mud mortar adhering to the generally large flat stones which are chinked in spaces w/ smaller stones. Sclerite is rarely found to be used in the construction of these two walls. Large stones average in size - .54 x .27 x .07 m. - .40 x .16 x .28 m. the smaller measure .16 x .13 x .15 m - .15 x .18 x .07 m. The northernmost spur wall is preserved to 5 courses while the southern to only two badly damaged courses. (Levels N. wall architect's plan S. wall - ~~226.264~~ 226.264)

Between the two spur walls an area of waterproofing, (similar to that just N of the N wall of Rm. #3), runs up to both spur walls and to the western face of the NW wall of Rm. #3. The waterproofing is provided with a western boundary by a stone curb, also running between the two spurs. The waterproofing is 1.55 m. wide and 4.45 m. in length. This surface slopes up to the W. face of the NW wall - Rm. #3 approx. 20°. The surface consists of a white cement mortar w/ pebble size brick aggregate. (Top level 225.976 m.)

The curb which forms the western boundary for the waterproofing runs a length of 4.45 m. and thus up to both spur walls. It is made of 19 stones, flat and set on end, measuring .30 x .10 m + .35 x .14 m. The stones are of the same type used in the walls - pink or yellow colour. At 1.50 m. south of the northern spur, running for 80 cm., is a patch of cobble-size stones (w/in the H₂O-proofing), which must be the exposed stratum for the pebble cement surface. (Top level of curb 225.916 m.)

The 1 meter test area (see Final Top Plan) exposed the western face of the curb. This was found to be covered w/ a white cement + small pebble mortar of the same material used for the 1/2 area of H₂O-proofing. (Top 225.916 - Bottom 225.816 m)

The aggregate of this waterproofing is much finer/smaller than that of the larger area. The bottom level of this waterproofing should provide evidence for the ancient ground level. Also exposed w/in the test area, a stone foundation sole* (Top 225.756m) of cobble-size pink stone (See Final T.P). Bedrock, (FINAL TP) seems to have been cut back to insert the sole and perhaps cut in the remainder of the test area so as to facilitate construction of the curb, H₂O-proofing etc.

* dimensions of stones

.17 x .15 x .05m

.15 x .10 x .06m

TOP PLAN #1

MIDOBKIGA '83
 JUNE 17, 1983
 NW of Km. #3 BETWEEN SPUR
 WALLS
 AMY L. MEHLIN

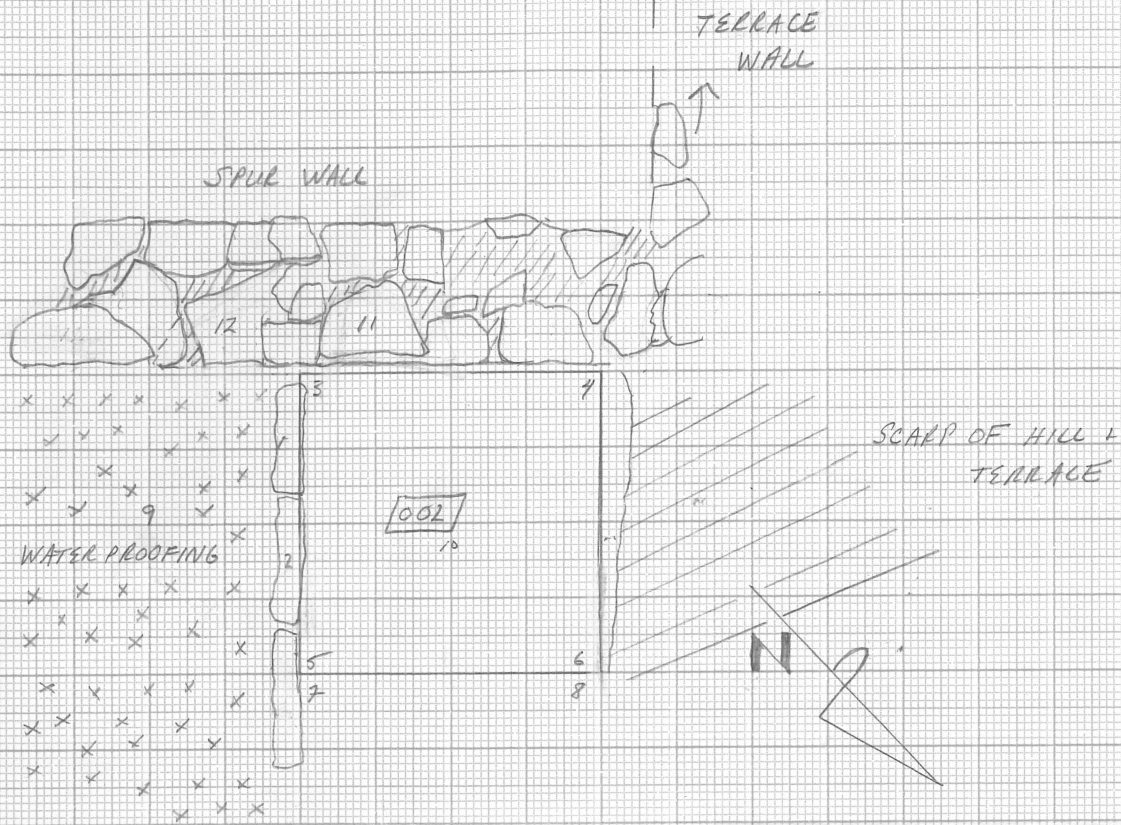

- 1. 225.966
- 2. 225.916
- 3. 225.976
- 4. 225.896
- 5. 225.906
- 6. 225.876
- 7. 225.926
- 8. 225.876
- 9. 225.976
- 10. 225.876
- 11. 226.264
- 12. 226.016

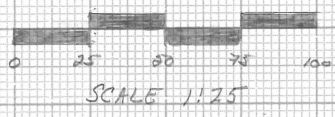

FINAL TOP PLAN

MIROBLIBA 1983

6/29/83

NW of Rm. 3 from
spur walls

Amy L. Mecklin

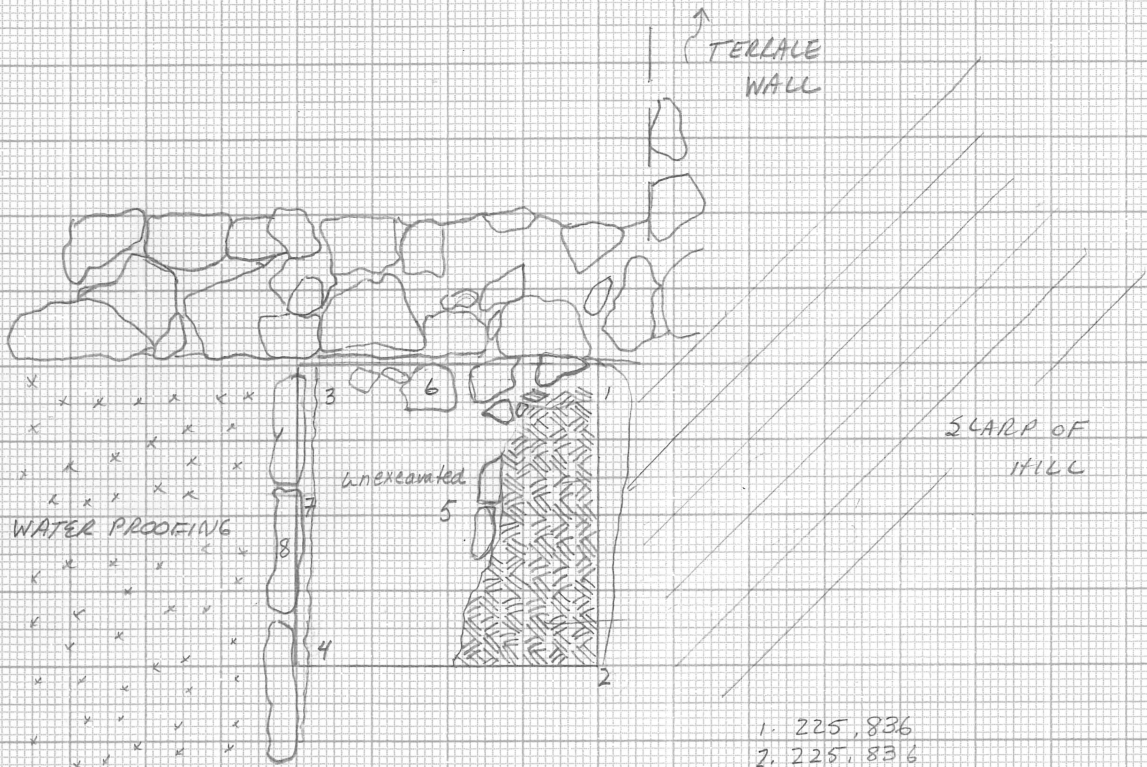

SCALE 1:25

- 1. 225,836
- 2. 225,836
- 3. 225,666
- 4. 225,656
- 5. 225,676
- 6. 225,956
- 7. 225,916
- 8. 225,916

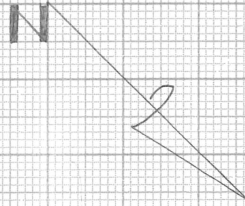

Mirabriga 83 184
112
.72

GENERAL IDENTIFICATION West Bath, NW of
 Run 3 between spur water.

Locus No. 001
 Date (s) June 14, 1983

Top levels 226.184 S Top plan X; Bottom levels 226.112 S Top plan Y
226.384 N 226.186 N

Sections none Drawn by architect no Photo No. no

PHYSICAL DATA

What is it made of?: Earth fill, bricks, stones

What size particles? _____ Color _____

<u>Features</u>	<u>Soil Layers</u>
Compass orientation <u>NE/SW</u>	Direction & Degree of slope <u>down to SE</u>
<u>X</u> courses high; <u>Y</u> rows wide	Degree of compaction: <u>loose fill</u>
Overall dimensions _____	Distribution of particles (e.g., random, laminated, graded bedding)
How was it built?: _____	<u>random</u>

STRATIGRAPHIC DATA

This Locus is below Loc. — & is above Loc. 002

Latera extent entire area Max. thickness .72 m Touches balk(s) all

How does this Locus relate to all other loci it touches?:

This Locus is contemporary with which loci mentioned above?:

How was this Locus formed?:

wash from hillside

POTTERY

Basket No.	Date Dug	Level	Field Reading	Reg. Sherds
1	6-14-83	001	1 base + 38 sherds + 1 handle, also 1 rim of all wheel made.	CWF 3;
1	6-14-83	001	1 rim finer version CWF 3	
"	"	"	2 frags. of CWF 4 - very thick.	
"	"	"	3 frags. of White Alentejano CWF 1	
"	"	"	3 unidentified coarseware frags., including one table amphora handle	
"	" latest piece	★	1 frag. African Red Slip, very worn	} 3rd-4th c.
"	"	★	6 joining frags. - Sims Cooking Ware pan w/ rounded intern rim possibly hand made	
"	"	"		Date ?
"	"	"	1 rim pan	
"	"	"	2 joining frags. ea. of 2 bowl bases	
"	"	"	1 wall frag	

MATERIAL CULTURE AND OBJECTS

Assoc. Pottery

MC	Reg. No.	Basket No.	Identification
FE		1	3 frags - one a nail
B		1	1 jaw (partial) 2 frags bone
B		2	4 frags. bone

Mirobriga 1983
GENERAL IDENTIFICATION NW of Km 3 btwn
Spur walls

Locus No. 002
Date (s) 6/17/83

Top levels 225.876 Top plan #1 ; Bottom levels 225.764 Top plan H

Sections none Drawn by architect no Photo No. ~~000~~ 83.2.4
83.2.5

PHYSICAL DATA

83.2.6

What is it made of?: earth w/ inclusions of schist, brick, tstone

What size particles? ^{inclusions - pebble size} earth - silt size Color earth 104R 5/3 'brown'

Features

Compass orientation NE/SW
___ courses high; ___ rows wide
Overall dimensions _____
How was it built?:

Soil Layers

Direction & Degree of slope no
Degree of compaction: very compact
Distribution of particles (e.g., random, laminated, graded bedding)
Random

SEE SUMMARY }

STRATIGRAPHIC DATA

This Locus is below Loc. 001 & is above Loc. 003

Lateral extent entire area Max. thickness 1.12m Touches balk(s) all

How does this Locus relate to all other loci it touches?:

~~Below 001 & 003~~
lies below 001 in entire area

This Locus is contemporary with which loci mentioned above?:

~~none~~ 001

How was this Locus formed?: rainwash & fill → at level of bottom edge of bumper - perhaps originally the ancient ground level.

POTTERY

Basket No.	Date Dug	Level	Field Reading	Reg. Sherds
3	6-17-83	002	1 coarse white fabric roof tile	- discarded
3	"	"	1 ? Iron Age tile	
3	"	"	2 frags. local Roman H ₂ O pipe	
3	"	"	1 unidentified frag	
	"	"	18 joining + nonjoining frags. CWF 3 wheel made	(worth mending?)
3	"	"	6 frags. Roman H ₂ O pipe including the rim	
"	"	"	3 frag. - Sines Looking Fabric including bowl base = Basket 1	
"	"	"	plus 2 joining rim frags = pan in Basket 1	
"	"	"	1 wall frag. of same fabric w/ exterior red slip	
"	"	"	25 frags. of at least 3 CWF 3 wessels, including one	
"	"	"	rim of an olla. Rim frag. very thin w/ grey comp but probably not Iron Age.	
			6 sm. chips of African Red Slip incl. rim	- undatable

MATERIAL CULTURE AND OBJECTS

MC	Reg. No.	Assoc. Pottery Basket No.	Identification ^{late} ★
GS	G-20	3	2 colourless frags. 1 a rim - registered
PB		3	1 lead frag. ? pipe
B		3	7 bone frags, 1 tooth.

Mudobnisa 1983
GENERAL IDENTIFICATION NW of Rm 3 btwn
spur walls

Locus No. 003
Date (s) 6/21/83 6/29/83

Top levels 225.764 Top plan no; Bottom levels 225.666 ~~00000000~~ Top plan —

Sections no Drawn by architect no Photo No. 83.2.11
C83.2.1

PHYSICAL DATA

What is it made of?: earth, schist, stone + brick

What size particles? earth silt size - pebble size Color 10 YR 4/4 dk. yellowish brown
inclusions

<u>Features</u>	<u>Soil Layers</u>
<p><i>SEE Summary</i></p> <p>Compass orientation _____</p> <p>_____ courses high; _____ rows wide</p> <p>Overall dimensions _____</p> <p>How was it built?: _____</p>	<p>Direction & Degree of slope <u>no</u></p> <p>Degree of compaction: <u>very compact</u></p> <p>Distribution of particles (e.g., random, laminated, graded bedding) <u>random</u></p>

STRATIGRAPHIC DATA

This Locus is below Loc. 002 & is above Loc. unexcavated + 004 ^{bedrock →}

Lateral extent 39cm + 1m. Max. thickness 10 cm. Touches balk(s) N-S-W

How does this Locus relate to all other loci it touches?:
lies under 002 + above 004 + unexcavated

This Locus is contemporary with which loci mentioned above?:
earlier than 001 + 002 also later than 000 + 004

How was this Locus formed?:
fill + rainwash

GENERAL IDENTIFICATION

NW of Rm 3
broken spur walls

BEDROCK
Locus No. 004
Date (s)

Top levels _____ Top plan _____ ; Bottom levels _____ Top plan _____

Sections _____ Drawn by architect _____ Photo No. _____

PHYSICAL DATA

What is it made of ?:

What size particles ? _____ Color _____

<u>Features</u>	<u>Soil Layers</u>
Compass orientation _____	Direction & Degree of slope _____
____ courses high; ____ rows wide	Degree of compaction : _____
Overall dimensions _____	Distribution of particles (e.g., random, laminated, graded bedding)
How was it built ?:	

STRATIGRAPHIC DATA

This Locus is below Loc. _____ & is above Loc. _____

Lateral extent _____ Max. thickness _____ Touches balk(s) _____

How does this Locus relate to all other loci it touches ?:

This Locus is contemporary with which loci mentioned above ?:

How was this Locus formed ?:

GENERAL IDENTIFICATION NW of Rm 3
between spur walls

Locus No. 005
Date (s) 6/183

Top levels 225.676 Top plan -; Bottom levels 225.676 Top plan FINAL

Sections _____ Drawn by architect no Photo No. 83.6.6
83.6.7

PHYSICAL DATA

83.5.2

What is it made of?: earth + schist

What size particles? schist - silt size Color 2.5YR 6.5 grey

<u>Features</u>	<u>Soil Layers</u>
<u>SEE FINAL</u>	
Compass orientation <u>Top Plan</u>	Direction & Degree of slope <u>down to E</u>
____ courses high; ____ rows wide	Degree of compaction: <u>very compact</u>
Overall dimensions _____	Distribution of particles (e.g., random, laminated, graded bedding)
How was it built?:	<u>random</u>

STRATIGRAPHIC DATA

This Locus is below Loc. 001 002 003 & is above Loc. unrelated

Lateral extent SEE FINAL PLAN Max. thickness 10 cm Touches balk(s) NES

How does this Locus relate to all other loci it touches?:
Runs up to cut bedrock - below 001 002 + 003 (fill layers)

This Locus is contemporary with which loci mentioned above?:
none
earlier than 001, 002, 003

How was this Locus formed?:
perhaps schist chips from bedrock cutting for area's construction - fill

June 27 NW of Rm 3, West Bath.

Opened a new trench through waterproof packing between spur walls. 1-m. wide and the full width of the waterproofing.

Locus 001 Brick frags. (L. 0.035 maj.) and some
Basket 1 white mortar. Top level 226.06 at wall
of building, 225.89 at outer/NW edge.

Locus 002 Top level 225.83 / ^{NW edge} 226.05
Basket 2 Packing of stones and earth, stones ca.
0.10 m. h. Some larger L. 0.16.

Locus 003 Top level 225.69 / ^{center} 225.94 ^{SE} upw / 225.79 NW
Basket 3 Skill packing of stones, but perhaps more earth.
No pottery

June 28 continued digging same fill

003
Basket 4

004 Most of large stones removed, reached
Basket 5 an earth level, top level 225.61 E / 225.55 W.
No pottery

July 2 Decided to go deeper here, at least to
Locus 004 level of floor reached north of Room 3. Took
Basket 6 an 0.80 m. cut at NW end of trench.
2 course stonew, 1 brick frag.
At end of day 0.16 m. lower than floor
N of Room 3. Brown earth no sign of
floor level. Final level 225.34 m

West Basin 1984

GENERAL IDENTIFICATION

NW of Room 3

Locus No. 001

Date(s) June 27

Top levels ^{225.89} 226.06 Top plan _____; Bottom levels ^{225.83} 226.05 Top plan _____

Sections _____ Drawn by architect _____ Photo No. _____

PHYSICAL DATA

What is it made of? Hand made brick masonry, white mortar

What size particles? 0.035 Color _____

<u>Features</u>	<u>Soil Layers</u>
Compass orientation _____	Direction & degree of slope _____
____ courses high; ____ rows wide	Degree of compaction _____
Overall dimensions _____	Distribution of particles (e.g., random, laminated, graded bedding)
How was it built?	

STRATIGRAPHIC DATA

This Locus is below Loc. _____ and is above Loc. _____

Lateral extent _____ Max, thickness _____ Touches balk(s) _____

How does this Locus relate to all other loci it touches?

This Locus is contemporary with which loci mentioned above?

How was this Locus formed?

Tirobaga 1984

GENERAL IDENTIFICATION

NW of Room 3

Locus No. 002

Date(s) June 27

Top levels ^{225.83} 226.05 Top plan _____; Bottom levels ^{225.94} ^{225.69} 225.79 Top plan _____

Sections _____ Drawn by architect _____ Photo No. _____

PHYSICAL DATA

What is it made of? Shower, earth

What size particles? _____ Color _____

<u>Features</u>	<u>Soil Layers</u>
Compass orientation _____	Direction & degree of slope _____
____ courses high; ____ rows wide	Degree of compaction <u>hard</u>
Overall dimensions _____	Distribution of particles (e.g., random, laminated, graded bedding) <u>random</u>
How was it built?	

STRATIGRAPHIC DATA

This Locus is below Loc. 001 and is above Loc. 003

Lateral extent _____ Max, thickness _____ Touches balk(s) _____

How does this Locus relate to all other loci it touches?

This Locus is contemporary with which loci mentioned above?

001, 003

How was this Locus formed? Packed against wall of building as waterproofing

West Batten, 1984
GENERAL IDENTIFICATION
NW of Room 3
225.69

Locus No. 003
~~004~~
Date(s)
225.61 E

Top levels 225.94 Top plan _____; Bottom levels 225.55W Top plan _____

Sections _____ Drawn by architect _____ Photo No. _____

PHYSICAL DATA

What is it made of? stones, earth

What size particles? _____ Color _____

<u>Features</u>	<u>Soil Layers</u>
Compass orientation _____	Direction & degree of slope _____
____ courses high; ____ rows wide	Degree of compaction _____
Overall dimensions _____	Distribution of particles (e.g., random, laminated, graded bedding) <u>random</u>
How was it built?	

STRATIGRAPHIC DATA

This Locus is below Loc. 002 and is above Loc. 004

Lateral extent _____ Max, thickness _____ Touches balk(s) _____

How does this Locus relate to all other loci it touches?

contiguous

This Locus is contemporary with which loci mentioned above?

001 and 002

How was this Locus formed?

W. Badley, 1984
GENERAL IDENTIFICATION
NW of Room 3

Locus No. 0034
Date(s) ~~June 28~~
July 2

Top levels 225.61 ~~225.56W~~ Top plan _____; Bottom levels 225.34 Top plan _____

Sections _____ Drawn by architect _____ Photo No. _____

PHYSICAL DATA

What is it made of? earth

What size particles? _____ Color Brown

<u>Features</u>	<u>Soil Layers</u>
Compass orientation _____	Direction & degree of slope _____
____ courses high; ____ rows wide	Degree of compaction <u>loose</u>
Overall dimensions _____	Distribution of particles (e.g., random, laminated, graded bedding) <u>random</u>
How was it built?	

STRATIGRAPHIC DATA

This Locus is below Loc. 003 and is above Loc. —

Lateral extent _____ Max, thickness _____ Touches balk(s) _____

How does this Locus relate to all other loci it touches?

earlier than 001-003

This Locus is contemporary with which loci mentioned above?

How was this Locus formed?

N. of Room 3

Nimbriga 1984

June 27

West Bath, North of Room 3

Locus 001
Basket 1 Began clearing fill between ^{two} spurs walls projecting ^{from} north corner of Room 3. Uncovered top of two walls set against spur walls and brick-built structure forming a square opening. Modern china within.

Locus 002
Basket 2 Fill of square opening - Top level 225.40m
At 224.95m many fragments of coarse ware pot. 1 frag. + settlement from Bath. 1 tegula frag., bricks, charcoal. Area too narrow to continue down. Stopped digging at 224.72m.

Final Description - see J. Biers Field Notebook
1983 & 1984 p. 63

Final Photos 84.4.27-30

West Wall

North of Room 3

1984

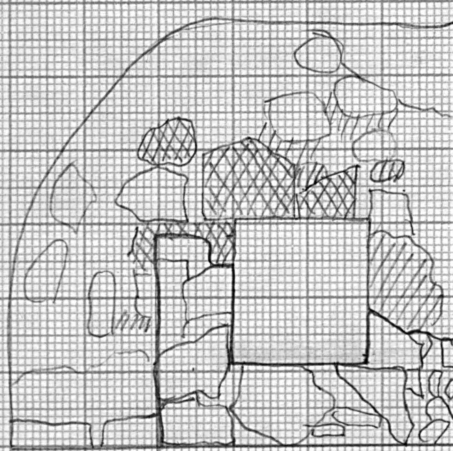
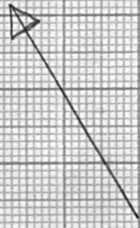

/// mortar

brick

floor: small brick frags,
small schist frags.

— = wall

1:25

Dirt used

West Baden

GENERAL IDENTIFICATION

Locus No. 001

Date(s) June 27

N. of Room 3

225.50

Top levels ^{ca} 226.00 Top plan _____; Bottom levels 225.40 Top plan _____

Sections _____ Drawn by architect _____ Photo No. 84.4.27
-29

PHYSICAL DATA

What is it made of? earth, stone

What size particles? _____ Color _____

<u>Features</u>	<u>Soil Layers</u>
Compass orientation _____	Direction & degree of slope to NE
_____ courses high; _____ rows wide	Degree of compaction loose
Overall dimensions _____	Distribution of particles (e.g., random, laminated, graded bedding)
How was it built?	

STRATIGRAPHIC DATA

This Locus is below Loc. _____ and is above Loc. 001

Lateral extent _____ Max, thickness _____ Touches balk(s) _____

How does this Locus relate to all other loci it touches?

~~Later~~ than 002

This Locus is contemporary with which loci mentioned above? _____

How was this Locus formed?

hill wash

West Baden

GENERAL IDENTIFICATION

North of Room 3

Locus No. 002

Date(s) June 27

Top levels _____ Top plan _____; Bottom levels 224-72 Top plan _____

Sections _____ Drawn by architect _____ Photo No. 84-4-27
- 24

PHYSICAL DATA

What is it made of? earth

What size particles? _____ Color _____

<u>Features</u>	<u>Soil Layers</u>
Compass orientation _____	Direction & degree of slope _____
____ courses high; ____ rows wide	Degree of compaction _____
Overall dimensions _____	Distribution of particles (e.g., random, laminated, graded bedding)
How was it built?	<u>random</u>

STRATIGRAPHIC DATA

This Locus is below Loc. 001 and is above Loc. -

Lateral extent _____ Max, thickness _____ Touches balk(s) _____

How does this Locus relate to all other loci it touches?

later than 001

This Locus is contemporary with which loci mentioned above?

How was this Locus formed?

filling in of eastern

Road

Mirobriqa 1983 West Bath Road

R. Mersereau

- North of Steps at West End -

June 15

Opening area under paving slabs. Levels taken on top of slabs.

Locus 001
Bskt 1

001 will consist of the accumulated wash soil built up between paving slabs.

Datum Point
225.142

The purposes in digging here ~~is~~ ^{are} to date the construction of the road and to clarify the construction phases of the steps leading down into the West Baths.

> Levels on top of paving slabs before removal:

> Photo 83.1.1
top of paving slabs

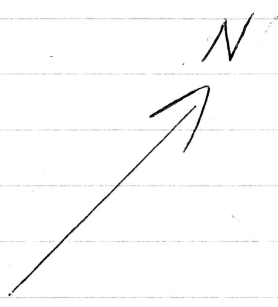
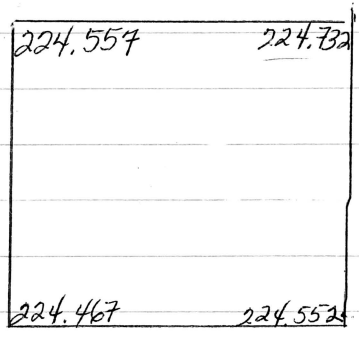

Findings Bskt 1: 2 pieces pottery
1 metal piece

New Locus 002
Bskt 2

002 will begin w/ soil directly beneath paving stones. Bskt 2 will be the 1st pass over the area then will change baskets to insure that Bskt 3 will not be contaminated. Levels taken, see next page

> Photo 83.1.2
top of 002

Mirobriqa 1983 - West Bath Road
- North of Steps at West End -

R. Mersereau

June 15 (cont.)

Locus 002
Bskt 2
(cont.)

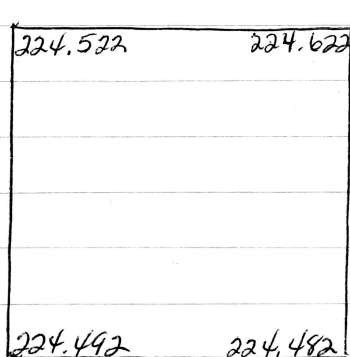

Levels for top of 002

Soil color of 002 : 7.5YR 5/4 brown

soil of 002 is dense with stones of all types & sizes.

Basket 2 Finds : 1 frag. of amphora neck
2 nails
bone frags.
9 pieces pottery

Locus 002 - Next pass across trench, should be uncontaminated.
Bskt 3

^{Composition} ~~soil~~ of 002 Bskt 3 is essentially stones w/ soil inbetween them, i.e. what must have been the packing for the road.

Basket 3 Finds : 5 pieces pottery
1 coin !!

Mirobriga 1983 West Bath Road R. Mersereau
- North of Steps at West End -

June 16 - Continue removal of 002
New day, new basket.

Locus 002
Bskt 4

Bskt 4 Finds : None

> New Datum Point <
225.217

Locus 002
Bskt 5

- Color change in soil on lower SW portion of trench, now 7.5 YR 5/4 to 4/4 ~~strong~~ brown. For Bskt 5 will take down NE portion of trench (where the soil is lighter) to try to find this same color of soil.

Bskt 5 Finds: 3 pieces pottery
2 pieces bone

New Locus 003
Bskt 6

- Have reached a different soil color all over trench (7.5 YR 5/4 to 4/4, ~~strong~~ brown) so will begin new locus. Along edge of top step there is what appears to be a foundation trench, very narrow ~~but~~ (4 to 7 cm wide). ~~and~~ The soil in this foundation trench is dark (7.5 YR 4/4 brown) and much looser than the soil in the rest of the trench. Because of the difficulty

Photo # 83. 2 #2

226.932-mach
1.715
5.2

Mirobrigza 1983-West Bath Road R. Mersereau
- North of Steps at West End -

June 16 cont.

Locus 003
Bskt 6

in digging such a narrow area, I will leave a bank of ~~those~~ ^{as a separate locus 004} attached to it and dig it all out after digging down in 003. In this way the foundation trench fill will not be contaminated by the ~~later~~ ^{earlier} fill next to it. Along edge of foundation trench ⁽⁰⁰⁴⁾ stones ~~is~~ set in 003 are fitted to provide a roughly horizontal edge, as illustrated in photo # 83. 2. 2

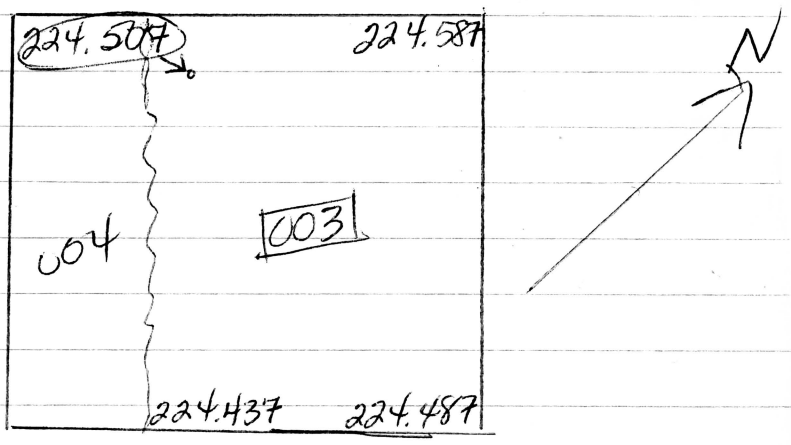

Levels at top of 003

Bskt 6 Finds: 2
4 pieces pottery

003 is packed w/ chips of schist. There are also a few large stones & some bricks & tiles. Also pieces of yellow & red sandstone. Brick fragments of both 4 & 5 cm thicknesses. Most of the brick inclusions are ~~on~~ along NE edge of trench. Also some brick of a brown fabric.

Mirobriga 1983 West Bath Road R. Mersereau
 - North of Steps at West End -

June 16 cont - Locus 004 is a narrow foundation trench for the limestone steps down into West Baths and a bulk along its NE edge to prevent contamination.
 New Locus 004

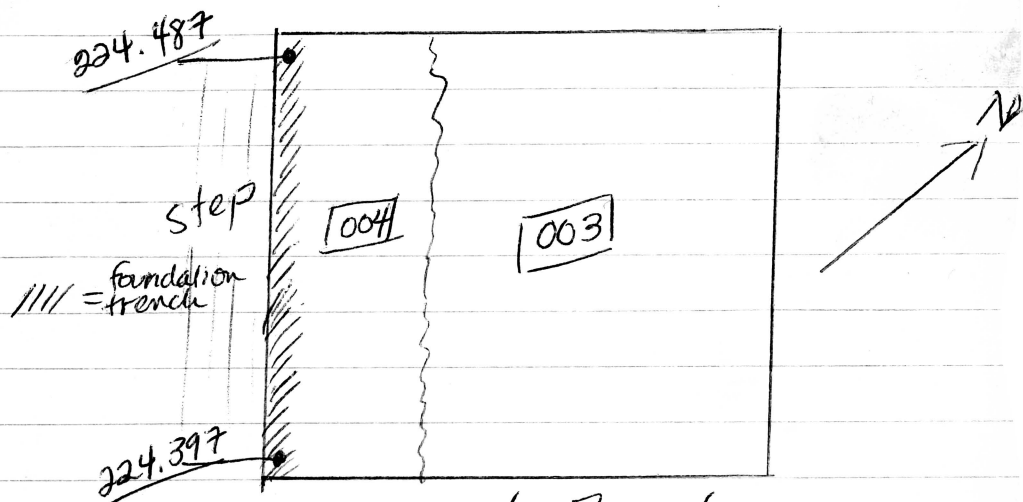

Top Levels of 004
 004 is approx 37 cm wide x 120 cm
 The foundation trench itself is
 4 to 7 cm wide.
 See Top Plan 1.

Mirobrigz 1983 West Bath Rd.
- North of Steps at West End -

R. Mersereau

June 17

Locus 003
Bskt 7

Another pass across 003. New day, new basket. Composition of 003 remains the same. Some of the larger stones coming out of 003 have one (or more) sides trimmed & flattened & were probably at one time wall blocks. The largest & best formed of these is drawn below.

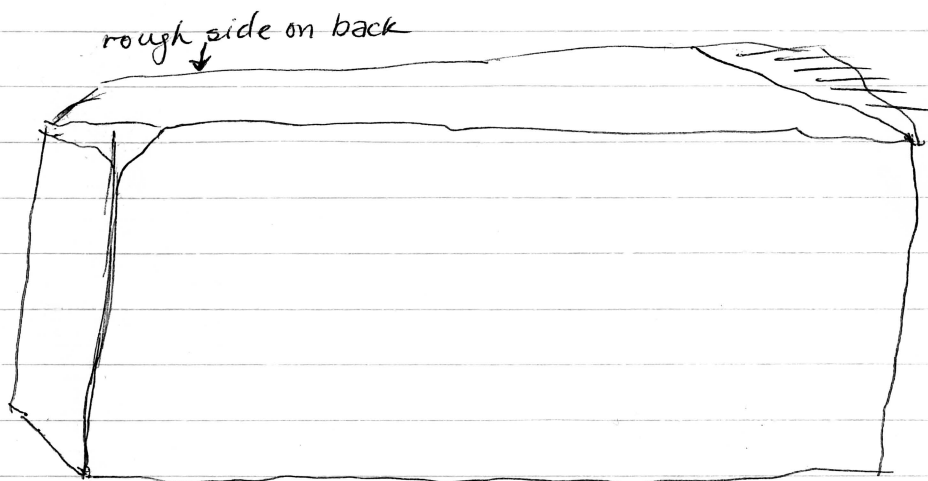

Scale 1:2

The slope within the trench has been considerably reduced by removing this layer of stones.

Bskt 7 Finds : ca. 10 pieces pottery
1 piece glass
4 pieces of bone

Mirobriga 1983 West Bath Rd. R. Mersereau
 - North of Steps at West End -

June 17 (cont)

Locus 003
 Bskt 8

Going down further in 003, have changed baskets. The fill remains constant, shist chips, rocks & bricks & tile frags.

Bskt. 8 Finds: 9 pieces pottery

June 20

Locus 003
 Bskt 9

Continuing in 003
 Datum point nail pulled out by tourist over weekend, so reset point. 003 fill as before.

> New Datum Point <
 225.219

Bskt 9 finds: 11 pieces pottery
 (4 connecting)
 1 piece glass

> also crumbling, corroded iron lumps
 (- not kept)

Mirobriga 1983 West Bath Road R. Mersereau
- North of Steps at West End -

[June 21] — Continuing in 003

Locus 003
Basket 10

Photo: 83.2.10 - of down into 003; top of 004

layer of reddish brown sand (7.5YR 5/6 strong brown) revealed in NW baulk. It lies below the ~~at~~ lowest course of the spur wall underneath a 'sub-course' of ~~the~~ schist. (See final section of NW baulk.)

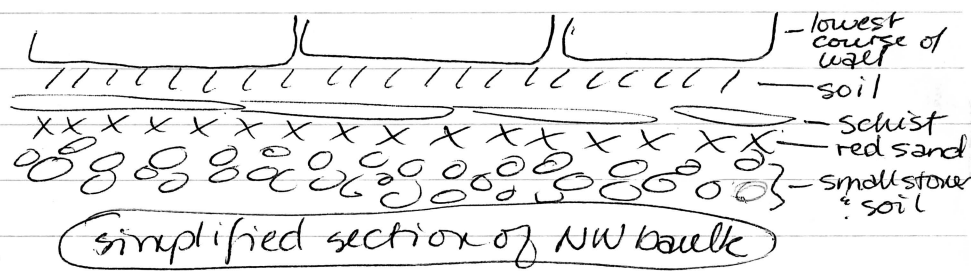

This 'red sand' does not extend out beyond the vertical line of the wall & is not to be found in any of the other baulks, and therefore ~~does not make~~ is not included in locus 003.

Basket 10 Finds: 12 pieces pottery
1 metal nail
1 lump of metal (slag?)

Mirobriga 1983 West Bath Road
- North of Steps at West End -

R. Mersereau

June 21 cont.

New Locus 004
(see page 5)
Bskt 11
Bskt 12

- leaving 003 for now. Will take out 004 by first digging down as far as possible into foundation trench, & then baulk, back & forth. 2 pieces of mortar & small stone w/ mortar attached found in foundation trench.

Most of the ~~the~~ stones in top of baulk next to foundation trench (all 004) have some mortar still attached, & there is good deal of mortar frags scattered throughout. Under large pink stone at W. end of 004 is large chunk of mortar which extends ~~into~~ into packing under spur wall (NW baulk). Will leave this for now.

doesn't this mean that 004 antedates the retaining wall? Slide (C. 83.5.1) shows that ^{it is} part of the foundation trench for the building

Bskt 11 Finds: 1 piece pottery (foundation trench)

Bskt 12 Finds: 1 piece pottery (baulk)

Mirobriga 1983 West Bath Road
- North of Steps at West End -

R. Mersereau

June 22 - Continuing in 004

Locus 004
Bskt 13

The % of mortar present in the bulk of 004 and it being attached to so many of the large stones may suggest that ~~an~~ ~~entire~~ an old wall still standing was torn down & re-used in the packing under the road.

Going down through 004 it is clear that all stones facing the step are ones w/ a flat edge towards step, creating a vertical surface, eg.

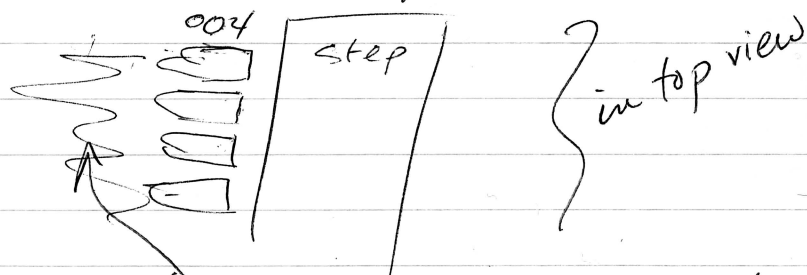

and were laid in rough courses. Only one row given this sort of order though, others behind were more randomly placed.

Have reached bottom of limestone step (ht. of step: 29 cm.), below which ~~are~~ 5 cm. of fill have so far been exposed. No more of large, flattened stones appear on surface of 004.

Bskt 13 Finds : NONE

Mirdbriga 1983 West Bath Road
- North of Steps at West End -

R. Mersereau

June 22 cont

New Locus 005
Bskt 14

Begin new locus 005, now as there is no discernable difference between NE & SW portions of trench. 005 is marked by being that fill which is at lower level than bottom of limestone step.

100 N
99 S
98 E
99.5W
76 stone

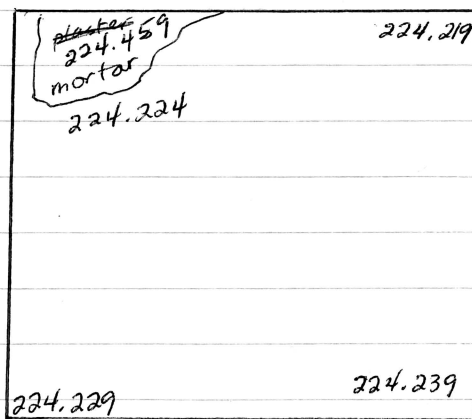

~~005~~ Top of 005

005 extends over whole trench. Area of soil in N corner of trench, approx. 40 x 20 cm & running into NE baulk, has bits of charcoal scattered all through it, but no recognizable shape to the area. Soil of this feature is ~~clay~~ ^{sandy} w/ no stones but same color as rest of 005 (7.5YR5/4)

Bskt 14 finds : ca. 10 pieces pottery
1 piece metal, prob.
2 nail

Mirobriga 1983 West Bath Road
 - North of Steps at West End -

R. Mersereau

June 23 — Continuing in 005.

Locus 005
 Bskt 15

- No more of the very large stones are coming up.
- Large piece of yellow sandstone, dressed, extends out from SW bank (i.e. the step). It lies ca. 6 cm below bottom of limestone step, ~~set~~ soil fill in between. Top of sandstone coated w/ some type of mortar or concrete w/ occasional aggregate. Max. exposed width of sandstone ca. 20 cm. Sandstone runs under mortar in W. corner.
- Small lumps (ca 1-2 cm diam) of decomposed iron ~~in~~ scattered in several places in 005 in NE part ~~section~~ of trench
- Now taking down only SW 1/2 of trench to speed up progress vertically.

Bskt 15 Finds = ca. 15-20 pieces pottery
 2 pieces glass

Mirobriga 1983 West Bath Road
- North of Steps at West End -

R. Mersereau

June 29 - Continuing down in 005 on SW
1/2 of trench. 005 is same soil as
Locus 005 003, densely packed w/ chips of
Basket 16 ^{slate} ~~slust. Decision made to close out~~
~~this trench.~~

Basket 16 Finds : NONE

Decision made to close out this trench.
No pottery coming out & the hard
packing as in 005 could continue
~~for~~ much further down. Large block
of sandstone located ca. 6cm below
bottom of limestone step may be
the back of ~~the~~ sandstone step to SW
of trench. No traces in any locus of
any earlier paving surface.

Photos: { 83.6.5 = FINAL TOP PLAN
83.6.2 = FINAL SECTION: NW bank
B&W { 83.6.4 = FINAL SECTION: NE bank
83.6.1 = FINAL SECTION: SW bank
83.6.3 = Of SE bank

Color - C83.5.1 = view to W

— CONTINUED —

Mirobriga 1983 West Bath Road R. Mersereau
 - North of Steps at West End -

[July 7]

Locus 005

Bskt 17

Level
 1.52 m below DP

— Made decision to have a workman continue down in 005. to at least the level of courtyard floor to SW. He reached a max. depth of 223.699 ASL which is _____ m below courtyard floor so we stopped again. 002 continued to be extremely hard & filled w/ slush chips, w/ some pottery & glass though so it is evidently also road packing ~~for~~ like 003 but is probably the packing for an earlier road because the trench for the large sandstone wall block (as revealed in final section of NW baulk) is cut in to 005, ~~at~~ and ~~the~~ 003 packing for road would not have been laid down before wall block. Likewise revealed in final section of NW baulk is a trench cut into 003 for spur wall resting on top. ~~4~~

[but 003 is same fill as 005! JCB]

(?)

Thus ^{the chronological} sequence would appear to be:

- 1 - earlier road at lower level w/ 005 as packing for it
- 2 - wall of West Bath built
- 3 - limestone step laid
- 4 - 2nd road, w/ 003 & 002 as packing, built
- 5 - spur wall built

Continued

Mirobonga 1983 West Bath Road R. Mersereau
- North of steps at West End -

July 7

Locus 005
Basket 17

The sandstone block lying under the limestone step (as seen in final section of SW bank) may be the original level of the sandstone steps w/ 005 corresponding to the packing for the road ~~to~~ level of that time.

Because the fill of 005 was so hard & the space so narrow the workman was not required to trim the banks as seen in the sections.

There was a soil change in the lowest part of 005, detectable in the banks. Color was 10YR 4/3 (brown / dark brown) & appeared much greyer to the eye. The line of this soil change is drawn in all of the final sections.

12/87

The ^{well} ~~lower~~ reached by the workman was named locus 006 and is thus published.

Mirobriga 1983

R. Mersereau

West Bath Road

- North of Steps at West End -

SUMMARY

The purpose in digging this trench was to date the construction of the road and to clarify the phases & relation of the steps leading down into the baths.

Beneath the paving slabs was packing for the road, dug in 5 loci. The composition of the packing was soil with a high percentage of schist chips; other inclusion types were larger stones, many of which appeared to have been re-used from another wall as there was still mortar attached to many; brick and tile fragments, the majority of which lay ~~in~~ along NE edge of trench, & some ~~of~~ bricks were of a brown fabric.

Most of the large stones were in 002 & 003, otherwise the packing was consistent throughout with a slight change in soil color from 002 to 003.

Next to the limestone step on SW edge of trench a foundation trench had been cut (004). Along NE side of foundation trench ~~app~~ four rough courses of stones w/ one flattened side toward foundation trench had been laid in preparation for it. This 'wall' was one row wide.

→

Other features in this West Batu Road trench were a layer of reddish brown sandy soil exposed in NW baulk as part of the construction of the spur wall built to retain the fill under waterproofing to the NW, and a large piece of yellow sandstone which lay below the limestone step on SW edge of trench. There is approx. 6 cm. of soil between bottom of limestone step and top of sandstone block.

This sandstone is probably connected to the earlier sandstone steps as seen to the NW, ^{The top of sandstone block in trench was ca. 5 cm below top of sandstone step.}

No sign of earlier pavement or packing was found.

The bronze coin found in 002 Bskt 3 came from a sealed layer and should provide a valid dating device if legible. All datable pottery from this trench is of the 1st c. AD.

See also page 14 of notes for suggested construction sequence in this area.

10/26/83

West Bath Road

The chronological sequence of construction and occupation revealed by this trench appears to be as follows:

1. The lowest level excavated, Locus 005, represents the fill existing in the area before the construction of the West Baths. The NW section shows that this fill was cut to receive two blocks of the East corner of Room 3. This cutting was not found within our trench perhaps because ground level sloped from NW to SE, or because side of cutting lay at NW scarp of trench. A sandstone block lying below the upper limestone step has its top level at about the top level of 005. This block is probably to be associated with the sandstone steps visible on the SW side below the limestone step in this area. Possibly the sandstone block within the trench represents the original height of the steps down to the West Baths.
2. A retaining wall for waterproofing of the building was built projecting NE from the corner of the building. This is the wall seen in the NW section of our trench. It lies above a sandy layer which was not found within our trench. 003 and 004 which were dug within the trench lay against the SE face of this wall which extends NE into the NE scarp of our trench. As preserved in the NW section it is not entirely clear how the lower courses relate to that portion of the wall that rises above the paving of the road. There is no clear vertical line denoting the NE face of this wall all the way down to the bottom. Perhaps the bottom courses represent foundation levels? The section makes it seem as if the paving of the road extends underneath the upper courses of the retaining wall, but photos seem to show that this is not the case, that the paving laps up against the narrow row of blocks that retains the waterproofing along the NE face of Room 3. This is something that can be checked in 1984.
3. The ground level for the area was raised and paved, and the limestone steps were laid. 003 and 004 represent this raising of the ground level. 004 contained four courses of stones laid against the steps (or the stones were laid first and the steps placed against them). Presumably stones were used here to provide a firm packing.

In support of this proposed reconstruction, is the observation (J. Biers, 1983 NB, p. 103) that the waterproofing against the courtyard wall between the East and West Baths, to the north of the entrance, appears to be earlier than the steps and the paving of the area. However, this should be investigated further. There is no photograph that shows this relationship.

A problem with the hypothesis that the ground level was originally lower concerns the stylobate parallel to the NE wall of the West Baths. The ledge projecting on the SW side suggests that the ground level was higher when the stylobate was put in. The SW wall of Room 8 on the outside at the base also indicates the original ground level was higher at time of construction. Perhaps a higher ground level was washed away?

Further support for theory that sandstone steps were originally

West Baths Road cont.

only two courses high: the columns set onto the steps at the NW end were not set onto the limestone upper step, but at the location of the upper sandstone step, which was cut back to accept them presumably because they were reused columns and too tall for this location. They must, however, have been set beneath an architrave, perhaps the original architrave for the entranceway?

MIRBRIGA 1983

WEST BATH RD.

- NORTH OF STEPS AT WEST END

TOP PLAN 1

[TOP OF 004 AND STEP]

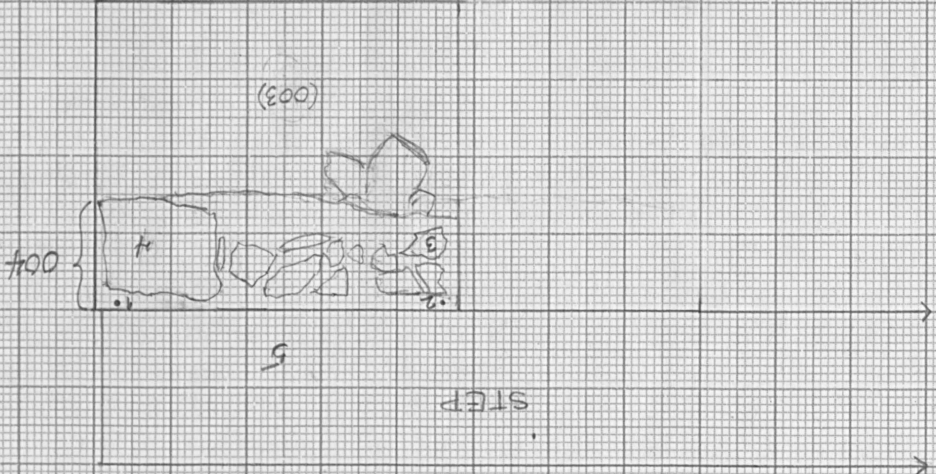

LEVELS

- 74 1 - 224.479
- 85 2 - 224.369
- 88 3 - 224.419
- 71 4 - 224.509
- 64 5 - 224.579

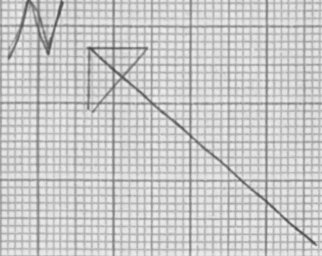

SCALE 1:25

DATUM POINT - 225.319

R. MESSEREAU

N

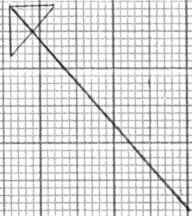

MIROBRIGA 1983
West Bath Road
- North of steps at West End
FINAL TOP PLAN

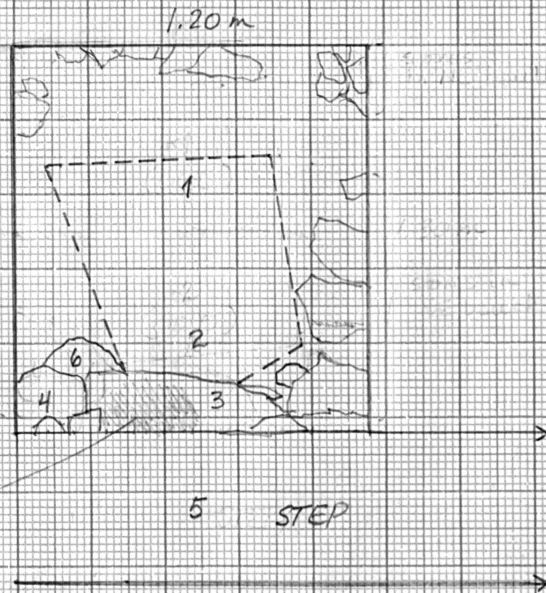

LEVELS

	Below DP	ASL
1	152	223.699
2	150	223.719
3	99	224.229
4	100	224.219
5	65	224.569
6	113	224.089

NB - Areas outside of dotted lines are baulks

SCALE - 1:25

DATUM POINT: 225.219

R. MERSEREAU

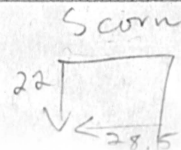
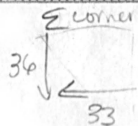

IV

MIROBRIGA 1983
 West Bath Road
 - North of Steps at W. End
 FINAL SECTION: NW baulk

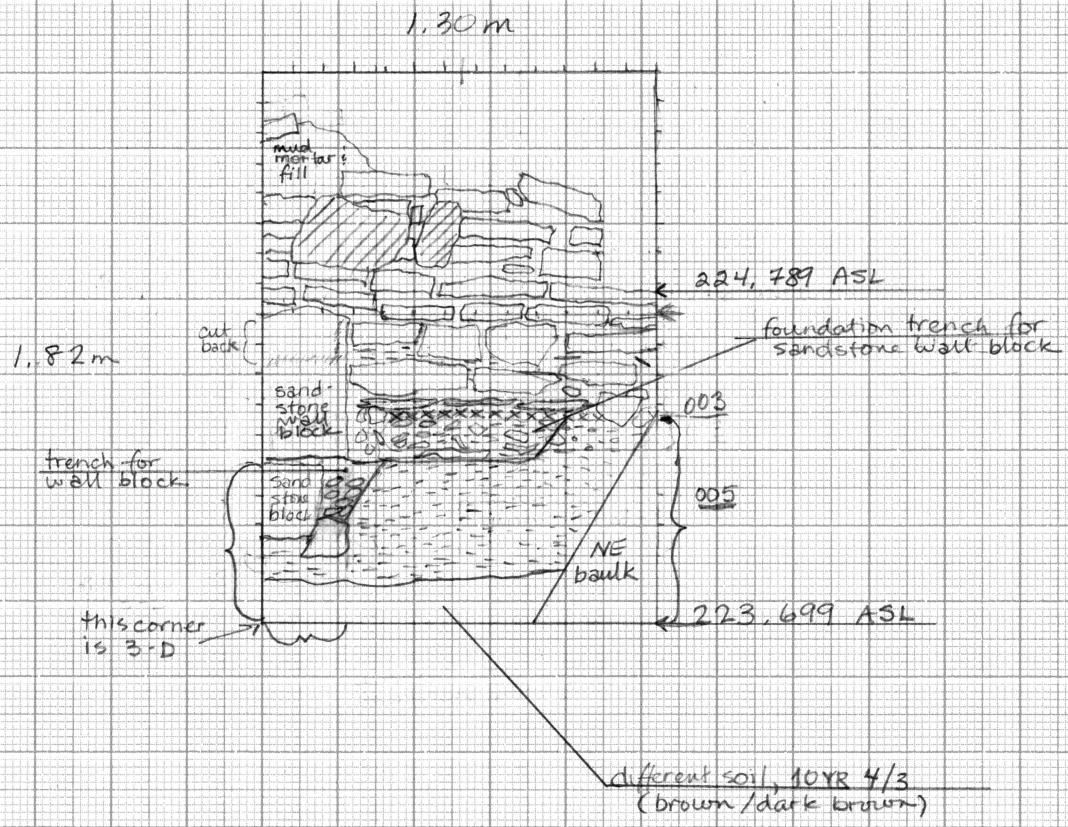

003 does not show on this section because of wall

LEGEND

xxxxxx = reddish brown sand

==== = chips of shist in soil packing

//// = waterproofing concrete

SCALE 1:25

R. MERSEREAU

IVa

MIROBRIGA 1983
West Both Road
- North of Steps at W. End

FINAL SECTION: NE bank

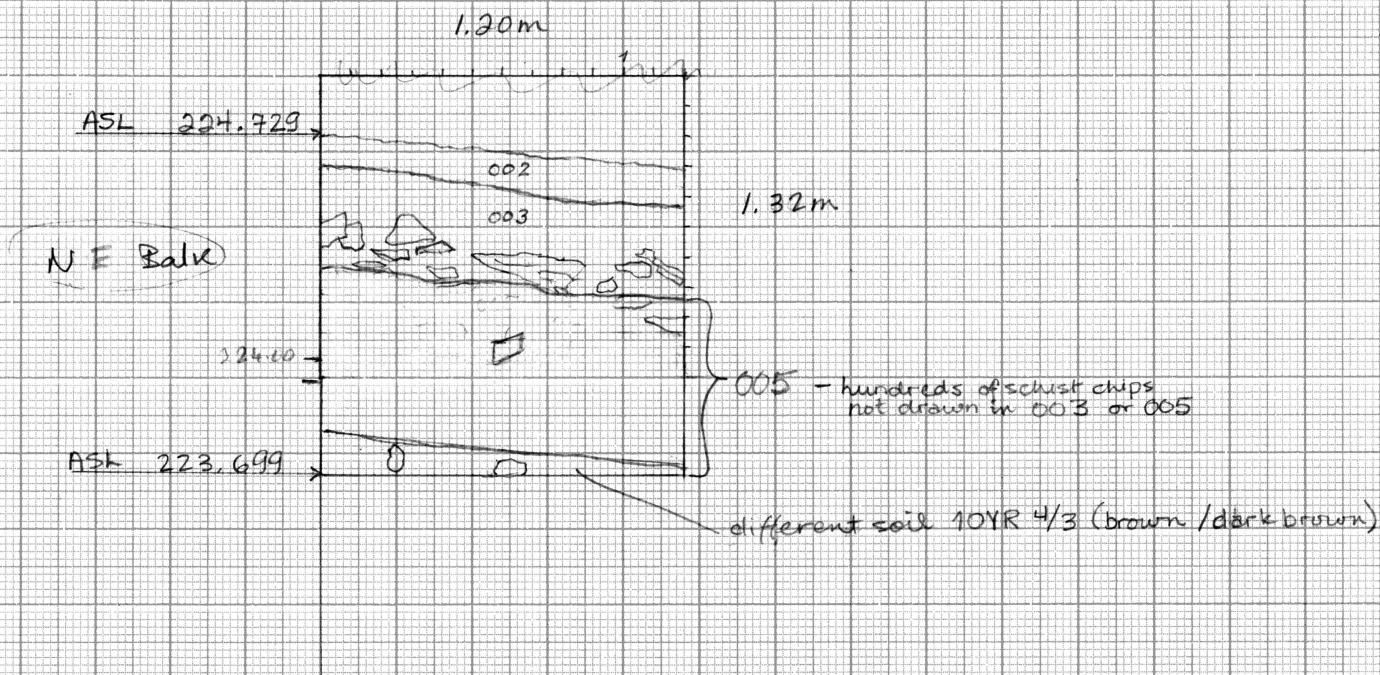

SCALE - 1:25

R. MERSEREAU

1.50 - bottom

ASL - 223.6

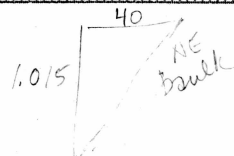

49 - mid

MIROBRIGA 1983
West Bath Road
- North of Steps at W. End

FINAL SECTION: SW bank

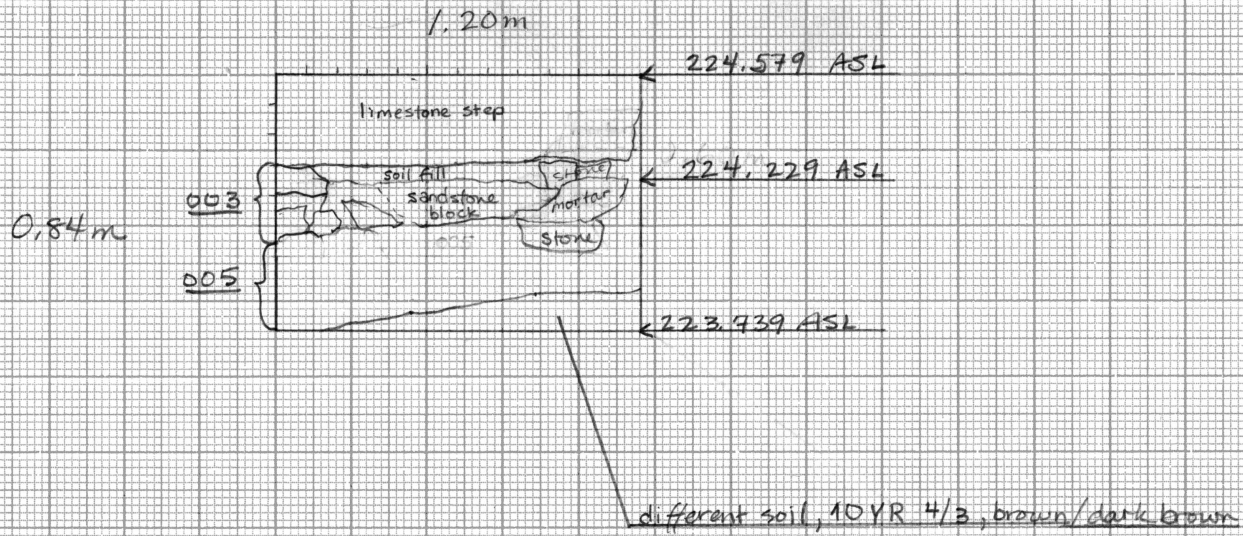

SCALE - 1:25

R. MERSEREAU

GENERAL IDENTIFICATION

N-224.732 S-224.467
E-224.552 W-224.557

Locus No. 001
Date (s) VI/15/83

N-224.622 S-224.492
E-224.482 W-224.522

Top levels ↑ Top plan none ; Bottom levels W-224.522 Top plan none

Sections none Drawn by architect no Photo No. 83.1.1

PHYSICAL DATA

What is it made of?: Soil, washed in between paving stones, loose, crumbly; irregularly deposited because of the stone paving stones.

What size particles? coarse Color 7.5 YR 5/4 brown

Features	Soil Layers
Compass orientation _____	Direction & Degree of slope <u>S up to N</u>
____ courses high; ____ rows wide	Degree of compaction: <u>loose</u>
Overall dimensions _____	Distribution of particles (e.g., random, laminated, graded bedding)
How was it built?:	<u>random</u>

STRATIGRAPHIC DATA

This Locus is below Loc. surface & is above Loc. 002

Lateral extent 1.30 x 1.20m Max. thickness 10 cm Touches balk(s) NE, NW, SE, SW ~~NS, EW~~

How does this Locus relate to all other loci it touches?:
Locus 001 lies above 002 and should mostly be later than 002. Locus 001 is that soil which lay between the paving stones of the road, thus it was of irregular depth.

This Locus is contemporary with which loci mentioned above?:
Probably none, though there may be some contamination from 001 into 002 at the time of deposition, thus 002 removed in 2 baskets.

How was this Locus formed?:
By soil washing in between the paving stones of the road. Could be an accumulation over many centuries.

West Bath, Road

GENERAL IDENTIFICATION

N-224.587
E-224.487
S-224.437
W-224.507

Locus No. 002
Date (s) IV-15-83

Top levels N 224.522 E 224.622 S 224.492 W 224.482 Top plan no; Bottom levels no Top plan no

Sections no final of NE bank Drawn by architect no Photo No. 83.1.2

PHYSICAL DATA

What is it made of?: Coarse soil w/ approx 70% stone inclusions of various types & sizes. 4% broken tiles.

What size particles? Coarse-pebbly Color 7.5 YR 5/4 brown

Features	Soil Layers
Compass orientation _____	Direction & Degree of slope <u>up from South to North</u>
____ courses high; ____ rows wide	Degree of compaction: <u>hard</u>
Overall dimensions _____	Distribution of particles (e.g., random, laminated, graded bedding) <u>random</u>
How was it built?:	

STRATIGRAPHIC DATA

This Locus is below Loc. 001 & is above Loc. 003, 004

Lateral extent 1.30 x 1.20m Max. thickness 0.135m Touches balk(s) NE, NN, SE, SW

How does this Locus relate to all other loci it touches?:
It lies below irregular 001 and above both 003 & 004. 003 & 004 lay at the same level & 002 covered both of them.

This Locus is contemporary with which loci mentioned above?: 003, 004
002, 003, 004 & 005 are all packing laid down for the road. Uppermost layers of 002 dug in separate baskets to insure no contamination in bskt 3.

How was this Locus formed?:
Soil ^{& packing} beneath road surface onto which paving slabs were laid directly.

Pottery

MATERIAL CULTURE AND OBJECTS

Bskt #	Date Dug MC	Locus Reg. No.	Field Reading Assoc. Pottery Basket No.	Reg Sherds Identification
2	IV/15 83	002	1 rim frag. of grey-fired Alentejo joins Bskt 1, CWF 1	- SDNR
			3 frags; probably CWF 1	- SDNR
			2 joining chips with grey-core & 2 other frags of CWF 3	- SDNR
			1 unidentified red-slip rim	- SDNR
R			1 amphora shoulder Pelicet form 46? - different fabric from amphora frag in Rm 2	#326
3	VI/15 83	002	4 frags CWF 1, including 2 joining frags of nozzle? with burning	- lamp - SDNR rest discarded
			1 unidentified coarseware, not CWF 3	- discard
4	VII/16 83	002	NO POTTERY	
5	IV/16 83	002	2 frags TSH, including 1 rouletted rim like HA 12, mid 1st c - 2nd 1/2 1st c	rim: #328 cup frag: #329
			1 frag CWF 3	- discarded

PROGRESS OF EXCAVATION (Dates dug, strategy and procedures, etc.)

MC

- Bskt 1 dozen bone chips - discarded
- 2 iron nails - SDNR
- R 2 frags of revetment, limestone
- R Bskt 1 bronze coin - Reg # C/52
- 3 1 iron nail frag - SDNR
- 1 bone chip - discarded
- Bskt 5 2 bone chips - discarded

Pottery

~~MATERIAL CULTURE AND OBJECTS~~

Bskt #	Date Dug MC	Locus Reg. No.	Field Pottery Assec. Pottery Basket No.	Req. Shards Identification
9	VI/20 83	003	1 frag CWF 3	} SDNR
			2 frags CWF 4?	
			1 frag pink Alentejo	
			4 joining frags of wall & edge of base of white Alentejo CWF 4, probably of basin	
			2 frags white Alentejo including 1 with combed decoration	
			1 outturned rim of local or regional? semi-fine ware with orange slip (should be under fired Spanish color coated)	
			discarded	
10	VI/21 83	003	10 frags of CWF of olla - SDNR	3 plus 1 rim dated 'Early Roman'
			1 frag pink Alentejo, very thick - SDNR	discarded
			1 white Alentejo pitcher handle - SDNR	SDNR
			2 joining frags of base & lower wall of CWF 4?, wheel made basin	- SDNR

PROGRESS OF EXCAVATION (Dates dug, strategy and procedures, etc.)

MC

Bskt 9 - 1 frag of colorless glass, probably base - SDNR.

Bskt 10 - 1 nunk & 5 chips of & one nail of iron - SDNR

i 368
248
708
283



Pottery

West Bath, Road

MATERIAL CULTURE AND OBJECTS

Bskt #	Date Dug MC	Locus Reg. No.	Field Reading Assoc. Pottery Basket No.	Req. Shards Identification
6	VI/16 83	003	1 frag pink Alentejo (w2)	SDNR
	"	"	1 frag CWF 3	SDNR
	"	"	2 joining frags unidentified fabric, flat bottom of pan	SDNR
7	VI/17 83	"	6 joining & non-joining frags of CWF 3	SDNR
R	"	"	1 chip TSH, form compare HA 11, mid src	#330
	"	"	1 frag white Alentejo w/ orange w/ wash on exterior	SDNR
	"	"	1 rim white Alentejo fired greyish, compare bskt 1 & 2	SDNR
8-1	VI/17 83	"	3 frags CWF 1 including 1 heavy jar rim & 1 possible bottle rim	SDNR
	"	"	1 frag. CWF 2?	SDNR
R	"	"	5 chips TSH including (a rim) - #327 (rim related to Drag 15/18?) rest of chips	SDNR
8-2	VI/17 83	"	1 chip TSH	SDNR
	"	"	3 frags CWF 3	SDNR
	"	"	1 turned rim of Sines cooking fabric of pink Alentejo	SDNR
			1 unidentified coarse ware sherd	SDNR

PROGRESS OF EXCAVATION (Dates dug, strategy and procedures, etc.)

MC

Bskt 7 - 5 pieces bone } SDNR
 1 frag of colorless glass }

in ntblk: brown brick fabric - bskt 6
 -discarded

Pottery

MATERIAL CULTURE AND OBJECTS

Bskt #	Date Dug MC	Locus Reg. No.	Field Entry Assoc. Pottery Basket No.	Req. Shards Identification
9	VI/20 83	003	1 frag CWF 3	SDNR
			2 frags CWF 4?	
			1 frag pink Alentejo	
			4 joining frags of wall & edge of base of white Alentejo CWF 4, probably of basin	
			2 frags white Alentejo including 1 with combed decoration	
			1 outturned rim of local or regional? semi-fine ware with star slip (should be under-fired Spanish color coated) discarded	
10	VI/21 83	003	10 frags of CWF 3 plus 1 rim of olla - SDNR → dated 'Early Roman'	SDNR
			1 frag pink Alentejo, very thick - SDNR discarded	
			1 white Alentejo pitcher handle - SDNR	
			2 joining frags of base & lower wall of CWF 4?, wheel made basin - SDNR	

PROGRESS OF EXCAVATION (Dates dug, strategy and procedures, etc.)

MC

Bskt 9 - 1 frag of colorless glass, probably base - SDNR

Bskt 10 - 1 nunk & 5 chips of & one nail of iron - SDNR

48T

263

West Bally Road

GENERAL IDENTIFICATION

Locus No. 004

Date (s) VI/16/83

W-224.487 / S #1
Top levels 224.397 Top plan #1 ; Bottom levels 5-224.229 Top plan _____

Sections no Drawn by architect no Photo No. 83.2.10

PHYSICAL DATA

What is it made of?: Foundation trench is ca 98% soil w/ 2% stone inclusions. Adjacent bank contains large wall stones faced to form edge for foundation trench plus soil w/ stone chip inclusions as in 003.

What size particles? _____ Color 7.5 YR 4/4 brown

Features	Soil Layers
Compass orientation _____	Direction & Degree of slope <u>from S up to W</u>
_____ courses high; _____ rows wide	Degree of compaction: <u>loose to tight</u>
Overall dimensions _____	Distribution of particles (e.g., random, laminated, graded bedding)
How was it built?:	<u>random</u>

STRATIGRAPHIC DATA

This Locus is below Loc. 002 & is above Loc. 005

Lateral extent 4 to 7 cm x 120 cm Max. thickness 0.263 m Touches balk(s) SE, SW, NW

How does this Locus relate to all other loci it touches?:

004 lies horizontally between the top limestone step and 003, below 002 and on top of 005.

This Locus is contemporary with which loci mentioned above?: Mostly likely the bank of 004 is contemporary w/ all loci mentioned above as it is part of the packing for the road, but the foundation trench is later when the step was laid down, though obviously the road construction prepared

How was this Locus formed?: for the step by placing the rough course of stone next to foundation trench.

Foundation trench for limestone steps down into West bath plus a bank to the NE approx 33-34 cm wide which is same road packing as in 003

GENERAL IDENTIFICATION West Balky Road Locus No. 005
 N - 224.219 S - 224.229 Date (s) VI/22/83
 E - 224.239 W - 224.224 NE - 224.119 SW
 Top levels _____ Top plan Final ^{no}; Bottom levels 223.979 Top plan Final
Final of NW NE 83.6.1-5
 Sections SW bank Drawn by architect no Photo No. C83.5.1

PHYSICAL DATA

What is it made of?: Soil densely packed w/ chips of shist, sandy in patches w/ bits of charcoal.

What size particles? _____ Color 7.5YR 4/4

<u>Features</u>	<u>Soil Layers</u>
Compass orientation _____	Direction & Degree of slope <u>none</u>
____ courses high; ____ rows wide	Degree of compaction: <u>very hard</u>
Overall dimensions _____	Distribution of particles (e.g., random, laminated, graded bedding) <u>random</u>
How was it built?:	

STRATIGRAPHIC DATA

This Locus is below Loc. 003, 004 & is above Loc. unexcavated

Lateral extent 1.20 x 1.30 m Max. thickness 0.26 m Touches balk(s) NW, SW, NE, SE

How does this Locus relate to all other loci it touches?:
005 lies below 003 & 004 & was differentiated ^{only} as being that fill which lay below the bottom of the limestone step, i.e., below the foundation trench & associated fill for the step. There was no difference in the composition of the fills of 003/004 and 005

This Locus is contemporary with which loci mentioned above?: 003 & the bank of 004.

How was this Locus formed?:
Packing for the road.

Pottery West Bath Road
~~MATERIAL CULTURE AND OBJECTS~~

Bskt #	Date Dug MC	Locus Reg. No.	Field Rolling Assoc. Pottery Basket No.	Reg Sherds Identification
11				
14	VI/22 83	005	5 frags CWF 3	SDAK
	"	"	3 frags from one & 9 chips from second white Alentejo vessel, CWF 1	
	"	"	1 very thick, coarse sherd with concentric combed decoration on one side	
	"	"	1 frag of TSH plate w/ 1/4 round moulding, compare Rm. 2, bskt 7	
15	VI/23 83	005	1 frag CWF 4, handmade	
	"	"	1 thick walled very coarse wheel-made unidentified frag	
	"	"	12 frags CWF 3 from several vessels including one rim & one blackened by soot on exterior	
	"	"	1 unidentified frag, wheelmade w/ blue paint (incrustation?) on interior	
	"	"	16 pieces white Alentejo, all wheel made including 1 semi-closed vessel rim	
16	VI/29 83	005	NONE	

MC ~~PROGRESS OF EXCAVATION~~ (Dates dug, strategy and procedures, etc.)

Bskt 14 - 1 iron lump

Bskt 15 - 14 frags glass of which 3 are window glass, & other one a colorless chip

Room 2

Mivobriga

West Batts Room 2 SW. corner.
2. AUGUST 1982.

Photo 82-443

Top of 001 floor surface and 002 sub-floor packing. To NW

001 #1

Top plan #1 Starts. 90-102 below.
Pebble of cement floor. White cement (closest to white) with grey blue pebbles (7.54R 5/0 Gray NS) and tile fragments. In poor condition except in SE. corner of area where it runs up to c. 2cms from the wall and is parallel with it w/ earth between them. This space probably left by a facade of marble/worked stone or caused by a slump in the floor pulling the edge from the wall slightly.

This cement w/ pebble of tile frag. aggregate was poured over a layer of cobbles (002) to a depth of 3-6 cms (max depth between cobbles).

Very similar construction to floor in 'House of brick columns' of 'Temple of Venus' on hill top.

No MATERIAL CULTURE

002 #2.

Photo 82-448

Top of 002 To NW. Cobble sub floor color taken also.

Starts. 96-105 below.

Cobble layer over which cement floor poured.

Sizes ~~825~~ 25 x 12 x 6, 9 x 6 x 4, 9 x 4 x 2

These were laid over whole area of panned it to make a continuous layer of stones. Lie 1 cobble depth on earthen fill. 1 B. Shard found when cobbles hoovered from earth below.

2 August

Rm 2

003 #3.

Photo 82-451

Top of locus 003 Looking to N.W.

Starts 102-112.

Top plan #3.

Color. 5YR 4/4 Reddish Brown.

Clayey clinging earth, predominantly sandy grained w/ pebble size frag of schist.

Very damp. 2 sherds of Arentejo ware (fabric 1) - one is the pink variant -.

Covers whole area & comes down on layer of white consistency of schist slabs bricks & cover tiles - 004.

1 frag iron? 1

004 #4.

Photograph #

82-474.

3 August

Top plan #4.

Starts - 102-117. Steep down to north.

Large fragments of what seems to be a pot w/ handle. Many large brick fragments & schist slabs.

A little bone.

Color - 5YR 4/4 Reddish Brown.

Pot turns out to be numerous pieces of terracotta water pipe thrown into fill.

Photographs 82-

82-

'Pot' in 004. From Above (+ color).

—— " —— looking S.E.

46 brick fragments. 4.0 to 4.2 cm thick.

West Battery, Run 2

4 August.

105 #5

7.5 yr 4/6 strong brown
silt sand & pebble size schist frags
Under 004 #4.

how

Hard 'greenish' earth under brick/pipe stone cobbles
Lens of fill. Sandy earth w schist frags and some
bones & shards.

1 frag Italian? Sigillata w red glass surface &
creamy fabric. 1 frag lamp? miniature vessel w/
small knob attached both possibly dateable.

Comes down after c. 10 cm on stone socle for
south wall, while west wall merely founded on fill.
w/ foundation course of large dressed sandstone
blocks. Also comes down on 2 new fill lenses
~ one with concrete, one with yellow mortar frags
in it. cf. final sp plan.

Struts

Ends.

Photograph #82-559

Final photograph - to west

Close taken also

Mirambaga 1982

W Bath Room 2.

This probe was designed to establish, if possible, the date of the white cement and pebble floor and the walls of the first phase of the building. The 5 loci excavated represent the make-up of the floor:

005, 004 and 003 are layers of fill made of various materials designed to raise the level of the room from either bedrock or an earlier occupation layer. In Locus 003 a number of objects were found, two of which may give some indication of date: a Terra sigillata ~~Halica?~~ Micro chip is probably early (1st AD. (i.e. not L.N. or J.C.)) The other is a small part of a lamp or very small vessel.

When the desired level was reached a founding level of cobbles⁽⁰⁰²⁾ was laid & tamped into the sand of 003 over this white cement⁽⁰⁰¹⁾ & a pebble & brick fragment aggregate was poured. This has subsequently slumped in the middle of the room.

The walls: the south wall was founded on a stone built rock up to & over which 005 ran. The west wall is founded on large cut limestone blocks resting on 005.

The floor: The white pebble floor appears to run into the doorway, across the threshold & under the caccioperto (bubbly) cement used to secure the slate slabs of the floor in Room 1. If true it may be evidence of repairing in a second phase as observed in pink mortar elsewhere on site (e.g. the forum area).
Nb Pottery from 005 #5 not read includes sig fragment.

Recommendation: to expand area excavated & continue sounding & acquire more material.

Room 2

DOORWAY

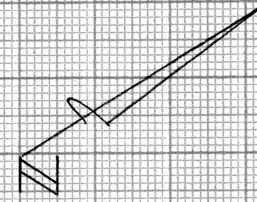
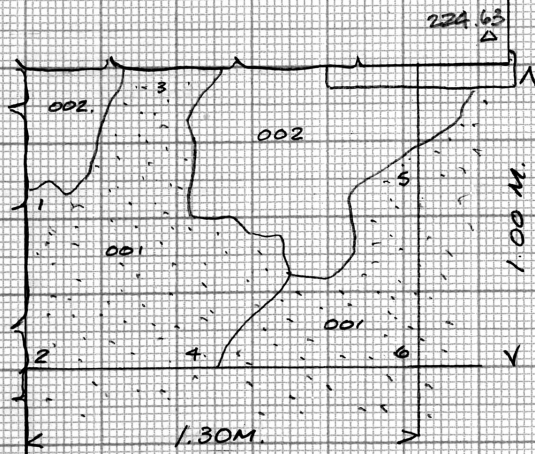

1	92	223.71
2	90	223.73
3	95	223.68
4	97	223.66
5	100	223.63
6	102	223.61

SCALE 1:25
G.D.R.S.

TOP PLAN #1 TOP OF 001

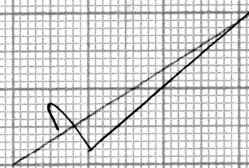
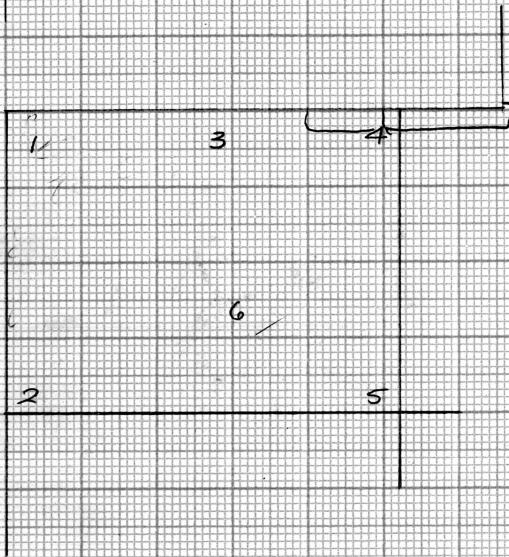

1	96	223.69
2	97	223.66
3	99	223.64
4	101	223.62
5	103	223.60
6	105	223.58

TOP PLAN #2 TOP OF 002.

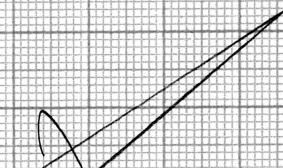
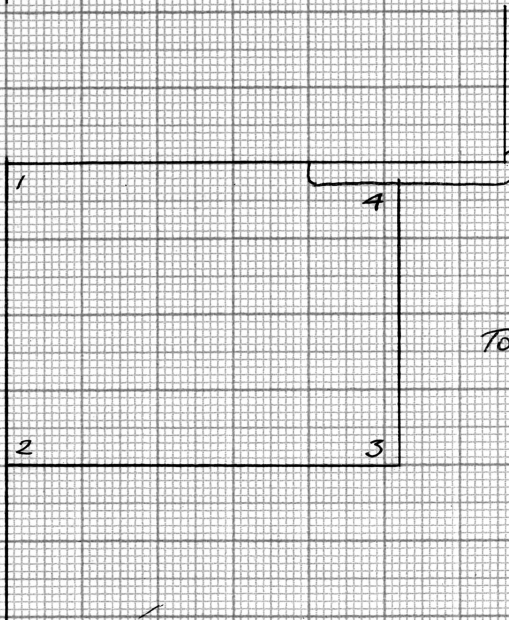

1	102	223.61
2	105	223.58
3	112	223.51
4	107	223.66

TOP PLAN #3 TOP OF 003 #3

Room 2

DATUM 224.63

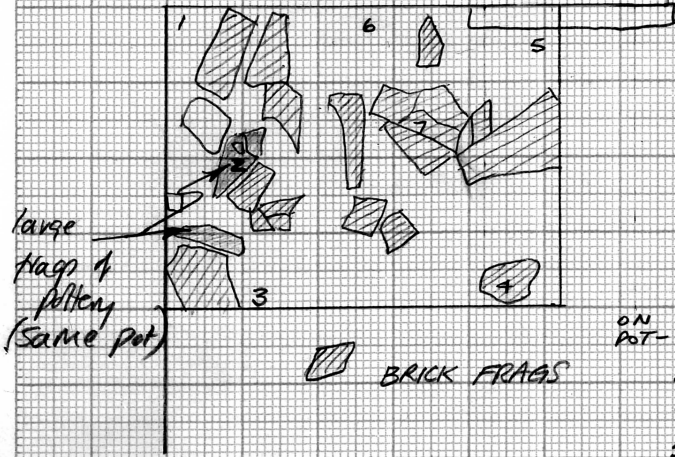

TOP PLAN #4.
TOP OF 004
3 AUGUST 82



large
flag of
felt
(same pot)

BRICK FRAGS

ON #	1	102	223.61		
POT-2	2	107	223.56		
	3	116	223.47	6	113 223.50
	4	116	223.47	7	111 223.52
	5	117	223.46		

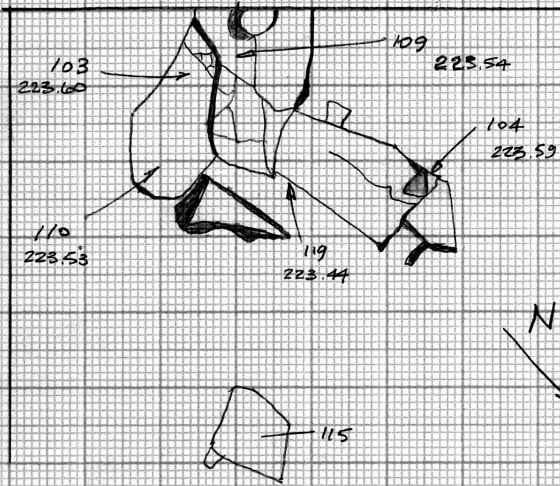

DETAIL OF POT (CANDLE BASE)
SCALE 1:10

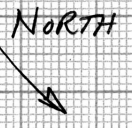

WALL

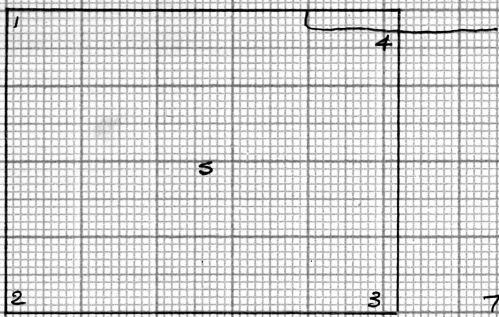

	1	121	223.42
	2	118	223.45
	3	125	223.38
	4	121	223.42
	5	125	223.38

TOP PLAN #6 TOP OF 005.

224.63

Room 2

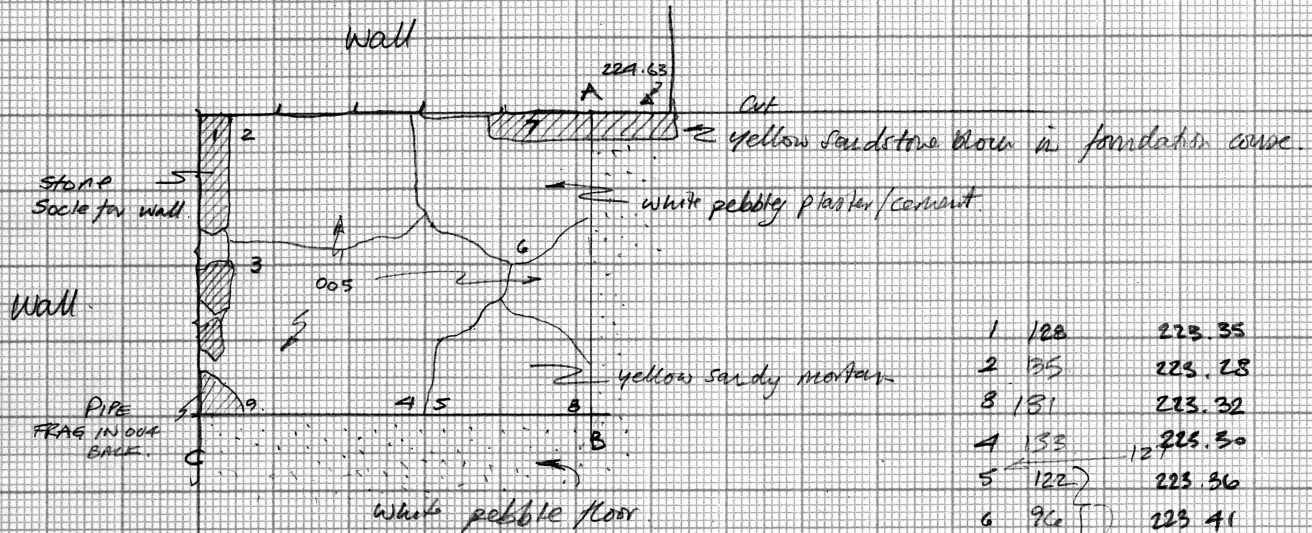

MIROBRIGA 1982
 ROOM 2 N. BATH
 FINAL TOP PLAN

1	128	223.35
2	135	223.28
3	131	223.32
4	133	223.30
5	122	223.36
6	96	223.41
7		223.61
8	129	223.34
9	128	223.35

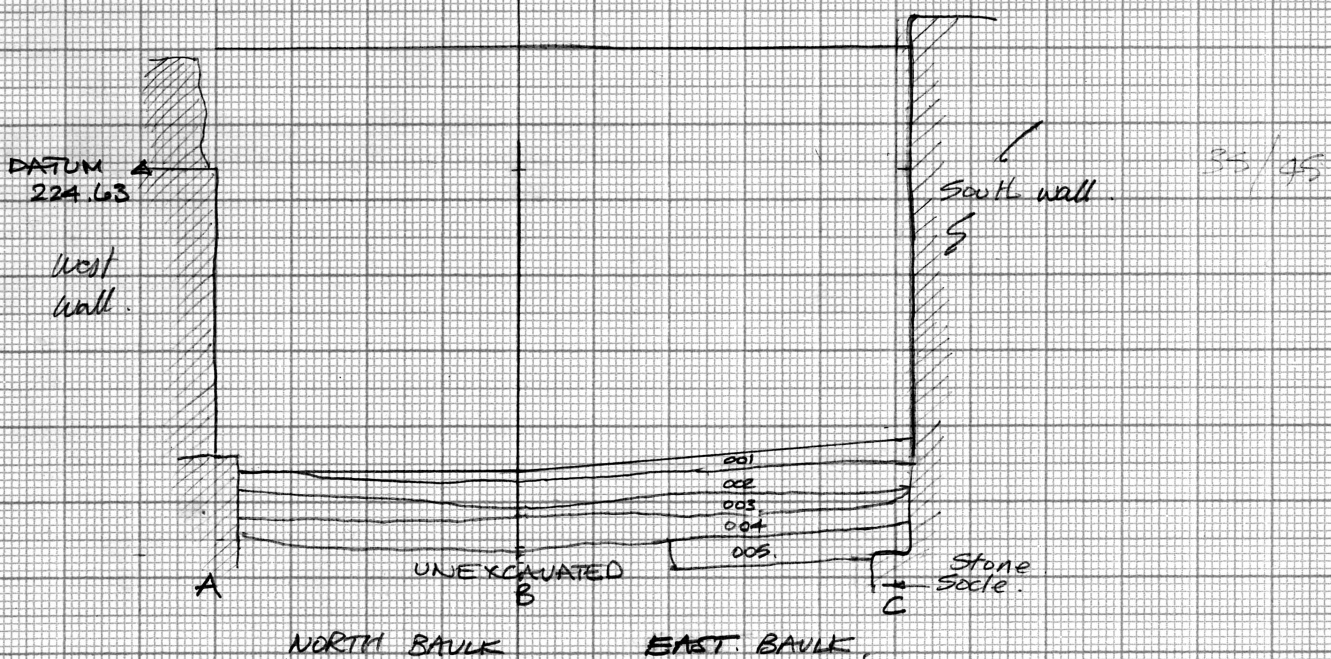

NORTH BALK EAST BALK

ROUGH SECTION OF NORTH & EAST BALK,

III
O

MICROBRICA '83
RM 2 SW CORNER W. BATHS
JUNE 17 1983

FINAL SECTION
~~NORTH BALK~~
NE Balk.

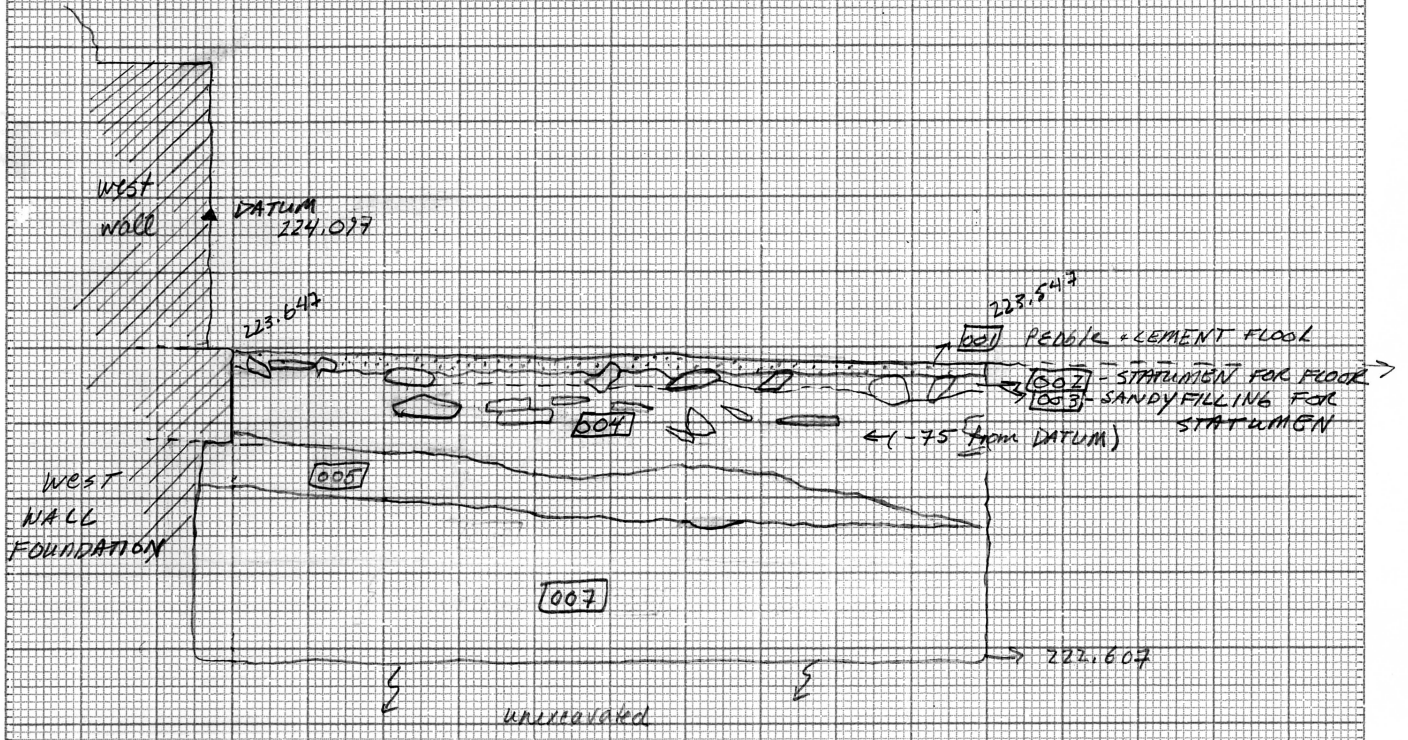

YEAR 1982 GRID AREA W BATH ROOM 2.
 SITE MILOBRIQA BATHS. LOCUS NO. 001
 GENERAL IDENTIFICATION Cement & Pebble Floor. DATE (s) 2 August, 1982
^{223.73}
^{223.58}
 Top levels 223.61 Top plan 1; Bottom levels 223.69 Top plan 2.
 Sections N&E Drawn by architect No. Photo No. 82-443

PHYSICAL DATA

What is it made of?: Pebbles Tile & cement.
 What size particles? Pebbles sand & pebble size clay (tile) fragm. Color Mottan - 10 YR 8/1 white
Pebble - 7.5 YR 5/0 N 5 GRAY.

<u>Features</u>	<u>Soil Layers</u>
Compass orientation _____	Direction & Degree of slope <u>DOWN TO NORTH 5°</u>
_____ courses high; _____ rows wide	Degree of compaction: <u>Very hard.</u>
Overall dimensions _____	Distribution of particles (e.g., random, laminated, graded bedding)
How was it built?: _____	<u>Random.</u>

STRATIGRAPHIC DATA

This Locus is below Loc. AIR & is above Loc. 002.
 Lateral extent SEE TOP PLAN I Max. thickness 6 CMS touches balk(s) N, E

How does this Locus relate to all other loci it touches?:
Contemporary with 002, and S. & W. walls up against which it ran. Laid directly over cobbles of 002.

This Locus is contemporary with which loci mentioned above?:
002 S. WALL W. WALL

How was this Locus formed?:
Concrete w/ aggregate of pebbles & tile/brick fragments poured over a substructure of cobbles to a depth of 2-6 cms & smoothed down (cf construction & floor in D.S. house & brick columns)

No M.C.
No Poetry.

YEAR 1982

GRID AREA W. BATH Room 2.

SITE MUROBURA BATHS

LOCUS NO. 002

GENERAL IDENTIFICATION Sub-floor.

DATE (s) 2 August 1982

Top levels ^{223.58} 223.69. Top plan 2.; Bottom levels ^{223.66} 223.51 Top plan 3.

Sections N/E Drawn by architect No. Photo No. 82-448

PHYSICAL DATA

What is it made of?: Cobbles (rows)

What size particles? Cobbles 25 x 12 x 5
to 9 x 6 x 2 cm. Color ^{10 yr 8/1 white} Montau on cobbles.

Features

Compass orientation _____

_____ courses high; _____ rows wide

Overall dimensions _____

How was it built?: _____

Soil Layers

Direction & Degree of slope 5° down to N

Degree of compaction: Hard Packed.

Distribution of particles (e.g., random, laminated, graded bedding)

Random.

STRATIGRAPHIC DATA

This Locus is below Loc. 001. & is above Loc. 003.

Lateral extent Whole Area Max. thickness 9 cm. touches balk(s) N, E

How does this Locus relate to all other loci it touches?:

Laid over earth fill to depth of 1 cobble ±
then concrete paved over it.

This Locus is contemporary with which loci mentioned above?:

001

How was this Locus formed?: Cobbles & large pebbles packed &
pounded in order to be foundation for cement floor.
No earth only stones.

Pottery 002 Basket #2, August 2

check
this with label
my notes differ

1 Body Sherd Coarseware fabric 1 (White Aleutjo)

1 frag possible Pink Aleutjo ware. Saved.

NB text indicates that labels have been switched.

1984 Pottery reading - KS.

2 frags White Aleutjo ware.

223
223-616
223-24
36

YEAR 1982.

GRID AREA W. Bath Room 2.

SITE Mivobanga BATHS.

LOCUS NO. 003

GENERAL IDENTIFICATION Levelling course

DATE (s) 2 August, 1982

Top levels ^{223.66} 223.51 Top plan 3; Bottom levels ^{223.61.} 223.46 Top plan A

Sections ~~NNE~~ NNE Drawn by architect No Photo No. 82-451

PHYSICAL DATA

What is it made of?: Earth.

What size particles? Silt, Sand, pebbles. Color 54R #7
Reddish Brown.

Features

Compass orientation _____

_____ courses high; _____ rows wide

Overall dimensions _____

How was it built?: _____

Soil Layers

Direction & Degree of slope 5° Down to N.

Degree of compaction: Soft.

Distribution of particles (e.g., random, laminated, graded bedding)

Random.

STRATIGRAPHIC DATA

This Locus is below Loc. 002 & is above Loc. 004

Lateral extent Whole Area Max. thickness 10 cm. touches balk(s) N.E.

How does this Locus relate to all other loci it touches?:

as levelling course for 002 cobbles spread over brick & rubble fill of 004.

This Locus is contemporary with which loci mentioned above?:

001, 002.

How was this Locus formed?:

Layer of sand spread as levelling course for cobbles of 002 floor foundation & so cobbles would sink if were compacted → thin, soft

Pottery.

003 Basket #3 2 B.S coarseware fabric 1
(one white, 1 Pinkish colour)

my notes indicate this is
the content of Basket 2, Aug. 2
JCB.

—Javed

Text indicates that labels
have been switched

1984 - V.S

one mg white Alend-ejo

1 lump of iron

5/2

5/2
10/9

GENERAL IDENTIFICATION West Bath, Rm 2

Locus No. 004

Date (s) 3 August, 1982

Top levels ^{223.61} 223.46 Top plan 4; Bottom levels ^{223.45} 223.38 Top plan 6

Sections N & E Drawn by architect No. Photo No. 82-474

PHYSICAL DATA

What is it made of?: Silt, Bricks, Cobble.
Pebble size rock clippings

What size particles? Earth Color ^{of taste} 5 YR 4/4 Red brown.

<u>Features</u>	<u>Soil Layers</u>
Compass orientation _____	Direction & Degree of slope ^{5°} <u>Down to North</u>
____ courses high; ____ rows wide	Degree of compaction: <u>Hard - v. hard.</u>
Overall dimensions _____	Distribution of particles (e.g., random, laminated, graded bedding) <u>Random.</u>
How was it built?:	

STRATIGRAPHIC DATA

This Locus is below Loc. 003 & is above Loc. 005

Lateral extent Whole Area Max. thickness 8cm Touches balk(s) N, E

How does this Locus relate to all other loci it touches?:
Part of rubble of earth fill to make up level of floor (001) etc

This Locus is contemporary with which loci mentioned above?:
001 002 003

How was this Locus formed?: Intentional rubble of earth fill.

West Baths, Room 2

GENERAL IDENTIFICATION Fill.

Locus No. 005.

Date (s) 4 August, 1982

Top levels 223.45 223.38 Top plan C; Bottom levels 223.41 223.28 Top plan Final

Sections East only Drawn by architect no. Photo No. 82-587 on bottom

PHYSICAL DATA

What is it made of?: Earth.

What size particles? Silt, pebbles of schist, sand. Color 7.5 YR 4/6 Strong Brown.

<u>Features</u>	<u>Soil Layers</u>
Compass orientation _____	Direction & Degree of slope <u>/</u>
____ courses high; ____ rows wide	Degree of compaction: <u>Very hard</u>
Overall dimensions _____	Distribution of particles (e.g., random, laminated, graded bedding)
How was it built?:	<u>Random</u>

STRATIGRAPHIC DATA

This Locus is below Loc. 004 & is above Loc. Unexcavated & Sockle of Silt wall
Latera extent see final plan Max. thickness 10 cm Touches balk(s) N/E

How does this Locus relate to all other loci it touches?:

Runs over sockle of Silt wall & up to bottom level of West wall - w. wall seems to be founded on this material
004 junk thrown on top.

This Locus is contemporary with which loci mentioned above?:

Probably the 2 walls above. 004 - same fill.

How was this Locus formed?:

Intentional fill to raise level to construct floor.

The small probe excavated in 1982 by Guy Sanders in the S.W. corner of Loom #2 West Baths, was extended by Amy Michlin (1983) to an area of 1.56 m x 2. m. The impetus for this extension was to obtain further evidence (pottery) from under the sealed floor so as to date the West Bath complex. The datum point is a 8m nail in the ~~NW~~^{NE} wall +224.097 m. No features were visible before excavation began. The ~~NW~~^{NE} & ~~SE~~^{SE} walls form two bays of the excavated area. After removing the fill from the previous year's probe proper work began June 8, 1982.

Amy L. Michlin

Misobriga 1983
Room #2 W. Baths S.W. corner
June 8, 1983

No photos

Locus 001 - Basket 0
Top 223.68
Bottom 223.88

Pebble + cement floor, white cement
10 YR 8/1 white with sm. tile frags + grey
blue pebbles 7.5 YR 5/10. Flooring runs
up to S wall and slopes down (ca
5° to the W wall + drain? Floor is better
preserved next to S wall + deteriorates
as one moves S + E. This type of floor
covering can be found in several other
structures on the site (see Report ^{Philip}) - as
waterproofing + flooring in E. baths also.

NO POTTERY

NO MATERIAL CULTURE

No photos
Locus 002 - Basket 0
Top 223.88
Bottom 223.52

Layer of cobbles extending to a depth of
3-12 cm. upon which this cement +
pebble aggregate (001) was poured. These
cover the entire area and are fairly
loosely packed, perhaps in some sand
(Locus 003). Sizes range from 25 x 12 x 6,
9 x 6 x 4.

Note basket #'s were begun w/ Locus 003

Murobisiga 1983
Km. #2 W Baths S.W corner
June 9, 1983

no photos
LOCUS 003 ^{approx} Basket 1 (5 buckets)

Top ~~223.58~~ 223.58

Bottom ~~223.52~~ 223.52

Locus 003 seems to be the 'packing' material in which the statumen may have been pounded. It is mostly of sand size + somewhat damp, (from previous rains?) Some pebbles + schist are mixed in this sm. layer of soil which covers the entire excavated area. A very sm. amt. of ash was found in this locus. Two frags. of coarse ware body sherds were also recovered from this layer.

003 Basket 2 (5 buckets) - 1 lg. body sherd w/ 3 wheel ridges + black slip

NOTE - 2 baskets designated as special care was taken w/ this locus (previous excavation reported pottery) to scrutinize for pottery + amt. of earth ~~removed~~ removed.

Murobriga 1983
Km. #2 W. Baths S.W. corner
June 9, 1983

no photos
Locus 004 PB 3
Top 223.84
Bottom 223.33

As does the floor, Locus 004 slopes down to the ~~west~~ ^{west} (ca. 5°) Soil colour is 5YR 4/4 reddish-brown.

This seems to be a fill layer used to achieve the existing floor level.

NOTE: Previous excavation distinguishes two different loci 004 + 005. I do not make this distinction*.

* distinction in the fill layer that is - I believe the fill was deposited at one time + ∴ is deserving of a single locus #.

004 is a 'fairly' lg. layer of fill of sand size soil, (some decomposed brick looks sandy) + approx 30-40% of schist + bricks (some large) frags which covers the entire area of the ~~area~~ square.

(more of an 'area' rather than true lens -)

Within locus 004 are 2 lenses, of one of mortar + brick frags, the other of a sandy soil + brick frags (see Top Plan #). These lenses rest directly on top of Locus 005? I don't believe they hold any real significance, ~~they~~ ^{out} are ^{only} an integral part of 004 - fill. The top of Locus 004 revealed more terracotta pipe frags - not in any specific order or arrangement - See Top Plan #. Other frags of t.c. pipe were found throughout this locus.

Pottery:

1 lg. red slip? body sherd
1 frag. coarse ware - body sherd

me

minute amt. of bone.

Merobriga 1983
 Km. #2 S.W. corner W. Baths
 June, 10 1983

no photos
 LOCUS 004 PB IV
 Top ~~TOP PLAN #4~~
 Bottom

Continue removal of fill layer
 locus 004. It appears that the
 'lenses' continue + as previously
 assumed rest on a new locus.
 Saw more frags of pipe were ^{stone}
 found, but no sherds. The foundation
 line for the S^W wall continues
 across the area. Coming down on a
 new locus as 004 lifts off ca. level
 of top ^{of well} foundation course.

no photos
 LOCUS 005 PB V
 Top. SEE Top Plan #4
 Bottom

Silt + sand size earth predominately
 appears to have numerous inclusions
 of schist, some brick + sandstone.
 Colour reading for soil is difficult
 to take because of the ^{abundance} ~~presence~~ of
 schist, (10 YR 5/3 Brown). This locus
 appears to cover the entire area +
 follows the slope of the floor above.
 Plan is to first remove the sm. mortar
 + brick lens to determine if 005
 runs under this corner.

Musobriga 1983
 Em # 2 S.W. Corner W. Baths
 June 13, 1983

no photos
 LOCUS 004⁴ PB VI (MORTAR LENS)
 Top
 Bottom

(004)
 = incising removal of mortar lens

LOCUS 005 PB VII



Begin removal - soil very hard. 40-50% sm. schist frags
 Sev. ~~2~~ Pieces sigillata found + several body frags of coarse ware - also some bone. No foundation trench has appeared as of yet. 005 appears to cover the entire area + runs up both to the ^{west} ~~east~~ + south walls. Soil remains very hard w/ numerous inclusions of schist + sm. pebbles.

Certain the trench concentrations rubble brick

areas of show of differing hard brown earth w/ fewer inclusions

MC POTTERY - yes!
 2 pieces glass
 sev. bone frags



Mindoriga 1983

June 14, 1983

Trm.# 2 S.W corner W. Baths

no photos

LOCUS 005 PB 8

Top -84 -90
~~Bottom~~

Bedrock - Top

Continue removing fill layer 005. Shards are found predominately near the NE bulk in the looser rubble fill. Rubble extends through the area now as if in a wash pattern. Will remove rubble



lens first - see if ^{the} darker cleaner soil appears underneath. More rubble area ~~is~~ ^{may} be

LOCUS 006

Bedrock. Will follow the line & remove the remainder of 005 Rubble removed & bedrock-like ^{water} material appears against S W. Very dk. soil possibly running the direction of the old water channel dk. soil - Munsell (next pp.) very compact, slightly damp silt size.

lg. boulders make up a portion of the rubble against the SE bulk.

Pottery - sw. frag coarse ware
1 sm. frag sigillata

MC 5m. north of Yene

Winnebago 1983
Km. #2 S.W. corner W. Baths

June 15, 1983

Photo # 83.1 #3

locus 006 PB 8A

20948 90% - Bedrock & NO11

Top 223.207

Bottom 222.947 Munsell - 2.5Y1R

NO11 - fill of schist-
- Bedrock against ^{very concentrated} wall

+ extending into excavated
area see Top Plan # 5.

6/15 grey Will continue removal of
dk. earth locus 007 (much
less rubble) May be fill or
perhaps wash from hill.

locus 007 PB. 9

Top
Bottom

dk. compact soil ^{silt size} following the
N wall & NE balk. Munsell ^(damp)
colour, 10 YR 3/3 dk. brown.

Possible cutting for old drain
channel - have found now
that it covers entire area -
not the old drain channel.

Foundation course for S wall is
fully exposed & runs the length
of the excavated area. Will
continue down through locus
007

MC. Iron nail from
Wall.

1 lg tooth from PB 9

POTTERY - 1 coarse ware rim

1 " body frag.

Mexobriga 1983
Km # 2 W. Bello
June 16, 1983

LOCUS 007 PB 10

just below Top - 71
Bottom

Fill continues to go down,
compact soil contains inclusions
of ash, few bricks, mortar and
some Schist. Some concentration next
to the W. bulk.

POTTERY - 2 sm. common
wall body frags.
MC - total?

June 17 1983

LOCUS 007 PB 11

Final removal + cleaning
of area. Excavation termi-
nated at the levels
indicated on Top Plan # (FINAL)
of 007.

NO POTTERY

FINAL PHOTOS

Colour

83.5.35

C83.4.36 + 37

83.5.36

$$\begin{array}{r} 224,097 \\ \underline{70} \\ 357 \end{array}$$

$$\begin{array}{r} 224,097 \\ \underline{84} \\ 457 \end{array}$$

$$\begin{array}{r} 224,097 \\ \underline{60} \\ 497 \end{array}$$

Munobirga 1983

007 PB 12
Top: 222.927
Bottom: 222.717

July 4, 1983
Workman big picking
through 007.
Some Pottery

007 PB 13
Top: 222.717
Bottom: 222.647

July 5, 1983
Still in 007
both inset & outset walls are
continuing

Final section photo SE bank
83.9.6
C83.6.15

007 PB 14
222.647
222.607

July 6 1983
workman finishes to a final level
of 222.607
inset and outset foundation walls
continue to this level just as above.
Both walls also continue down
throughout the remainder of 007.

Room #2 West Baths South + West walls

South wall - excavated area exposed 2m. of original wall (approx. 40cm. in height exposed) of two courses stone and mortar construction. Stones average .26 x .16m w/ spaces filled by flat stone + some schist. Beginning with a top level of 223.367 and outlet from this S wall (13cm.) is a stone foundation sole-sloping 5° down to the north. Three courses of this sole are exposed; stones vary in size from .37 x .07 x .11m. → .26 x .15 x ? m. Mortar construction is used with slabs of schist layed between the courses of stone. Bottom level as exposed → 222.977m. (length)

West wall - exposed wall runs 1.60m in length and consists of two courses, one of very large stones, .48 x .20m - .45 x .20m, and one course of relatively thin stone, .25 x .07m, above which runs a course of repeating lg. stones (already exposed). One large block (.59 x .30 x ?) - see Final Top Plan - top level 223.67 Bottom 223.97 - juts out from the wall .07m. The stone's width is equal to the space taken by the two courses of stone previously described. Below this stone + exposed wall-stone inset 6cm is a foundation wall. This inset is 43cm high (as exposed) and constructed of a ^{white} ~~concrete~~ mortar w/ stone + schist courses (approx. 3 ^{courses} mortar so thick that stones are difficult to discern). Stones average in size ca. .32 x .10m.

The outlet sole of the S wall + inset foundation of the W. wall found in the ^{western} ~~center~~ of Rm. #2 at ^{all exposed} the appropriate levels.

MIR0616A 1983
GENERAL IDENTIFICATION Rm 2 W. Baths

Locus No. 001
Date (s) 6-8-83

Top levels 223.68 / 223.58 Top plan 1; Bottom levels 223.61 / 223.52 Top plan 1

Sections FINAL Drawn by architect no. Photo No. no

PHYSICAL DATA

What is it made of?: Cement w/ aggregate of pebbles + tile

What size particles? pebble + sand size Color pebble 754R 5/0 N5 grey
mortar 104R 8/1 white

<u>Features</u>	<u>Soil Layers</u>
Compass orientation _____	Direction & Degree of slope <u>north-east</u> <u>down</u> <u>50</u>
____ courses high; ____ rows wide	Degree of compaction: <u>very hard</u>
Overall dimensions _____	Distribution of particles (e.g., random, laminated, graded bedding) <u>random</u>
How was it built?:	

STRATIGRAPHIC DATA

This Locus is below Loc. cur & is above Loc. 002

Lateral extent entire area Max. thickness 6-10cm. Touches balk(s) NE

How does this Locus relate to all other loci it touches?: S+W walls

contemporary w/ 002 + S+W walls (it runs up against them).
Cement laid directly over 002

This Locus is contemporary with which loci mentioned above?:

locus 002 S+W walls

How was this Locus formed?:

man-made flooding of cement + pebbles paved over a
stakumen layer + then smoothed over.

MIROBRIGA 1983
GENERAL IDENTIFICATION Km. 2 W. Baths

Locus No. 002
Date (s) 6-8-83

Top levels ^{223.66} ~~223.58~~ Top plan 1; Bottom levels ^{223.32} ~~223.52~~ Top plan 1

Sections N+E Drawn by architect no Photo No. none

PHYSICAL DATA

What is it made of?: cobbles (stones)

What size particles? cobble-size 24x10x4 Color 10 yr 8/1 white
10x8x5 (approx 1cm cobbles)

<u>Features</u>	<u>Soil Layers</u>
Compass orientation _____	Direction & Degree of slope <u>5° NE</u>
____ courses high; ____ rows wide	Degree of compaction: <u>compact</u>
Overall dimensions _____	Distribution of particles (e.g., random, laminated, graded bedding)
How was it built?:	<u>random</u>

STRATIGRAPHIC DATA

This Locus is below Loc. 001 & is above Loc. 003

Lateral extent entire area Max. thickness 9-10cm. Touches balk(s) N+E

How does this Locus relate to all other loci it touches?:

cobbles laid overfill to form stumen of floor -001 then poured on top + smoothed over.

This Locus is contemporary with which loci mentioned above?:

001

How was this Locus formed?: manmade -cobbles packed + pounded in area to form foundation of floor.

MIROBRIGA 1983
GENERAL IDENTIFICATION Km. 2 S.W. corner
W. Baths

Locus No. 003
Date (s) 6/9/83

Top levels 223.637 223.567 Top plan #2 ; Bottom levels 223.527 223.557 Top plan #3

Sections N+E Drawn by architect no Photo No. none

PHYSICAL DATA

What is it made of?: soil

What size particles? sand size Color 5YR 4/4 reddish brown

<u>Features</u>	<u>Soil Layers</u>
Compass orientation _____	Direction & Degree of slope <u>5° ↓ NE</u>
_____ courses high; _____ rows wide	Degree of compaction: <u>fairly loose</u>
Overall dimensions _____	Distribution of particles (e.g., random, laminated, graded bedding)
How was it built?:	<u>random</u>

STRATIGRAPHIC DATA

This Locus is below Loc. 002 & is above Loc. 004

Latera extent entire area Max. thickness 145cm Touches balk(s) N, E

How does this Locus relate to all other loci it touches?:
contemporary w/ 001 + 002 - used as levelling + packing material for cobbles to be panned.

This Locus is contemporary with which loci mentioned above?:

001 002

How was this Locus formed?:

Sand spread over area so cobbles could be firmly packed + form a suitable foundation for the cement floor.

MIROBRIGA 1983
GENERAL IDENTIFICATION Rm 2 S.W. corner
W. Baths

Locus No. 004
Date (s) 6/9/83 - 6/13/83

Top levels ~~223.537~~ 223.487 / Top plan #3 ; Bottom levels ~~223.377~~ 223.327 Top plan #3

Sections NE Drawn by architect no. Photo No. none
P31.3

PHYSICAL DATA

What is it made of?: bricks, cobbles, mortar,
schist, earth

What size particles? silt size Color soil 5YR 4/4 Red Brown

<u>Features</u>	<u>Soil Layers</u>
Compass orientation _____	Direction & Degree of slope <u>5° down to NE</u>
____ courses high; ____ rows wide	Degree of compaction: <u>very compact</u>
Overall dimensions _____	Distribution of particles (e.g., random, laminated, graded bedding) <u>random</u>
How was it built?:	

STRATIGRAPHIC DATA

This Locus is below Loc. 003 & is above Loc. 005

Latera extent entire area Max. thickness 13 cm Touches balk(s) NE

How does this Locus relate to all other loci it touches?:
Part of a rubble fill used to achieve the existing
floor (001) level.

This Locus is contemporary with which loci mentioned above?:

001, 002, 003

How was this Locus formed?:
intentional rubble fill

MILOBALHA 1983
GENERAL IDENTIFICATION Rm 2 S.W. corner
W. Baths

Locus No. 005
Date (s) 6/14/83

Top levels ^{223.377} ~~223.327~~ Top plan #4 ; Bottom levels ^{223.207} ~~223.167~~ Top plan #5

Sections NE Drawn by architect NO Photo No. NONE

PHYSICAL DATA

What is it made of?: earth + some ^{scattered} rubble (2 lg. boulders)

What size particles? ^{mostly silt soil} ~~shist, brick, stone~~ Color 7.5Y/R 4/6 strong brown
_{pebble size}

Features

Compass orientation: _____
_____ courses high; _____ rows wide
Overall dimensions: _____
How was it built?: _____

Soil Layers

Direction & Degree of slope down 5° to NE
Degree of compaction: very hard
Distribution of particles (e.g., random, laminated, graded bedding)
random

STRATIGRAPHIC DATA

This Locus is below Loc. 004 & is above Loc. 006 + 007

Latera extent entire area Max. thickness _____ Touches balk(s) NE

How does this Locus relate to all other loci it touches?:

005 continues as a level of fill w/ less rubble as 004

This Locus is contemporary with which loci mentioned above?:

004 + both S + W walls

How was this Locus formed?: intentional fill to raise floor level.

POTTERY

6.5
explanation tag

well w/in
all first cent. (wheel made)
not early because would find
some non wheel forms

Basket No.	Date Dug	Level	Field Reading	Reg. Sherds
6A	6-14-83	005	6 frags same amphora	→ write basket # #312
6A		"	5 coarse ware chips of (1 rim) mixed red + white fabric	
6A		"	likely water pipe.	
6A		"	1 thick frag coarse ware fabric 3 wheel made (at least 1st A.D.)	
6A		"	1 brick frag	
7	6-13	005	8 joining frags plus 1 handle	
"		"	+ one add. body sherd of wheel made white Alentejo (coarse ware fab. 1)	
"		"	1 frag. coarse ware fab. 2? also wheel made	
"		"	1 frag. pink Alentejo wheel made C.W.F. 1 1st cent.	
"		"	2 joining frags + one of C.W.F. 3	
"		"	1 frag. C.W.F. 5	
"		"	1 rim frag. H ₂ O pipe	
"		"	3 different unidentified coarse ware frags including 1 base of possible local cooking pot (Fabric compare Sines Museum)	

MATERIAL CULTURE AND OBJECTS

Assoc. Pottery

MC	Reg. No.	Basket No.	Identification
GS		7	2 frags. window glass.
B		7	8 frags bone
B		8	1 sm. frag. bone

MIROBRITA 1983

GENERAL IDENTIFICATION RM 2 S.W CORNER
W. Baths

Locus No. 006

Date (s) 6/15/83

Top levels 223.207 Top plan #5; Bottom levels 222.947 Top plan FINAL

Sections NE Drawn by architect no Photo No. none

PHYSICAL DATA

What is it made of?: Schist Frag

What size particles? pebble + granule Color 2.5 YR 6/1.5 'gray'

<u>Features</u>	<u>Soil Layers</u>
Compass orientation _____	Direction & Degree of slope _____
____ courses high; ____ rows wide	Degree of compaction: <u>very compact</u>
Overall dimensions _____	Distribution of particles (e.g., random, laminated, graded bedding) <u>random</u>
How was it built?:	

STRATIGRAPHIC DATA

This Locus is below Loc. 005 & is above Loc. 007

Latera extent see Top Plan #5 Max. thickness 23cm. Touches balk(s) S wall
soile

How does this Locus relate to all other loci it touches?:

lens of schist below 005 above 007 which may be + concentrated area of fill.

This Locus is contemporary with which loci mentioned above?:

004, 005

How was this Locus formed?:

intentional fill of schist which were perhaps left from cutting down the bedrock to construct some adjacent wall or other portion of the building.

MILOB RIBA 1983
GENERAL IDENTIFICATION RM 2 SW CORNER
W. Baths

Locus No. 007
Date (s) 6/15-17/83

Top levels 223.057 / 223.167 Top plan # 5 ; Bottom levels 222.957 / 222.947 Top plan FINAL

Sections N+E Drawn by architect no Photo No. _____

PHYSICAL DATA

What is it made of?: earth sm. bits of schist + sh + brick.

What size particles? silt size Color 10 YR 3/3 dk. brown

<u>Features</u>	<u>Soil Layers</u>
Compass orientation _____ _____ courses high; _____ rows wide Overall dimensions _____ How was it built?: _____	Direction & Degree of slope <u>5° ↓ north</u> Degree of compaction: <u>very compact</u> Distribution of particles (e.g., random, laminated, graded bedding) <u>random</u>

STRATIGRAPHIC DATA

This Locus is below Loc. 006.005, 4321 & is above Loc. unexcavated

Lateral extent entire area Max. thickness unexc. Touches balk(s) NE

How does this Locus relate to all other loci it touches?:

more compact fill level, perhaps partially composed of existing wash at time of construction + Roman fill (brick etc.) present.

This Locus is contemporary with which loci mentioned above?:

004, 005, 006, (at least partially) + S + W wall?

How was this Locus formed?: intentional fill.

POTTERY

Basket No.	Date Dug	Level	Field Reading	Reg. Sherds
9	6/15	007	2 frags. wheel made white Alentejo CWF 1	} at least 1st c. A.D.
			1 frag. CWF 3 also wheel made	
			1 sm. course ware rim unidentified.	
10	6/16	007	2 unidentified course ware frags. Hand made	
11	NO POTTERY			
12	7/4	007	2 pieces handmade CW4?	
"	"	"	1 piece imported amphora fabric	neto
"	"	"	1 imported amph. rim, probably African 2nd-3rd c.	↓ # 318

MATERIAL CULTURE AND OBJECTS

MC	Reg. No.	Assoc. Pottery Basket No.	Identification
B		10	1 bone frag.
B		9	1 lg. tooth

MIRDEBRIGA '83
ROOM 2, S.W. CORNER
West Baths
JUNE 8, 1983

TOP PLAN #1
TOP 001

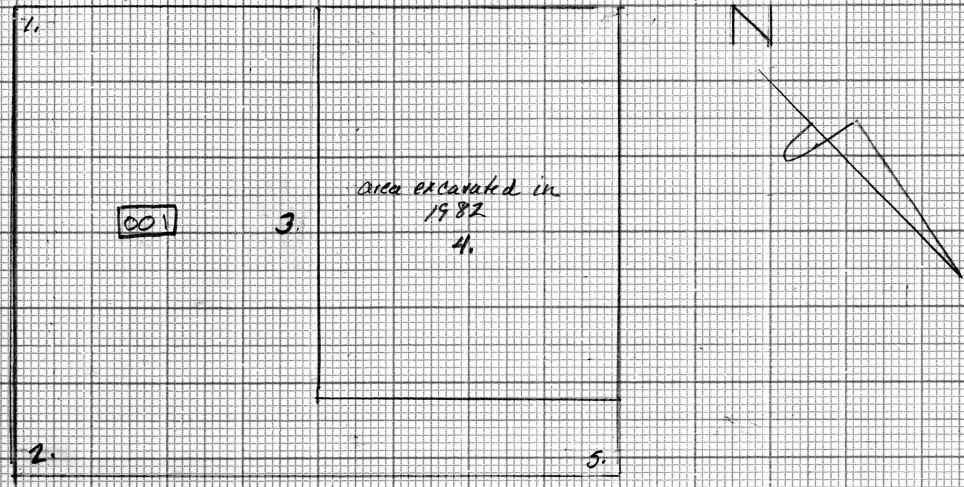

- 1. 223.667
- 2. 223.547
- 3. 223.607
- 4. 223.317
- 5. 223.647

TOP PLAN #2
TOP 003

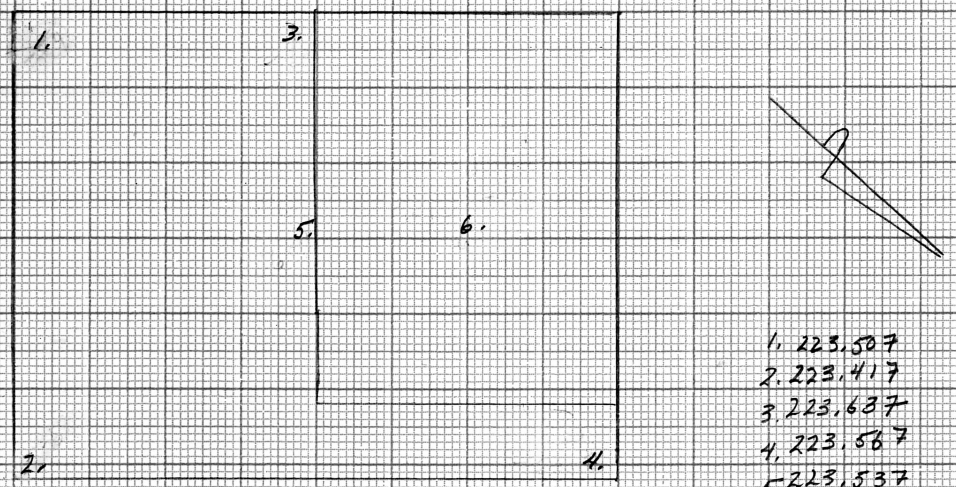

- 1. 223.507
- 2. 223.417
- 3. 223.637
- 4. 223.567
- 5. 223.537
- 6. 223.317

TOP PLAN #3

TOP 004 BASKET 1

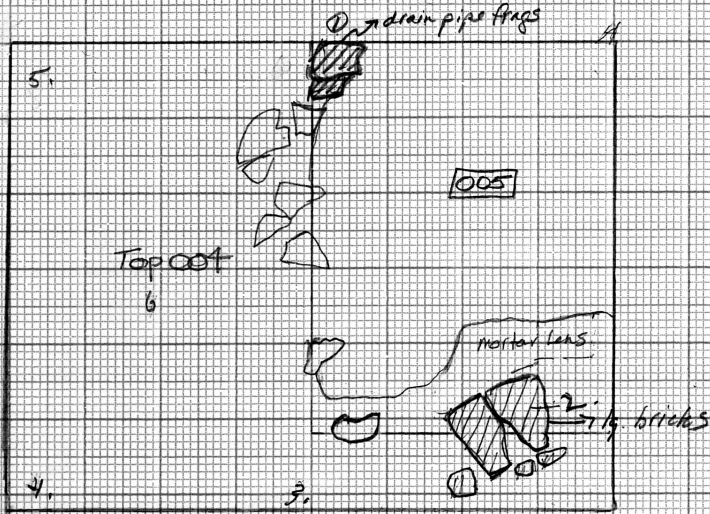

- 1. 223.537
- 2. 223.517
- 3. 223.457
- 4. 223.447
- 5. 223.557
- 6. 223.527

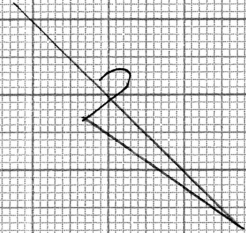

TOP 004 BASKET 2

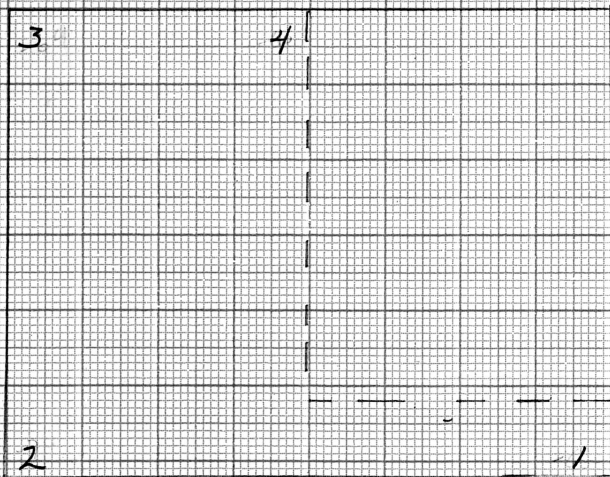

- 1. 223.437
- 2. 223.397
- 3. 223.457
- 4. 223.460

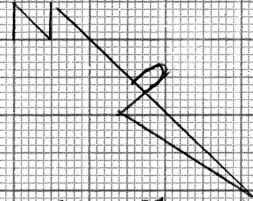

TOP PLAN # 4

MILBRIDGE 1983
RIP # 2 S.W. CORNER W. BANKS
JUNE 10

TOP 005

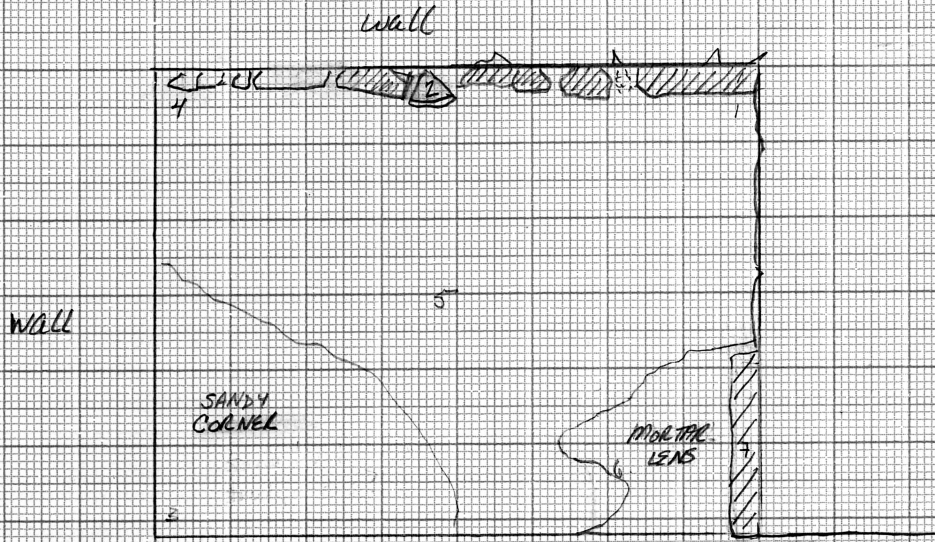

- 1. 223.377
- 2. 223.297
- 3. 223.257
- 4. 223.257
- 5. 223.327
- 6. 223.437
- 7. 223.67

ENTRANCE

Cement & pebble floor

Wall

Wall

SANDY
CORNER

MORTAR
LENS

MIROBRIGA 1983
JUNE 15 1983
RM #2 S.W. CORNER
W. BATHS

TOP PLAN #5

007 Basket 9

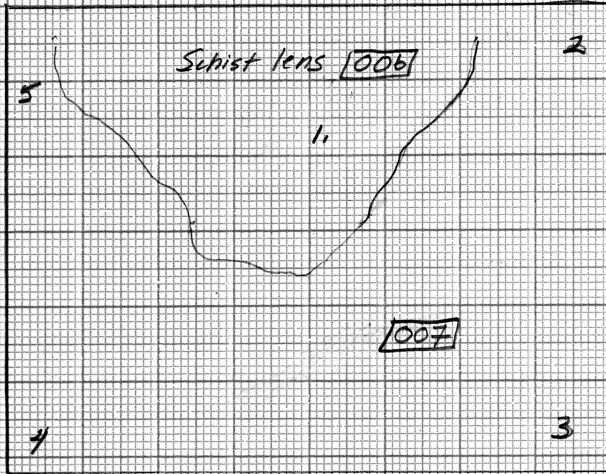

- 1. 223.207
- 2. 223.167
- 3. 223.167
- 4. 223.057
- 5. 223.047

LOCUS 007 BASKET 10

Top

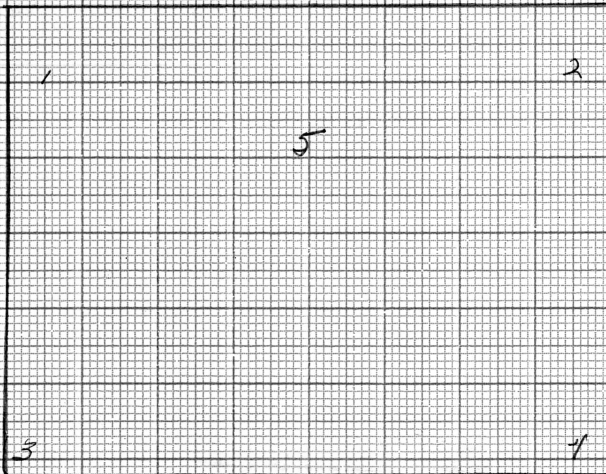

- 1. 223.087
- 2. 222.967
- 3. 223.097
- 4. 223.027
- 5. 223.037

MIROBRIGA '83
JUNE 17, 1983
RM. #2 S.W. CORNER W. BATHS

FINAL TOP PLAN
LOCUS 007

SOUTH WALL

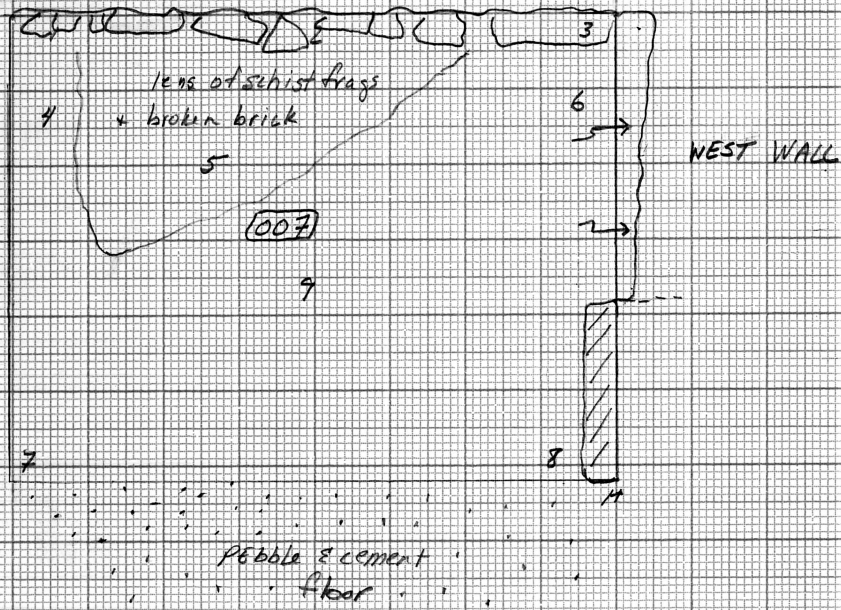

- 1. 223, 217
- 2. 223, 297
- 3. 223, 367
- 4. 222, 947
- 5. 222, 947
- 6. 222, 947
- 7. 222, 917
- 8. 222, 947
- 9. 222, 927
- 10. 223, 547
- 11. 223, 637

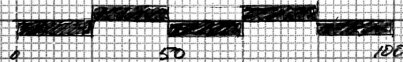

SCALE 1:25

SE
Exterior
E. Basin, Part 2

1.
Niobriga 1983

West Baths, Exterior
Southeast

June 24

Workmen began clearing fill from top of SE wall of latrine. From latrine junction of two walls can be seen. Aim to find out whether retaining wall between the two baths turns corner here to form SW wall of portico around East Baths. Fill descends to lower level ^{modern} where steps had been cut for access to Service Area. Bench at base of retaining wall continues into fill and being exposed as SE face of wall cleared.

Locus 001

Basket 1

Dark earth and stones tumbled from the wall. Continuation of retaining wall to south exposed.

At 221.297 m. top of wall running to south east at corner of retaining wall. Continued removing fill to south at level of top of SW wall of portico in order to expose top of walls of West Baths in this area. Large ashlar block uncovered at 221.572 m. forms corner of building here.

West Baths, Exterior
Southeast

June 27
001
Basket 2
no pottery

Continued removing fallen wall
plaster from against the walls of
the room and clearing off the
face of the wall
Continued workmen digging on
exterior of West Baths east of Room
4 to expose the upper part of
the walls of the building here. A
vertical channel cuts in the inner
face of the pool wall of Room 4.
Hope to elucidate this and also
understand the construction phases of
West Baths and retaining/partition wall
of East Baths. Fill consists of earth,
stones fallen from walls, chunks of mortar
flooring (ca. 0.30 m. L.).

SE wall of pool in Rm 4 is
broken away ^{in center}. Bricks on either side
of break probably preserved remains of
2 windows.

June 28, 1983

West Bath, Exterior

Southeast

Continue excavation in this area behind walls of West Bath.

Locus 002

New locus since now below top level

Basket 3

although does not appear to be any

nor pottery

difference in fill. Still stones & block

loose earth, also small clumps of
moss. top level 221.322 sloping

down to 221.097 south of return of
retaining wall. ^E Wall of pool in Rm

4 broken away in center. Now down

behind vertical channel that can
be seen from inside the building

Many large stones removed from

immediately behind, ^{to} E. of area

Level at end of day 223.637

0.60 m higher than threshold of
service Area of West Bath.

June 29, 1983

West Baths, Exterior
Southeast

Locus 002
Basket 4

Continued workmen going down in this area in hopes of ~~finding~~ ^{reaching} Roman floor level. Another ashlar block uncovered at corner with rusticated treatment on SE face, although SW face is smooth.

Brick coursing of SE wall of pool in Rm 4 now visible.

Some pottery, lead and bone frags in fill. Also corner of lunette revetment plaque P.L. 0.23, P.W. 0.24. Th. 0.033-0.04.

Level at end of day 223.267.

June 30

Locus 002
Basket 5

Continued workmen in this area. Level reached yesterday equals top of footing visible in latrine on north side of wall. Took a 1.50 m. wide strip along face of east wall of Rm 4 plunge and continued here. Possibly fewer large stones in fill. Brick frag of long thin type found in Rm 14. W. 0.16, P.L. 0.30, Th. 0.04.

West Baths, Exterior
Southeast

June 30
Locus 0A3
Basket 6
Photos
83.7.6 and 7

At 223.162 m reached top of short wall running east up to SE wall of Room 4. A possible platform or some kind of built structure lies to the north in the corner. ~~New locus for fill east of wall and platform.~~ Cleaning off around structures to define them before changing locus and Basket.

East Baths
Locus 001
Basket 1

While cleaning ^{above} here started 2 workers cutting back fill left in courtyard of East Baths in SW corner - to expose bench. Much fallen plaster on top of bench including some painted fragments

West Baths, Exterior
Southeast

July 1

Locus 002
Basket 6

Cleaned vertical channel in SE wall of
Rm 4. pool, Filled with fallen stones,
brick frags. and earth, 1 cover tile frag.
in floor of channel some brick fragments
laid flat. Some mortar with brick
aggregate on walls of channel at low level.

Locus 003
Basket 7

Began excavation of tumbled stones and
brick fragments N and E of diagonal wall
and possible platform. Top level 223.122
^{7.5YR 4/6}
Brown earth - 1 brick frag Th. 0-038 other
not measured - brick and stone chips, stones ca.
0.20m in length, Below stones reached layers of earth.

East Baths
Portico.

Locus 001
Basket 2

Continued workmen cutting back
fill to SW corner over bench and
cleaning off floor of portico in this
area. Much fallen plaster over floor, but
not painted. Probably down into Locus 002,
but took all together as difficult for
workmen to distinguish modern hill wash.
Took a cut 1.50m ^{from portico wall} ~~wide~~ approximately
to where the steep slope begins on the east

West Baths, Exterior SE

Locus 004
Basket 8

= 222.802

Layer of earth - no large stones
visible; much sand. Lump seem to
flake off, stones lying flat, some slate
(-0.32 below bricks of platform). Bricks of platform
have ended. Rest on stones scale, 3 courses preserved.
much charcoal in N corner - finer pottery shards

July 1

West Baths
Exterior, SE
Locus 004
Basket 8

Perhaps coming down on another level.
Brick frags laid flat, also some slate
At end of day reached top of a
second wall at right angle to post
and diagonal to wall of building.
Top level 222.782.

July 4

Locus 004
Basket 9

Some fill remains over continuation of
new wall to SE. Began removing with
Basket 9. Top level 222.782. Much
charcoal in fill, ~~see~~ slate and brick
frags. Hard level. Wall does not
appear to be continuing. Some iron
frags. coin.

Black fill appears to be continuing
under stones which we thought to be
extension of wall "1". Decided to
dig south of wall "1" which may be broken
away, too.

Locus 003
Basket 10

Top level 223.102
Large stones, brick frags. Much charcoal
wall "1" apparently broken away. Removed
3 large stones which were resting on
fill of same kind as 003. 003 and
004 probably same locus. Will take
fill down to level reached with
Basket 9 222.682

East Baths, Portico

July 4

Locus 002

Basket 3

Still some fill remaining against ^{lower} NE face of NE wall of Portico and on top of bench which continues up to wall although it does not turn corner. Locus 002 for about 50 cm of fill in height adhering to face of wall and \approx ca. 0.10 m thick on bench. At base of NE wall of portico a rounded mortar masonry seals junction of wall and floor.

Excavation cut back hillwash south of Room 10 to uncover stub of wall here which was on de Almeida's plan. Wall is in line with SE wall of Room 10.

Basket 4
no pottery

Removed wall plaster on bench at 1.30 m from corner - w. ca 0.75m

Photos:

83.8.4 and 5 Final photos of portico.

9 small frags of nondescript painted plaster.

West Basin, Exterior, SE.

July 5

83.8.6

Locus 004

Basket 11

Photo of level reached at end of July 4, 222.682. Continued here with Basket 11. Locus 3 may contain both Locus 002 and 004. Locus 004 covers broken ends of both walls and continues under platform between them. Many bones coming up and quite a lot of pottery. Fill blackened with charcoal. Bricks ^{frag} of long type used for screen wall. Flat-size stones.

Reached 'bedrock' in north of part of trench at 222.40 m. Junction of two walls preserved at this level. Continued excavation to south. Reached bedrock at 222.482.

Final Photos:	83.10.13	from above / to NW.	c 83.6.30
	.14	from above / to NE	c 83.6.31
	.15	" " / to SW	.32
	.16	SW bank to SW	.33
	.17	SE bank to SE	
	.18	General view of whole area from above / to north	c 83.7.1
	.19-21	Details of corner	
	.22	Entire area, to E.	c 83.7.2

July 10

Final description.

West Baths, Exterior

SE.

walls of the West Baths. Th. 0.59m.
 SE wall Run 4, plumb: 3 course of bricks
 ht. 0.14-0.15. Level bottom edge 223.316
 . At ~~0.186~~ 1.86 m. N corner narrow
 brick lined channel runs through thickness of
 wall. W. channel 0.135. Bricks preserved 4.
 6 courses 0.34. Bottom of channel formed by
 lowest course of brick coursing in wall.
 Bottom lined with coarse white cement
 on which are laid brick mgs.

At 1.05 above top of brick coursing
 in wall 2 brick courses partially preserved
 beginning at 0.42 from N. corner. Indicate
 a window?

North East wall of trench: L-1.90m. W. 0.59
 Bricks at 0.57 m above diagonal wall of a
 trench. At level of P. top of diagonal
 wall two courses of bricks visible ending at
 0.90 from N. corner. East corner of wall
 preserves ~~4~~ ashlar blocks in header -
 sketches arrangement 0.7, 0.45, 1.15, lowest
 not fully exposed. Surface on S side
 level, but pick marks visible. ~~to~~ Junction
 of 2 walls at W - clearly bond. Same
 type of mortar visible on upper exposed surface

0.73 x 0.46;
 0.45 x 0.96
 0.15 x 0.33

W. Baths, Exterior, SE

of both walls.
 wall turns to NE - forming S corner of latrine. ^{W. 0.63} Ashlar blocks on this side: 3rd from top dressed down on upper and south edge 0.07-0.08 W. Center left rough. NE extension of this wall L. 1.15 - abuts S corner of portico of East Baths. Not flush with NW face within latrine but set back 0.04 m. ~~On~~ Between end of wall and SW face of portico wall ca-0.04-0.06 m. gap now filled with mud.

Portico wall exposed for L. 1.50. Large ashlar block at corner 0.40 x 0.36 x 0.38. Wall constructed of stone and ~~some~~ slate, W. 0.48-0.50.

Structures within trench:

Two walls built at an angle to walls of bath but forming a right angle to each other. Built largely of slate, ^{and some brick} but also stone, ^{dry laid or with mud mortar}. Bond with each other at E. Abut walls of Bath. W. 0.32-0.37, Max P.H. 0.57 (S. wall) 0.28 N. Both rest on pieces of bedrock which probably from the roof of the water channel below.

Between two walls a platform P.H. 0.33 L. 1.27 (against wall of Bath). W. 0.58 N, 0.68 S.

Construction: stones, bricks, white mortar.

~~The bricks~~ One complete brick 0.20 sq. M-0-042.

Floor of trench. At 1.18 from wall
of bath bedrock appears cut for water
channel. At 1.32 along N. wall line also
apparent. Area was too narrow to
investigate further.

East Baths, Portico.

Bench preserved up to NE face of SW wall of portico. W. 0.24. H. 0.505. Thick layer of white mortar with brick aggregate fairly well preserved on upper surface, well preserved on face where 0.03 m th. Construction of bench here visible only on upper surface for 2.00 m from SW wall. For 1.63 m small (0.15-0.20 in L) stones and slate frags. laid flat from the upper outer course. At 1.63 m 3 bricks from upper course for 0.70 m. At 2.0m from SW wall the brick coursing for the face of the bench is visible.

Large mortar molding seals junction of SW wall and floor. H. 0.11, W. 0.16. Same type of mortar as floor of courtyard seems to be same construction. ~~Not clear~~ ^{seems to} whether ramp under the mortar facing on the bench.

Misobria 83
West Batus
Exterior, SE
June 24
June 30

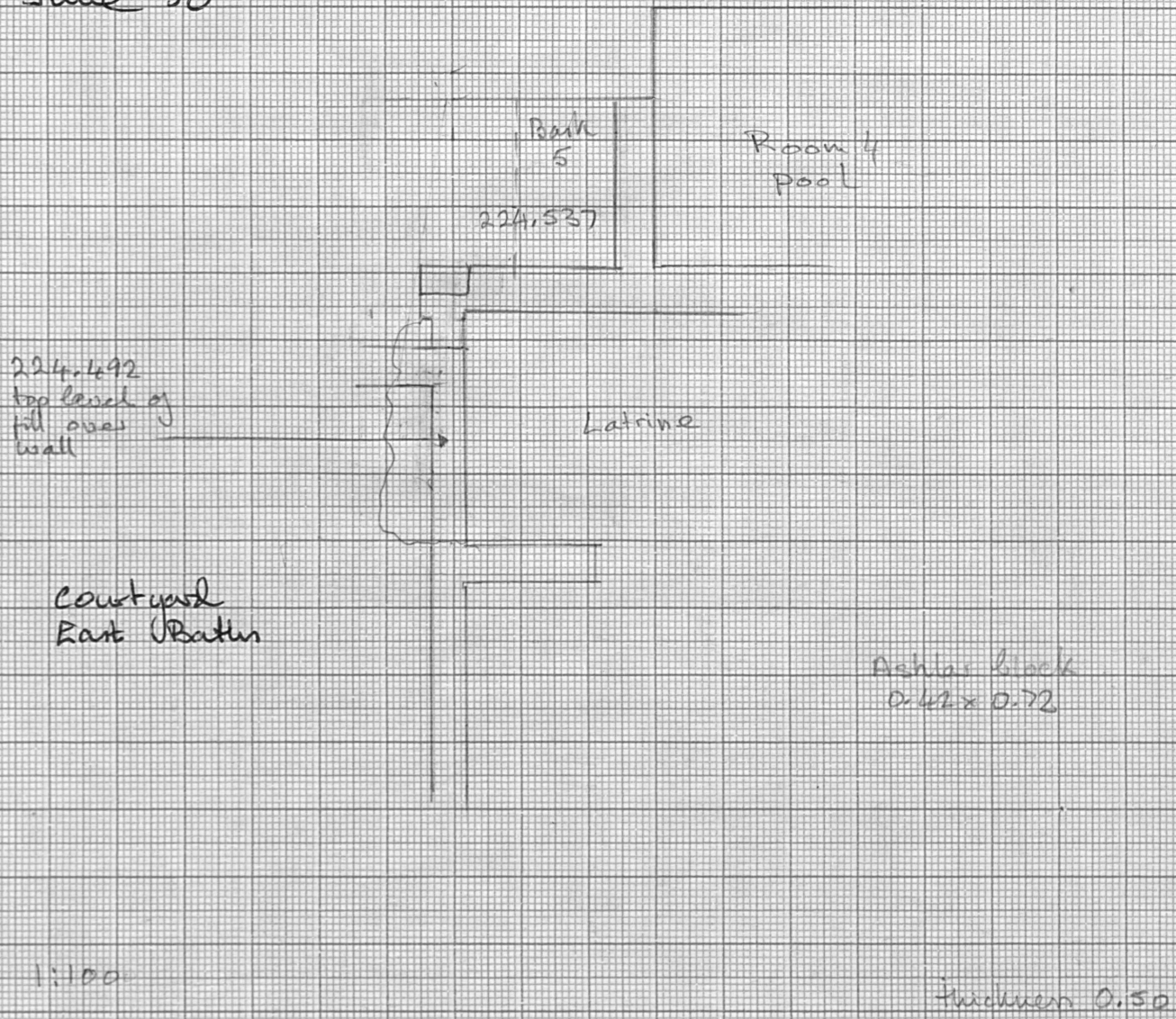

1:100



W. Batus, Extencor
Southeast

July 1, July 4

1:25

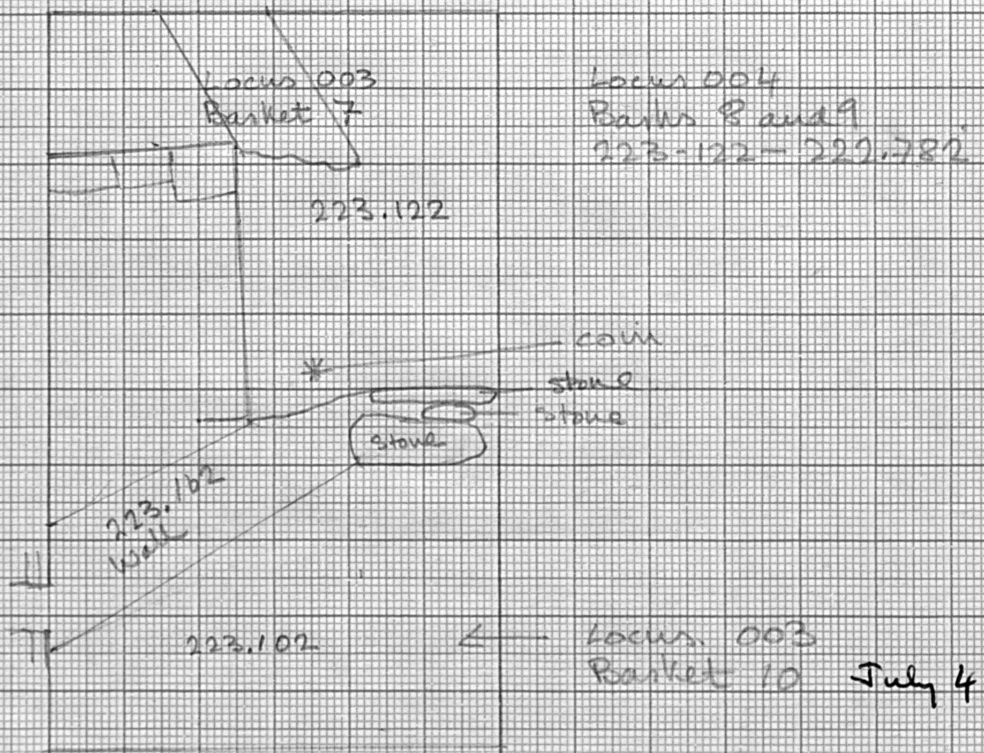

MIROBRIGA 1983, Extension SE
SOUTH BALKIC
AMY L. MEHLIN
SCALE 1:10

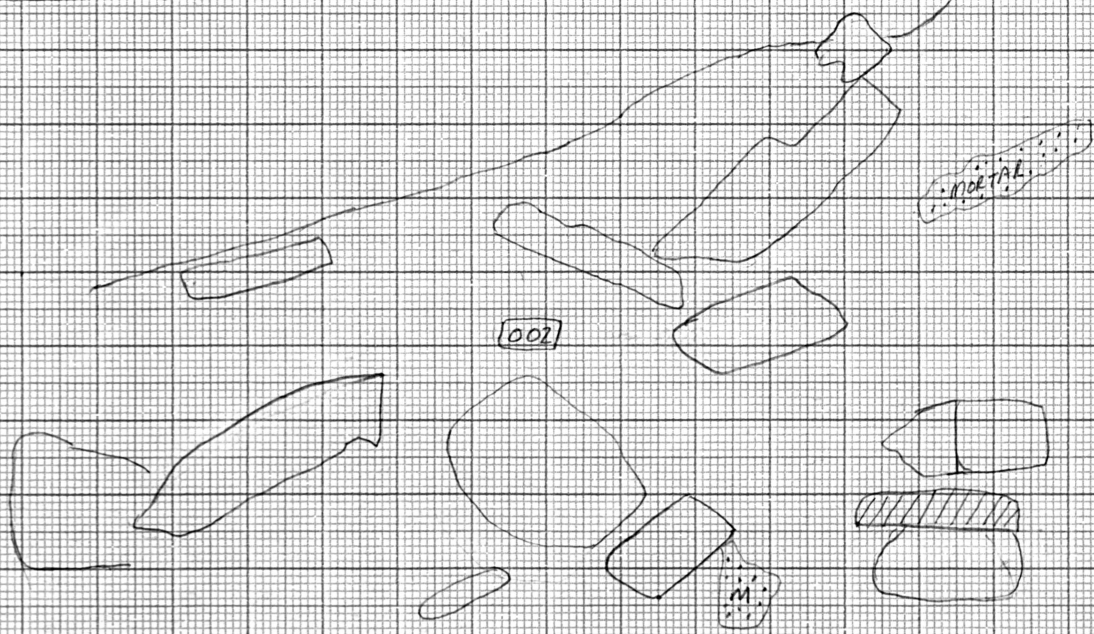
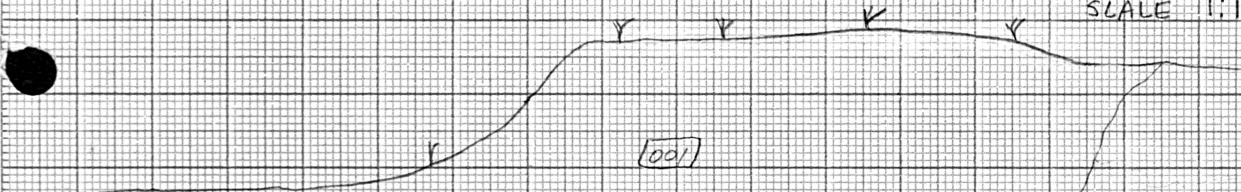

→ approx
end of
W. wall

223.417

DATUM
223.412

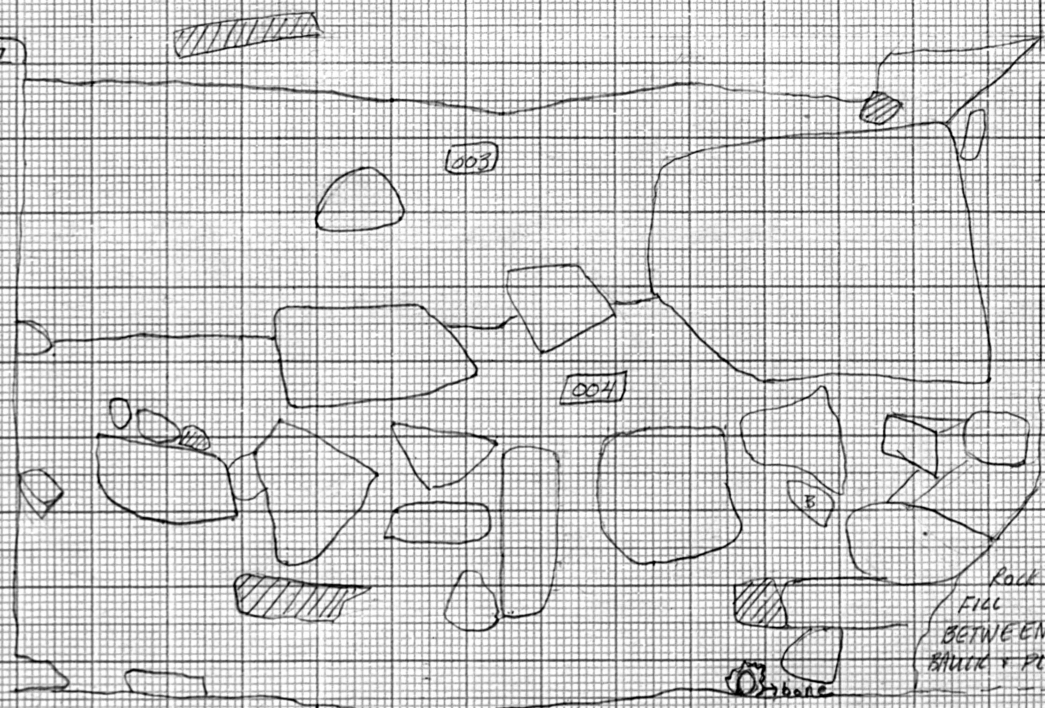

→ 223.200

Roll
Fill
BETWEEN
SPACE & PLATFORM

base

FINAL TOP PLAN 1:25 Mirdorjia 1983, Extension SE

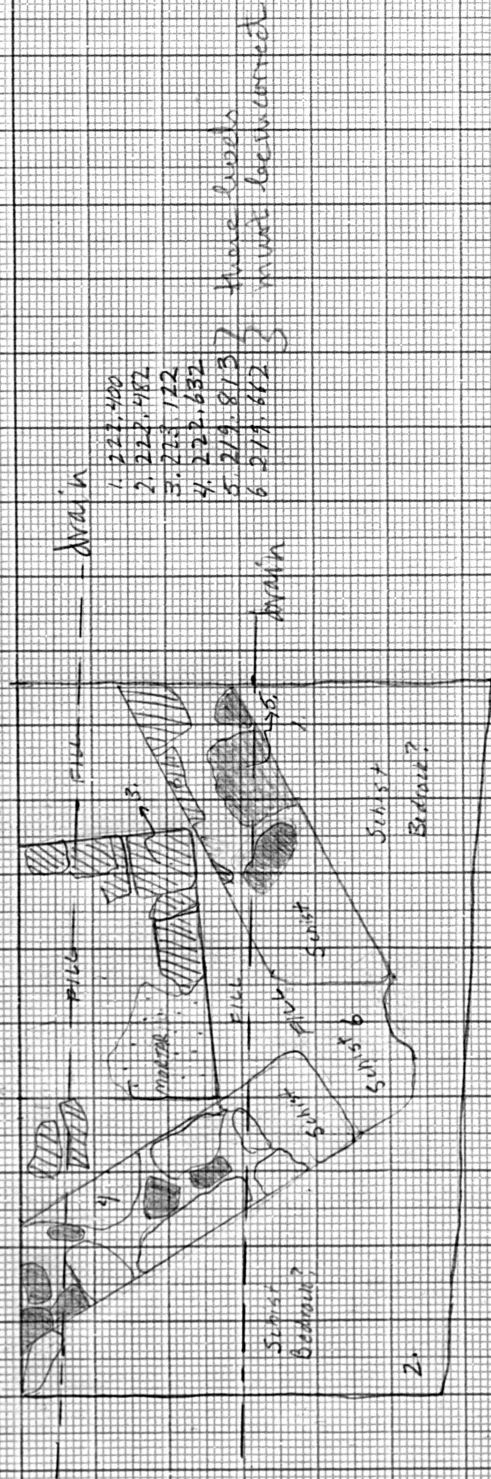

- 1. 222.400
- 2. 222.482
- 3. 222.122
- 4. 222.632
- 5. 229.813
- 6. 229.812

These levels
must be corrected

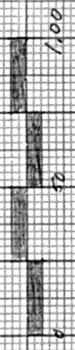

Scale 1:25



GENERAL IDENTIFICATION *West Basin*
Exterior, Southeast

Locus No. *001*
Date (s) _____

Top levels *224.537* Top plan _____; Bottom levels _____ Top plan _____

Sections _____ Drawn by architect _____ Photo No. _____

PHYSICAL DATA

What is it made of?: *earth, stones, some chunks of flooring (white mortar with brick aggregate)*

Yellowish brown

What size particles? *fine* Color *10YR 5/4*

<u>Features</u>	<u>Soil Layers</u>
Compass orientation _____	Direction & Degree of slope _____
____ courses high; ____ rows wide	Degree of compaction: _____
Overall dimensions _____	Distribution of particles (e. g. , random, laminated, graded bedding)
How was it built?:	

STRATIGRAPHIC DATA

This Locus is below Loc. */* & is above Loc. *002*

Latera extent _____ Max. thickness _____ Touches balk(s) _____

How does this Locus relate to all other loci it touches?:

Later than 002

This Locus is contemporary with which loci mentioned above?: */*

How was this Locus formed?: *Fill washing down from hill.*
Building falling down.

GENERAL IDENTIFICATION

W. Balks, Exterior SE

Locus No. 002

Date(s) June 29 - July 1, 1983

221-322

Top levels 221.097 Top plan _____; Bottom levels 223.162 Top plan _____

Sections ✓ Drawn by architect _____ Photo No. _____

PHYSICAL DATA

What is it made of? earth, tumbled stones, brick fragments, small chunks of wood.

What size particles? _____ Color brown/black

<u>Features</u>	<u>Soil Layers</u>
Compass orientation _____	Direction & degree of slope _____
____ courses high; ____ rows wide	
Overall dimensions _____	Degree of compaction <u>loose</u>
How was it built?	Distribution of particles (e.g., random, laminated, graded bedding) <u>Random</u>

STRATIGRAPHIC DATA

This Locus is below Loc. 001 and is above Loc. 003

Lateral extent _____ Max, thickness _____ Touches balk(s) _____

How does this Locus relate to all other loci it touches?

This Locus is contemporary with which loci mentioned above?

How was this Locus formed?

W. Baths, exterior SE
Locus 002

POTTERY

Basket No.	Date Dug	Level	Field Reading	Reg. Sherds
4	June 29	including	7 frags CW 4 badly 3 joining pr-rim 1 frag CW 3	burned (wheel made pre-Roman)
			1 rim of Sines clay base	
			1 amphora handle, Roman, probably Dressel 6, late 1st c. or later	
			1 sherd unident. semi-fine	
5	June 30		4 frags CW 4 join + Base 4 1 base CW 4; 1 possible rim CW 4; 8 frags CW 3 wheel made; 1 pitcher shoulder with handle attachment, unknown fabric undated; 2 joining & 1 non-joining wall frag of imported amphora, similar amphora handle to Basket 4; 3 white Alentejo CW 1 including everted hem. rim & body frag; 2 Sines cooking plate? (2 brick frags thrown) 1 frag ARS 4th-8th c. type	
			#356 R →	
6	July 1	A	1 rim ARS? lid	#350

MATERIAL CULTURE AND OBJECTS

MC	Reg. No.	Assoc. Pottery Basket No.	Identification
		4	✓ 1 window glass frag
			✓ 7 bone frags, 1 tooth
			✓ 2 lead frags. 1 of which large
		5	✓ 24 bone frags, 6 teeth

Many large stones, brick traps
trap of flooring. SYR 6/4

W. Bath, Exterior SE

GENERAL IDENTIFICATION

Locus No. 003

Date (s)

Top levels 223.102 223.122 Top plan _____; Bottom levels 22.802 Top plan _____

Sections _____ Drawn by architect _____ Photo No. _____

PHYSICAL DATA

What is it made of?: Tumbled stones and brick fragments - earth, small pieces of slate

What size particles? _____ Color 7.5 YR 4/6

<u>Features</u>	<u>Soil Layers</u>
Compass orientation _____	Direction & Degree of slope _____
____ courses high; ____ rows wide	Degree of compaction: <u>loose</u>
Overall dimensions _____	Distribution of particles (e.g., random, laminated, graded bedding)
How was it built?:	<u>random</u>

STRATIGRAPHIC DATA

This Locus is below Loc. 002 & is above Loc. 004

Lateral extent _____ Max. thickness _____ Touches balk(s) _____

How does this Locus relate to all other loci it touches?:

This Locus is contemporary with which loci mentioned above?:

How was this Locus formed?:

West Bath, Exterior SE

GENERAL IDENTIFICATION

Locus No. 004

Date (s)

Top levels 222.802 Top plan _____; Bottom levels 222.482 Top plan ✓

222.40

Sections _____ Drawn by architect X ✓ Photo No. _____

PHYSICAL DATA

What is it made of?: Stones, slate, sand, earth
Charcoal Dark reddish grey
What size particles? _____ Color SYR 4/2

Features	Soil Layers
Compass orientation <u>✓</u>	Direction & Degree of slope _____
_____ courses high; _____ rows wide	Degree of compaction: _____
Overall dimensions _____	Distribution of particles (e.g., random, laminated, graded bedding)
How was it built?:	<u>random</u>

STRATIGRAPHIC DATA

This Locus is below Loc. and platform 003 & is above loc broken walls

Lateral extent _____ Max. thickness _____ Touches balk(s) _____

How does this Locus relate to all other loci it touches?:

Later than 2 walls
Earlier than platform
Earlier than 003

This Locus is contemporary with which loci mentioned above?: _____

How was this Locus formed?: Perhaps a dump from the Service Area to the south. Possibly a large pit.

004

POTTERY

Basket No.	Date Dug	Level	Field Reading	Reg. Sherds
9	July 4		Pale fabric, joining frag tile - discarded 6 frags white Aleutian, incl. joining frags & one heavy wheel made base & 1 shell neck	
			9 cw3 (3 possibly fine ware ^{rim})	
			3 frags. burned cw4, wheel made & scratched dec. next.	
8	July 4		14 joining & non-joining frags of tile - joins with # 11 & discarded	
			1 frag Sines clay fabric base	
			5 frags white Aleutian closed vessel	
			1 other frag. ditto	
			5 local amphora frags of 1 + 1 probably local amphora like cw3	
			3 other frags cw3	
			1 frag cw4, 1 frag cw5	

MATERIAL CULTURE AND OBJECTS

MC	Reg. No.	Assoc. Pottery Basket No.	Identification
		9	thrown 1 bone; 4 iron lumps & smaller chips; 3 joining frags of colorless blown glass possibly bottle base; lead frag. 1 AE coin
C-54		11	3 frags. of colorless glass, 1 above frags with circle; 1 iron nail 3 charcoal samples
			150 bone frags; 21 larger bones; 3 teeth
		8	small bronze frag. L-0-027 W. 0.003.

E. Bathy Partico

YEAR 1983

GRID AREA _____

SITE Microbiota

LOCUS NO. 001-002

GENERAL IDENTIFICATION _____

DATE (s) _____

Top levels 223.122 Top plan _____; Bottom levels _____ Top plan _____

Sections _____ Drawn by architect _____ Photo No. _____

PHYSICAL DATA

What is it made of?:

What size particles? _____ Color _____

Features

Soil Layers

Compass orientation _____

Direction & Degree of slope _____

_____ courses high; _____ rows wide

Degree of compaction: _____

Overall dimensions _____

Distribution of particles (e.g., random, laminated, graded bedding)

How was it built?:

STRATIGRAPHIC DATA

This Locus is below Loc. _____ & is above Loc. _____

Lateral extent _____ Max. thickness _____ touches balk(s) _____

How does this Locus relate to all other loci it touches?:

This Locus is contemporary with which loci mentioned above?:

How was this Locus formed?:

Portico
East Baths, Courtyard

Locus 001

POTTERY

and 002

Basket No.	Date Dug	Level	Field Reading	Reg. Sherds
1	June 30	001	1 amphora neck frag -	1st-2nd? R #352
4		002	MA pottery	
B		0021	frag	
2		001	2 pieces of cement - discarded 1 frag. unident CWF - discarded Frag of 2 Roman amphoras (discarded)	
		R	1 thickened rim small white Aleutejo bowl	#355
3		002	1 floor of ARS plate 3rd - 6th c 1 frag CWF? discarded	#358

MATERIAL CULTURE AND OBJECTS

MC	Reg. No.	Assoc. Pottery Basket No.	Identification
		1	6 frags of painted plaster, white?
		4	9 frags of painted plaster, white?
	001	2	1 bone frag



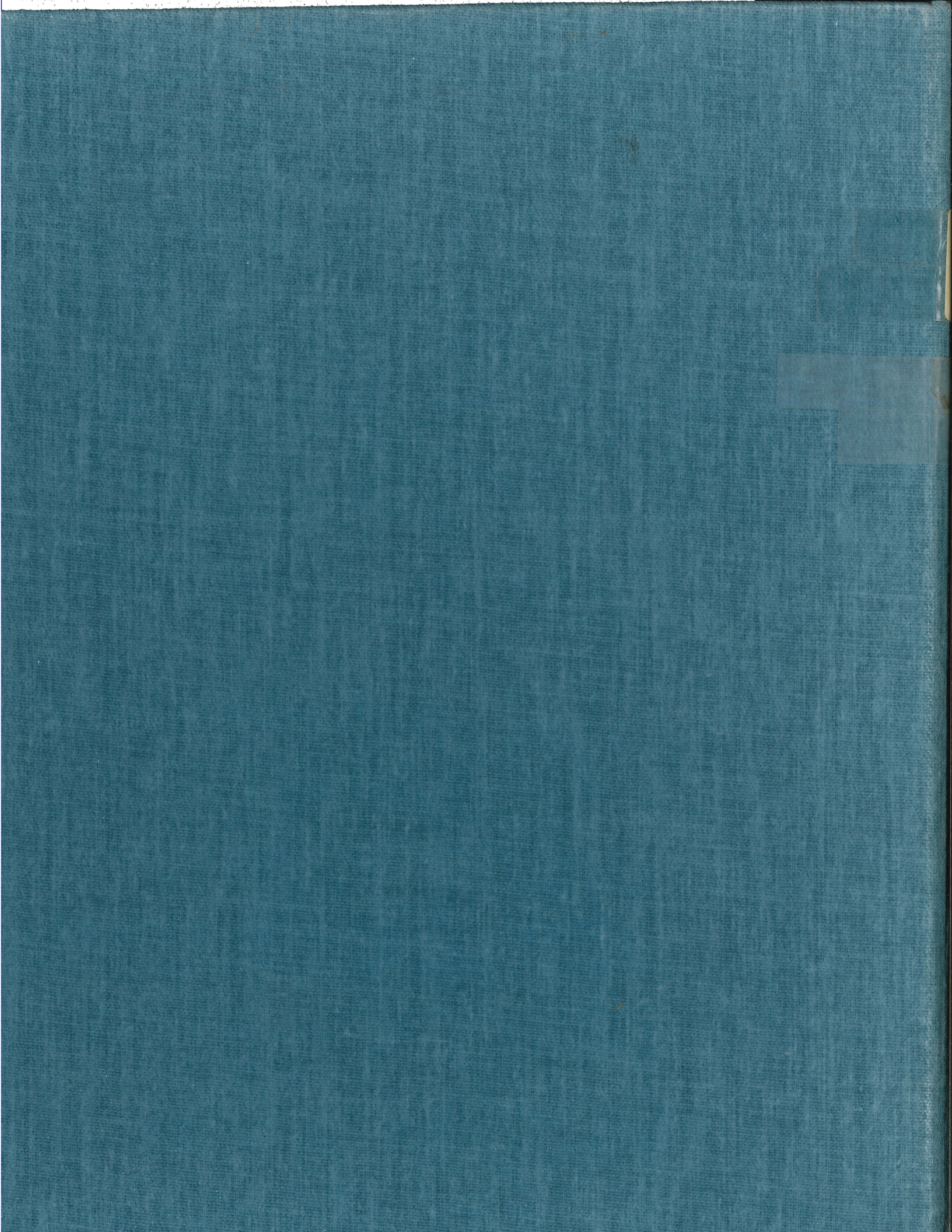

University Libraries
University of Missouri

Digitization Information Page

Local identifier MirobrigaBinder3

Source information

Format Manuscript
Content type Text (handwritten), forms; archaeological maps
Source ID Faculty member copy; not added to collection
Notes Pages in a binder

Capture information

Date captured March 2019
Scanner manufacturer Ricoh (rescans on Zeutschel and OpticBook)
Scanner model MP C4503
Scanning system software
Optical resolution 600 dpi
Color settings 24 bit color
File types tiff
Note Rescanned 2019-05-01 on Zeutschel; 600 dpi; 24 bit color; unsharpened mask

Derivatives - Access copy

Compression Tiff: LZW compression
Editing software Adobe Photoshop CC
Resolution 600 dpi
Color color covers, gray scale texts
File types pdf created from tiffs
Notes Images straightened, canvas size 8.5 in x 11 in
Some text darkened to improve legibility; binder holes removed