

4 new dormitories for men

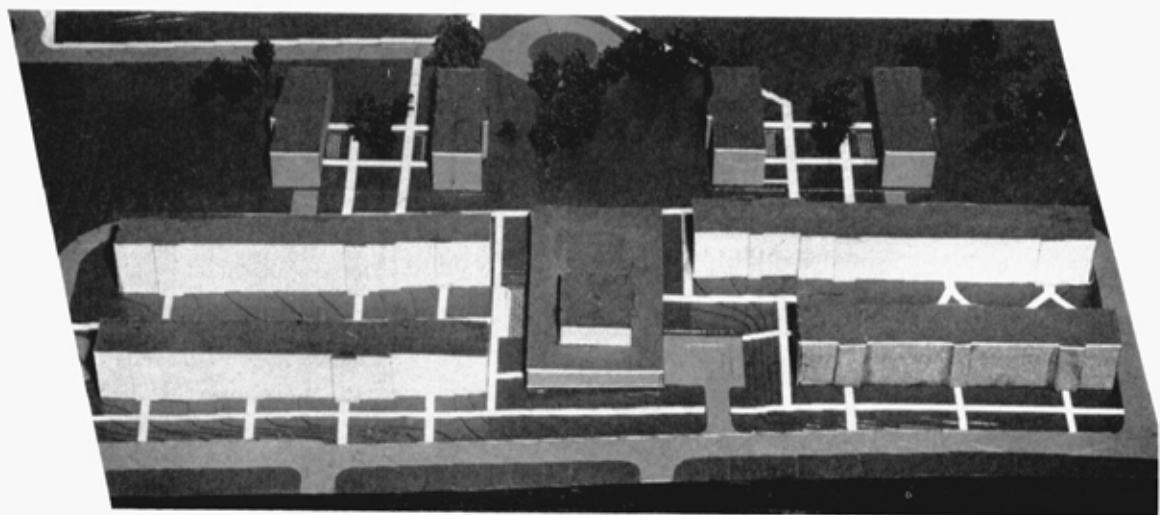

The South Dormitory Group will be expanded from the present four units to include four more residence halls and a central cafeteria and service center.

The small cardboard scale model above indicates the general layout. In the foreground are the existing residence halls (Defoe, Graham, Cramer, and Stafford) which run north and south and face Hillcrest Avenue. The proposed cafeteria is in the center. Back of these buildings, to the west, are the four proposed halls which will extend east and west, perpendicular to the present dormitories. They will not be connected to the present buildings, nor to the new cafeteria building. Neither will the cafeteria be a connected and integral part of the four present dormitories, as originally planned. The food service center will be a two-story structure, completely air-conditioned. It will also contain lounges and recreation facilities.

Each of the four new residence halls will house about 110 men students. Each will be four stories high and approximately 115 by 39 feet in size. Construction will be financed largely through the sale of revenue bonds. The five units will cost a total of approximately \$2,056,242 if the low base bids submitted by the contractors on December 11 are accepted. That total is below the architects' estimate.

The general area is just south of Rothwell Gymnasium and Brewer Field House.